

Poliform

ALEA

KITCHENS

Poliform

ALEA KITCHEN
DIGITAL CATALOGUE

Spessore ridotto, apertura a gola e massima versatilità nella scelta delle finiture: sono le caratteristiche che rendono l'anta Alea unica per possibilità compositive e personalizzazione. Un design lineare fatto di superfici piane e volumi geometrici, capace di ridefinire l'ambiente cucina unendo all'altissima capacità operativa un'estetica minimale.

Reduced thickness, groove opening, and maximum versatility in the choice of finishes: these are the characteristics that make the Alea door unique for compositional possibilities and customisation. A linear design made of flat surfaces and geometric volumes, capable of redefining the kitchen environment by combining a very high operational capability with a minimalistic style.

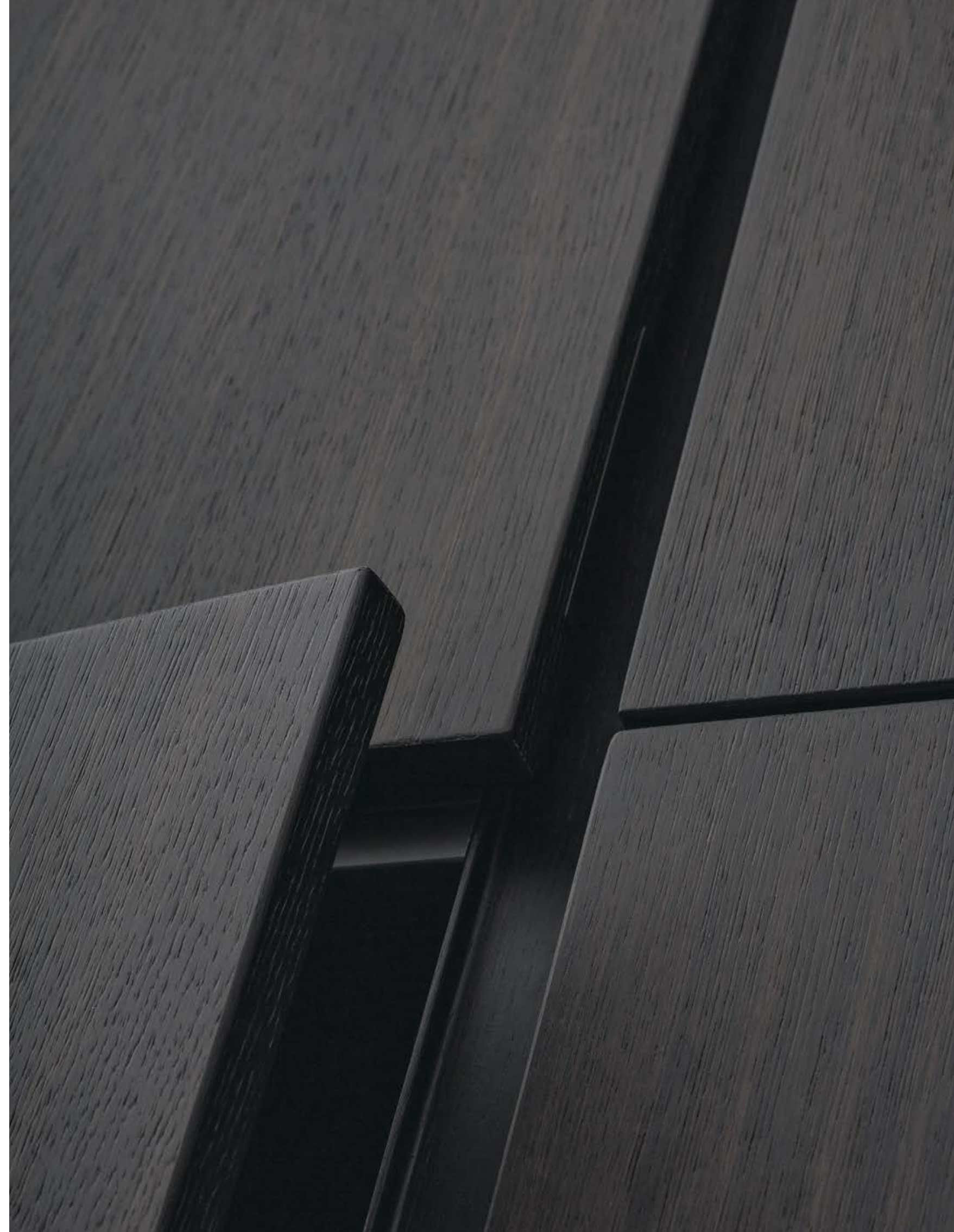





Qui e nelle pagine precedenti: isola con piano snack, basi con ante in laccato gofrato ghiaccio e top in DuPont Corian® pearl gray. Basi con ante ed estrattori in rovere spessart, top e schienali in pietra stone brown levigata. Cappa Flat verniciata nera a isola personalizzata Poliform. Colonne con ante e vani a giorno in rovere spessart. Sgabelli lcs in rovere spessart.

Previous and this page: island with snack top, base units with doors in embossed lacquered ghiaccio, top in DuPont Corian® pearl gray. Base units with doors and pull-out storage baskets in spessart oak, top and back panels in stone brown mat finishing. Poliform personalized Flat island-hood painted black. Tall units with doors and open compartments in spessart oak. lcs stools in spessart oak.

A destra: basi dell'isola con ante in laccato goffrato ghiaccio, top in DuPont Corian® pearl gray. Colonne con ante in rovere spessart. Sotto: vano attrezzato con ante a scomparsa e illuminazione a led integrata.

To the right: island base units with doors in embossed lacquered ghiaccio, top in DuPont Corian® pearl gray. Tall units with doors in spessart oak. Below: equipped element with pocket doors and integrated led lighting.





Due dettagli delle colonne in rovere spessart e profilo in alluminio laccato carbone. Cesti estraibili in midollino. Sgabello lcs in rovere spessart.

Two close-ups of the tall units with a spessart oak finishing and carbone lacquered aluminium profile. Pull-out wicker baskets. lcs stool in spessart oak.







Nelle pagine precedenti: isola con piano snack, basi con ante in laccato goffrato ghiaccio e top in DuPont Corian® pearl gray. Basi con ante ed estrattori in rovere spessart, top e schienali in pietra stone brown levigata. Cappa Flat verniciata nera a isola personalizzata Poliform. Pensili con ante vetrina PR22 in vetro riflettente fumé e telaio in alluminio anodizzato nero. A sinistra: estrattore con anta laccato goffrato ghiaccio. Cassetti interni verniciati brown con sistema di illuminazione interna a led e attrezzatura in wengé. Sotto: dettaglio del profilo di apertura con sagoma in alluminio laccato carbone.

Previous pages: island with snack top, base units with doors in embossed lacquered ghiaccio and top in DuPont Corian® pearl gray. Base units with doors and pull-out storage baskets in spessart oak, top and back panels in stone brown mat finishing. Poliform personalized Flat island-hood painted black. Wall units with doors PR22 in fumé reflecting glass and frame in black anodized aluminium. To the left: pull-out storage basket with door in embossed lacquered ghiaccio. Inner drawers painted brown with inner led lighting system and equipment in wenge. Below: close-up of the opening profile in carbone mat lacquered aluminium.





Nelle pagine precedenti: isola con piano snack, basi con ante in laccato goffrato ghiaccio e top in DuPont Corian® pearl gray. Basi con ante ed estrattori in rovere spessart, top e schienali in pietra stone brown levigata. Pensili con ante vetrina PR22 in vetro riflettente fumé e telaio in alluminio anodizzato nero. A destra: top e schienali in pietra stone brown levigata. Piani cottura Miele Smart Line a induzione con piastra Teppan Yaki in acciaio e vetroceramica. Lavello Foster in finitura KE Gun Metal. Cappa Flat verniciata nera a isola personalizzata Poliform.

Previous pages: island with snack top, base units with doors in embossed lacquered ghiaccio and top in DuPont Corian® pearl gray. Base units with doors and pull-out storage baskets in spessart oak, top and back panels in stone brown mat finishing. Wall units with doors PR22 in fumé reflecting glass and frame in black anodized aluminium. To the right: top and back panels in stone brown mat finishing. Induction hobs Miele Smart Line with Teppan Yaki griddle in steel and glass ceramics. Sink Foster in KE Gun Metal finish. Poliform personalized Flat island-hood painted black.





A sinistra: basi con ante ed estrattori in rovere spessart, top e schienali in pietra stone brown levigata. Pensili con ante vetrina PR22 in vetro riflettente fumé e telaio in alluminio anodizzato nero. Sotto: particolare dell'anta dei pensili.

To the left: base units with doors and pull-out storage baskets in spessart oak, top and back panels in stone brown mat finishing. Wall units with doors PR22 in fumé reflecting glass and frame in black anodized aluminium. Below: close-up of wall unit door.



A destra: dettaglio degli estrattori in verniciato brown con sistema di illuminazione interna a led e attrezzatura in wengé. Sotto: particolare del profilo d'apertura con sagoma in alluminio laccato carbone.

To the right: close-up of pull-out storage baskets painted brown with inner led lighting system and equipment in wengé. Below: close-up of carbone lacquered aluminium handle profile.



ALEA

Design R&D Poliform

Basi p 740

Strutture: nobilitato grigio lavagna.
Ante ed estrattori: rovere spessart.
Maniglie: sagoma alluminio laccato carbone.
Top, schienali e fianchi: pietra stone brown levigata, spessore 20 mm.
Zoccoli: alluminio laccato carbone.

Isola p 1040

Strutture: nobilitato grigio lavagna.
Top: DuPont Corian® pearl gray, spessore 20 mm.
Ante ed estrattori: laccato goffrato ghiaccio.
Maniglie: sagoma alluminio laccato carbone.
Fianchi: laccato goffrato ghiaccio, spessore 6 mm.
Zoccoli: alluminio laccato carbone.

Colonne p 740

Strutture: nobilitato grigio lavagna.
Ante: rovere spessart.
Fianchi: rovere spessart, spessore 20 mm.
Distanziatori verticali: rovere spessart.
Zoccoli: alluminio laccato carbone.

Pensili vetrina PR22 p 410

Strutture: nobilitato grigio lavagna.
Ante: vetro riflettente fumé con telaio alluminio anodizzato nero.
Aperture: pieghevole con profilo luminoso, a ribalta con apertura tip-on.
Fianchi: laccato goffrato carbone, spessore 6 mm.

Complementi

Sgabello Ics: rovere spessart.

Base units d 29 1/4"

Structures: grey lavagna melamine.
Doors and pull-out storage baskets: spessart oak.
Handles: carbone lacquered aluminium profile.
Top, back panels and side panels: stone brown mat finishing, thickness 3/4".
Plinths: carbone lacquered aluminium.

Island d 41"

Structures: grey lavagna melamine.
Top: DuPont Corian® pearl gray, thickness 3/4".
Doors and pull-out storage baskets: embossed lacquered ghiaccio.
Handles: carbone lacquered aluminium profile.
Side panels: embossed lacquered ghiaccio, thickness 1/4".
Plinths: carbone lacquered aluminium.

Tall units d 29 1/4"

Structures: grey lavagna melamine.
Doors: spessart oak.
Side panels: spessart oak, thickness 3/4".
Vertical spacers: spessart oak.
Plinths: carbone lacquered aluminium.

Glass wall units PR22 d 16 1/4"

Structures: grey lavagna melamine.
Doors: fumé reflecting glass with frame in black anodized aluminium.
Openings: folding with lighted profile, flap with tip-on opening.
Side panels: embossed lacquered carbone, thickness 1/4".

Accessories

Ics stool: spessart oak.

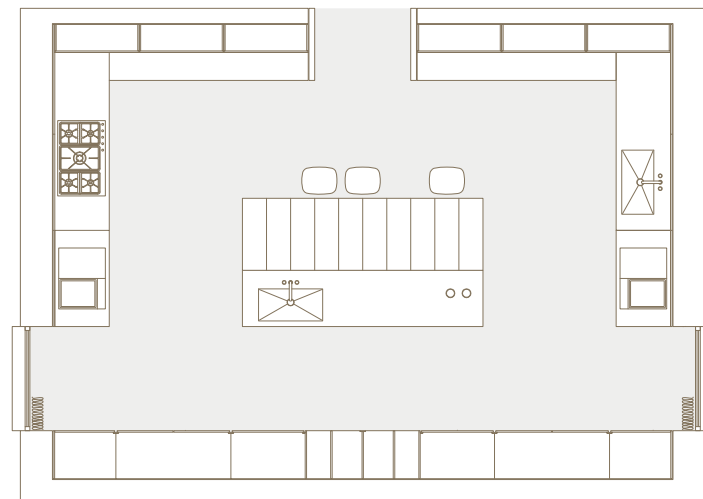
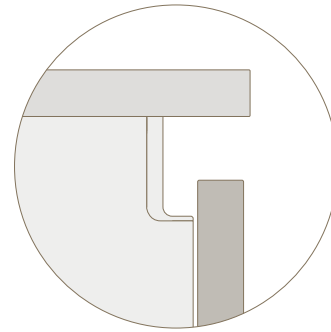

Basi Base units

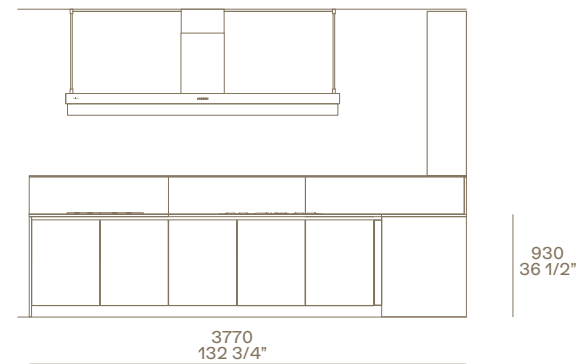

Isola Island

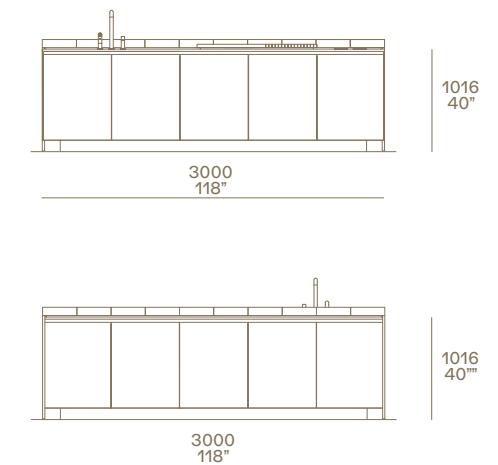

Colonne Tall units

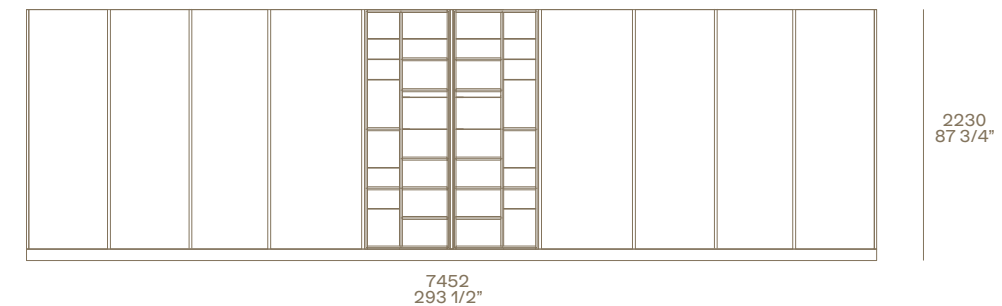

Pensili vetrina Glass wall units

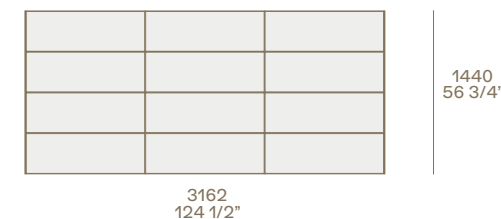

Ics Design Rodrigo Torres

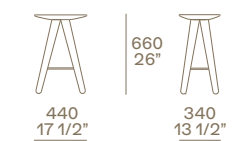

- 1 Piani cottura Miele Smart Line a induzione con piastra Teppan Yaki in acciaio e vetroceramica, incasso filotop.
- 2 Piano cottura 5 fuochi personalizzato Poliform by Barazza.
- 3 Attrezzatura in wengé e acciaio per cassetti interni.

- 4 Cappa Flat verniciato nero a isola personalizzata Poliform.
- 5 Pensili vetrina PR 22, apertura pieghevole con profilo luminoso, a ribalta con apertura tip-on.

- 6 Lavello finitura KE Gun Metal, incasso sottotop.
- 7 Attrezzatura in wengé e acciaio per estrattori.

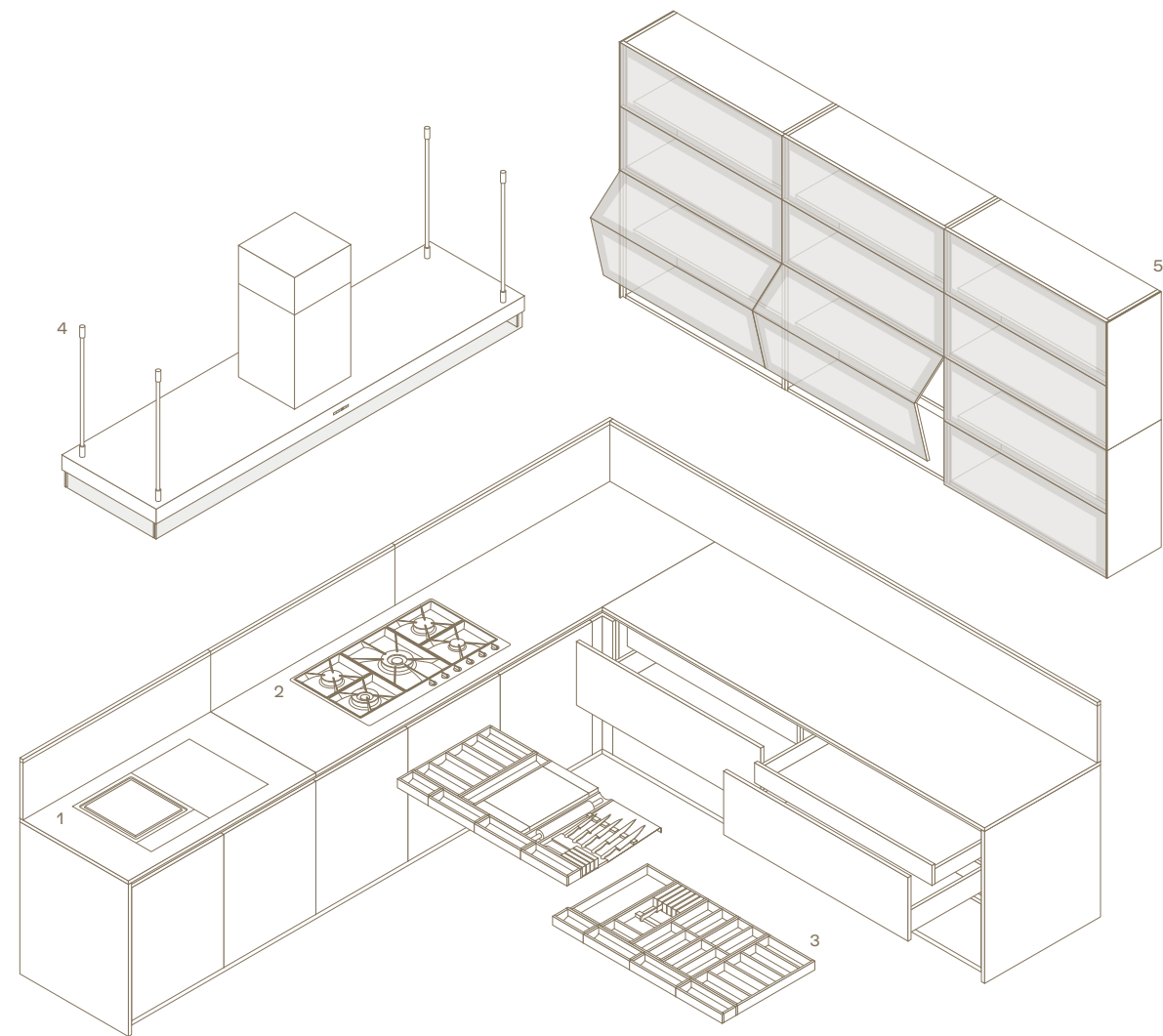

- 1 Induction hobs Miele Smart Line with Teppan Yaki griddle in steel and glass ceramics, flush built-in.
- 2 Personalized hob with 5 burners Poliform by Barazza.
- 3 Equipment for inner drawers in wenge and steel.

- 4 Poliform personalized Flat island-hood painted black.
- 5 Wall units with glass doors PR22, flap opening with lighted profile and tip-on opening.

- 6 Sink with KE Gun Metal finishing, under-top-mounted built-in.
- 7 Equipment for pull-out storage baskets in wenge and steel.

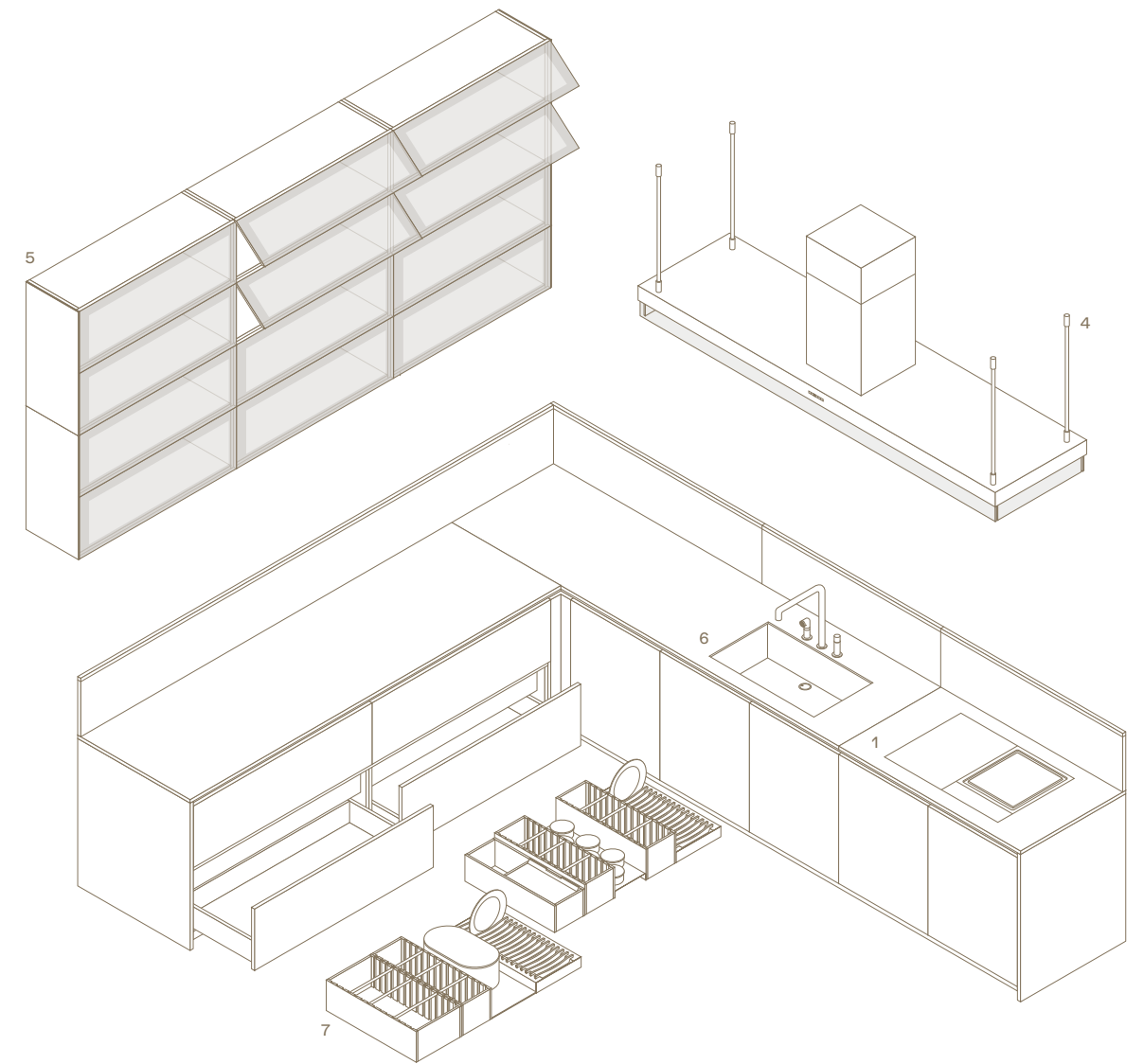

- 1 Lavello Foster finitura KE Gun Metal, incasso sottotop.
- 2 Piano snack profondità 900 mm.
- 3 Estrattore sottolavello con portarifiuti.

- 4 Attrezzatura in wengé e acciaio per cassetti interni.
- 5 Attrezzatura in wengé e acciaio per estrattori.

- 6 Colonna con ante a scomparsa, attrezzata con ripiani.
- 7 Colonna a giorno con cesti in midollino.
- 8 Colonna con ante a scomparsa, vani a giorno e forni.

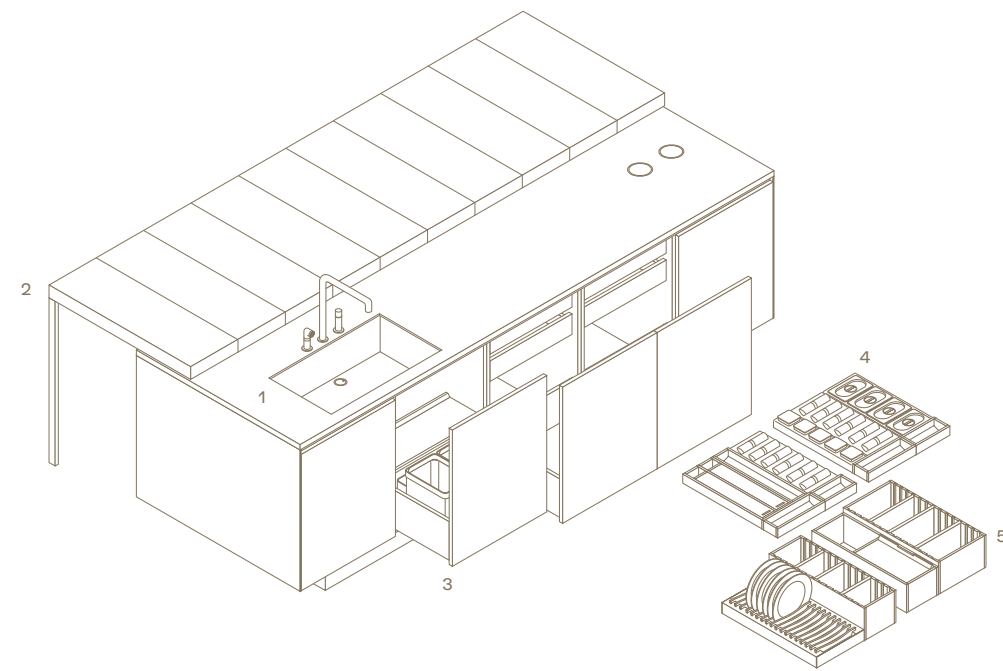

- 1 Sink Foster with KE Gun Metal finishing, under-top-mounted built-in.
- 2 Snack table depth 35 1/2".
- 3 Pull-out storage basket with under-sink waste bin.

- 4 Equipment for inner drawers in wenge and steel.
- 5 Equipment for pull-out storage baskets in wenge and steel.

- 6 Tall unit with pocket doors, with shelves.
- 7 Open tall unit with wicker baskets.
- 8 Tall unit with pocket doors, open elements and oven.

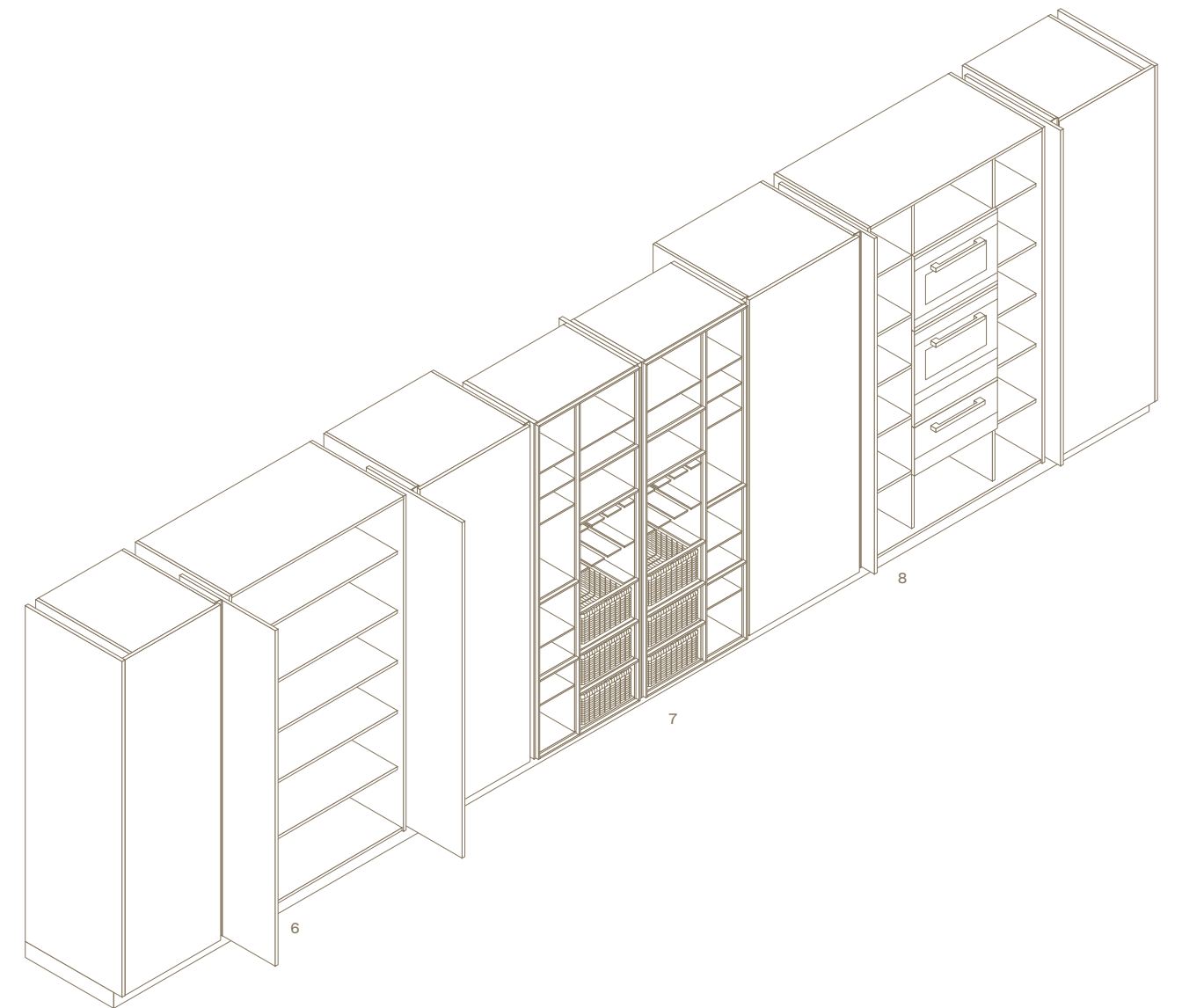

A destra: basi con ante, cassetti ed estrattori in nobilitato larice sabbia, top in laminato tuttocolore touch nero. Shaker con ripiani in alluminio anodizzato moka e tubi in laccato goffrato carbone. Mensola sopra Shaker in laccato goffrato carbone. Schienali in laminato tuttocolore touch nero.

To the right: base units with doors, drawers and pull-out storage baskets in larch sabbia melamine, top in laminate tuttocolore touch nero. Shaker with shelves in moka anodized aluminium and bars in embossed lacquered carbone. Shelf above Shaker in carbone embossed lacquered finishing. Backs in laminate tuttocolore touch nero.







Nelle pagine precedenti: basi con ante, cassetti ed estrattori in nobilitato larice sabbia, top in laminato tuttocolore touch nero. Pensili con ante nobilitato silk bronzo. Shaker con schienali in laccato goffrato carbone, ripiani in alluminio anodizzato moka e tubi in laccato goffrato carbone. Mensola sopra Shaker in laccato goffrato carbone. Schienali in laminato tuttocolore touch nero. A sinistra: dettaglio del pensile in nobilitato silk bronzo con ripiani interni in nobilitato grigio lavagna.

Previous pages: base units with doors, drawers and pull-out storage baskets in larch sabbia melamine, top in laminate tuttocolore touch nero. Wall units with doors in bronzo silk melamine. Shaker with back panels in embossed lacquered carbone, shelves in moka anodized aluminium and bars in embossed lacquered carbone. Shelf above Shaker in carbone embossed lacquered finishing. Backs in laminate tuttocolore touch nero. To the left: close-up of the wall unit in bronzo silk melamine with inner shelves in grey lavagna melamine.



Nelle pagine precedenti: basi con ante, cassetti ed estrattori in nobilitato larice sabbia, top in laminato tuttocolore touch nero. Pensili con ante nobilitato silk bronzo. Shaker con schienali in laccato goffrato carbone, ripiani in alluminio anodizzato moka e tubi in laccato goffrato carbone. Mensola sopra Shaker in laccato goffrato carbone. Schienali in laminato tuttocolore touch nero. A destra e sotto: dettagli dell'interno di cassetti ed estrattori con sistema di illuminazione a led. Attrezzatura in noce canaletto e alluminio anodizzato moka con piattai, portaposate, portacoltelli e portaspezie in ceramica.

Previous pages: base units with doors, drawers and pull-out storage baskets in larch sabbia melamine, top in laminate tuttocolore touch nero. Wall units with doors in bronzo silk melamine. Shaker with back panels in embossed lacquered carbone, shelves in moka anodized aluminium and bars in embossed lacquered carbone. Shelf above Shaker in carbone embossed lacquered finishing. Backs in laminate tuttocolore touch nero. To the right and below: close-up of inner drawers and pull-out storage basket with led lighting system. Inner equipment in walnut canaletto and moka anodized aluminium with plate holder, cutlery canteen, knife rack and spice holders in ceramic.





A sinistra: basi con ante, cassetti ed estrattori in nobilitato larice sabbia, top e schienali in laminato tuttocolore touch nero. Top con lavelli integrati in laminato tuttocolore touch nero, piano cottura a cinque fuochi in acciaio scotch brite personalizzato Poliform by Barazza. Pensili con ante in nobilitato silk bronzo. Shaker con ripiani in alluminio anodizzato moka e tubi laccato goffrato carbone, contenitori in DuPont Corian® glacier white. Mensola sopra Shaker in laccato goffrato carbone. Sotto: top con lavello integrato in laminato tuttocolore touch nero e fondo in acciaio scotch brite. Estrattori in nobilitato larice sabbia con sistema di illuminazione interna a led.

To the left: base units with doors, drawers and pull-out storage baskets in larch sabbia melamine. Worktop and backs in laminate tuttocolore touch nero. Top with integrated sinks in laminate tuttocolore touch nero, personalized hob Poliform by Barazza with five burners in scotch brite steel. Wall units with doors in bronzo silk melamine. Shaker with shelves in moka anodized aluminium and bars, holders in DuPont Corian® glacier white. Shelf above Shaker in carbone embossed lacquered. Below: worktop with integrated sink in laminate tuttocolore touch nero and bottom in scotch brite steel. Pull-out storage baskets in larch sabbia melamine with inner led lighting system.

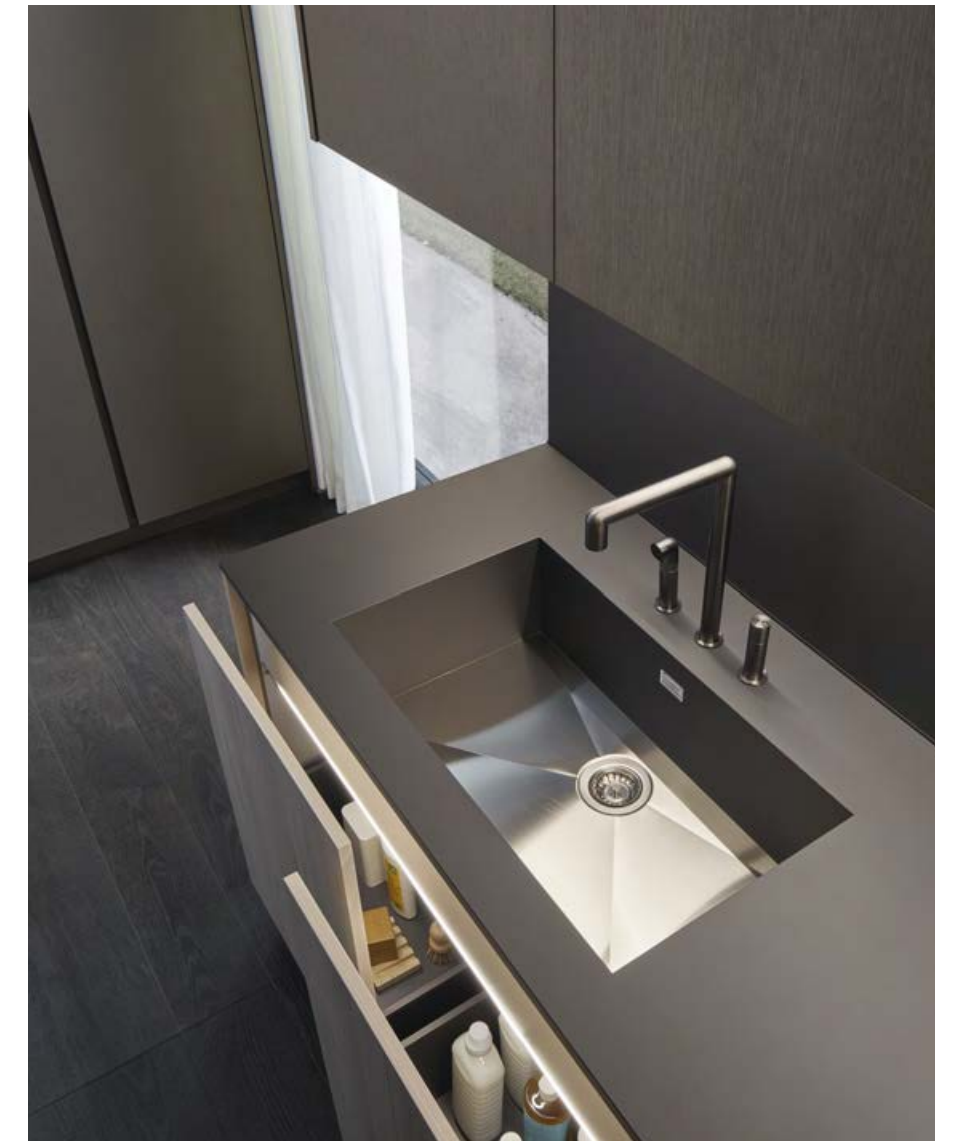

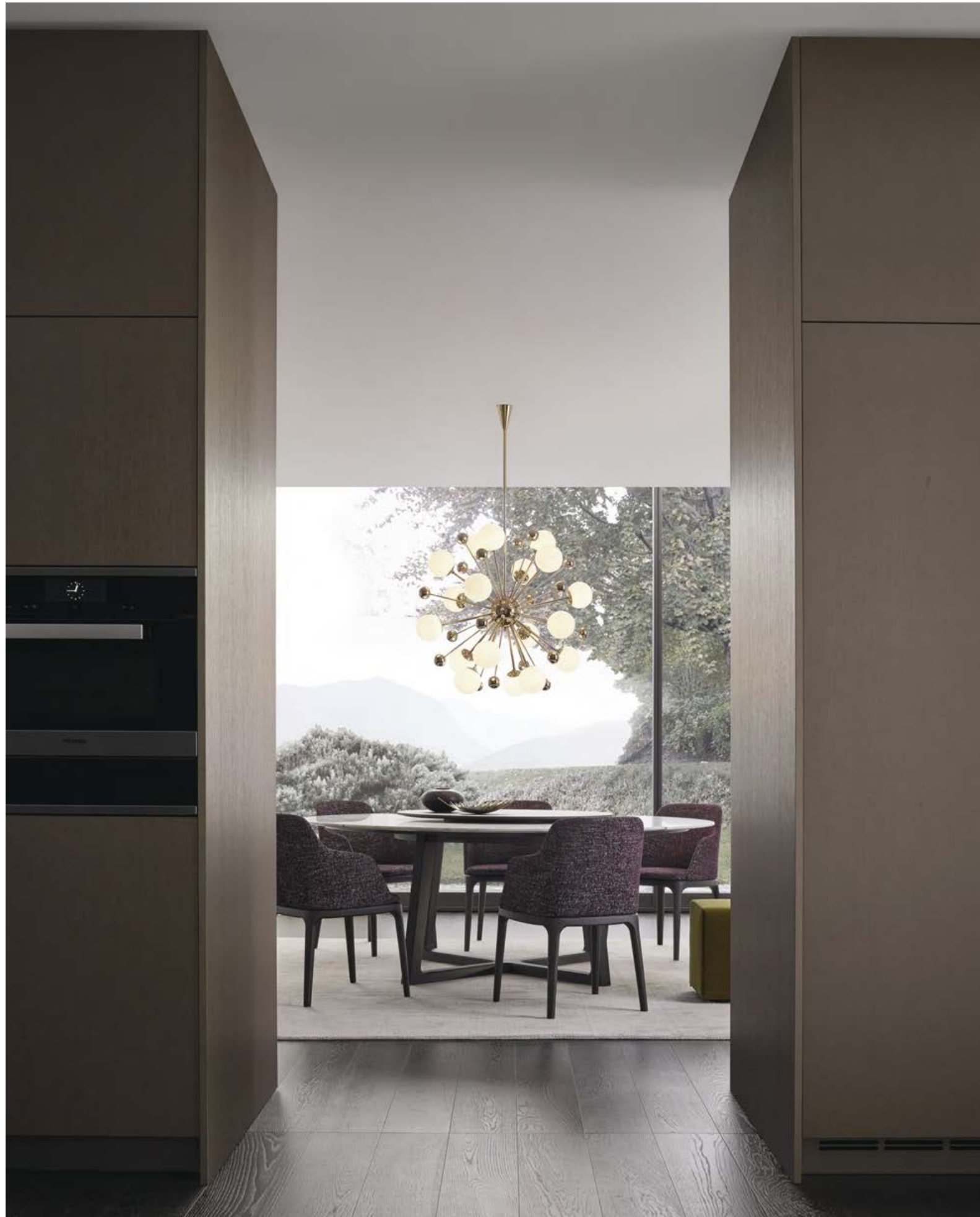

A sinistra: colonne ed estrattori in nobilitato silk bronzo. Tavolo Concorde in rovere spessart con piano in marmo calacatta oro e piano girevole opzionale in rovere spessart. Sedie Grace in rovere spessart rivestite in tessuto Olimpia 112 prugna. Pouf Play in velluto Persia 1401 oliva.

To the left: tall units and pull-out storage baskets in bronzo silk melamine. Concorde table in spessart oak, top in calacatta oro marble and optional swivel top in spessart oak. Grace chairs in spessart oak with fabric covering Olimpia 112 prugna. Play pouf in velvet Persia 1401 oliva.





Nelle pagine precedenti: colonne con ante vetrina PR19 in vetro riflettente bronzato con telaio in alluminio verniciato bronzo, ripiani interni in vetro riflettente bronzato, illuminazione a led. Tavolo Concorde in rovere spessart con piano in marmo calacatta oro e piano girevole opzionale in rovere spessart. Sedie Grace in rovere spessart e rivestimento in tessuto Olimpia 112 prugna. Pouf Play in velluto Persia 1401 oliva. A sinistra: dettaglio delle ante vetrina PR19 in vetro riflettente bronzato con telaio in alluminio verniciato bronzo, apertura tip-on.

Previous pages: tall units with bronzed reflecting glass doors PR19, frame in bronzo painted aluminium, inner shelves in bronzed reflecting glass, led lighting. Concorde table in spessart oak, top in calacatta oro marble and optional swivel top in spessart oak. Grace chairs in spessart oak with fabric covering Olimpia 112 prugna. Play pouf in velvet Persia 1401 oliva. To the left: close-up of the glass doors PR19 in bronzed reflecting glass with frame in bronzo painted aluminium.

ALEA

Design R&D Poliform

Basi p 740

Strutture: nobilitato grigio lavagna.
Ante, cassetti ed estrattori:
nobilitato larice sabbia.
Top: laminato tuttocolore touch
nero, 20 e 52 mm.
Fianchi: nobilitato larice sabbia.
Schienali: laminato tuttocolore touch nero.
Zoccoli: laccato goffrato silk bronzo.

Colonne p 640

Strutture: nobilitato grigio lavagna.
Ante: nobilitato silk bronzo.
Distanziatori verticali e zoccoli:
laccato goffrato silk bronzo.

Pensili p 410

Strutture: nobilitato grigio lavagna.
Ante: nobilitato silk bronzo.
Aperture: battente con profilo luminoso.
Fianchi: nobilitato silk bronzo.
Ripiani: nobilitato grigio lavagna,
spessore 18 mm.

Pensili vetrina PR19 p 410

Strutture: nobilitato grigio lavagna.
Ante: vetro riflettente bronzato con telaio
alluminio verniciato bronzo
Aperture: tip-on.
Ripiani interni: vetro riflettente bronzato.

Shaker p 120

Strutture: alluminio anodizzato moka.
Ripiani e tubi: laccato goffrato
carbone.
Mensola: laccato goffrato carbone,
spessore 52 mm.

Complementi

Tavolo Concorde: struttura e piano
girevole in rovere spessart, piano in marmo
calacatta oro opaco.
Sedia Grace: seduta in tessuto Olimpia
112 prugna, gambe in rovere spessart.
Pouf Play: velluto Persia 1401 oliva.

Base units d 29 1/4"

Structures: grey lavagna melamine.
Doors, drawers and pull-out baskets:
larch sabbia melamine.
Top: laminate tuttocolore touch nero,
thickness 3/4" and 2".
Sides: larch sabbia melamine.
Backs: laminate tuttocolore touch nero.
Plinths: bronzo silk embossed lacquered.

Tall units d 25 1/4"

Structures: grey lavagna melamine.
Doors: bronzo silk melamine.
Vertical spacers and plinths: bronzo silk
embossed lacquered.

Wall units d 16 1/4"

Structures: grey lavagna melamine.
Doors: bronzo silk melamine.
Openings: leaf with lighted profile.
Sides: bronzo silk melamine.
Shelves: grey lavagna melamine,
thickness 3/4".

Glass wall units d 16 1/4"

Structures: grey lavagna melamine.
Doors: bronzed reflecting glass with
bronzed painted aluminium frame.
Openings: tip-on.
Inner shelves: bronzed reflecting glass.

Shaker d 4 3/4"

Structures: moka anodized aluminium.
Shelves and bars: carbone embossed
lacquered.
Shelf: carbone embossed lacquered,
thickness 2".

Accessories

Concorde table: structure and swivel
top in spessart oak, top in calacatta oro
mat marble.
Grace chair: seat in fabric Olimpia 112
prugna, legs in spessart oak.
Play pouf: velvet Persia 1401 oliva.

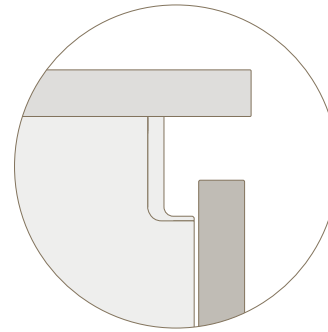

Basi e Shaker Base units and Shaker

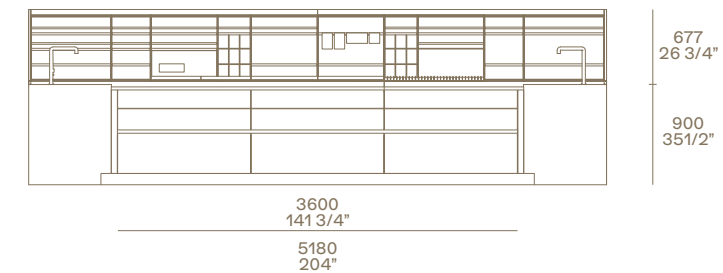

Basi e pensili Base units and wall units

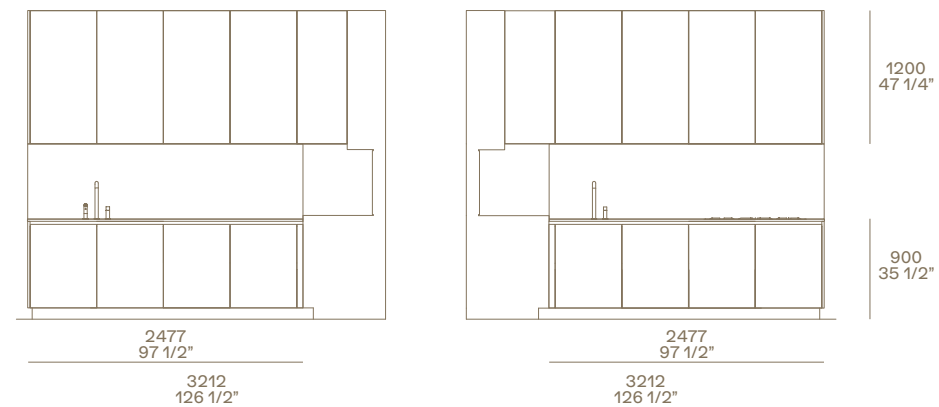

Pensili vetrina Glass wall units

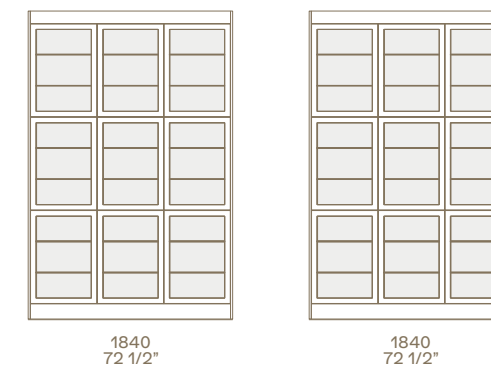

Colonne Tall units

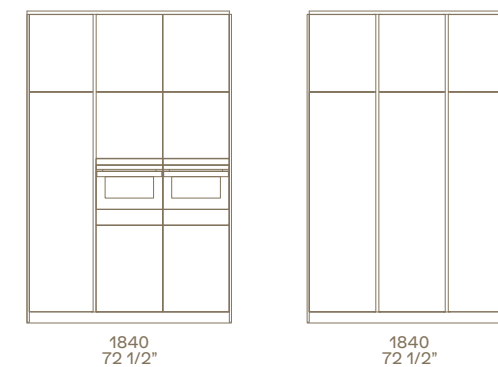

Grace Design Emmanuel Gallina

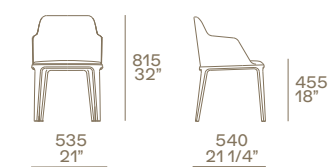

Concorde Design Emmanuel Gallina

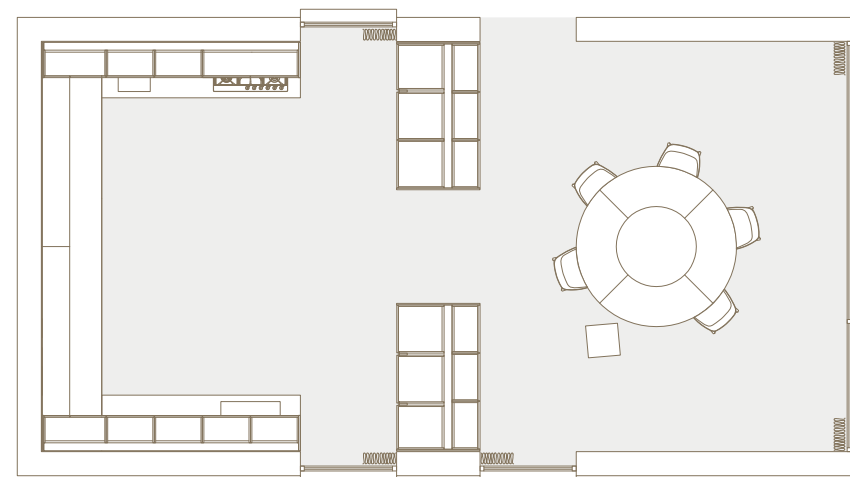
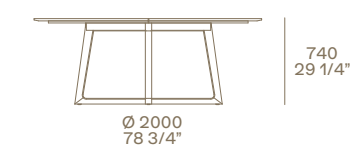

- 1 Lavello integrato in laminato tuttocolore touch nero con fondo acciaio scotch brite.
- 2 Piano cottura 5 fuochi personalizzato Poliform by Barazza, incasso filotop.
- 3 Attrezzatura in noce canaletto e alluminio anodizzato moka per cassetti ed estrattori.

- 4 Shaker con ripiani, vani a giorno, portabicchieri e contenitori.
- 5 Mensola profondità 405 mm.
- 6 Pensili con ante ad apertura battente.
- 7 Cappa a scomparsa in acciaio scotch brite personalizzata Poliform.

- 8 Colonne con forni, e frigo/congelatore con ante ad apertura battente ed estrattori.
- 9 Pensili vetrina PR19 con ante apertura tip-on e ripiani interni.

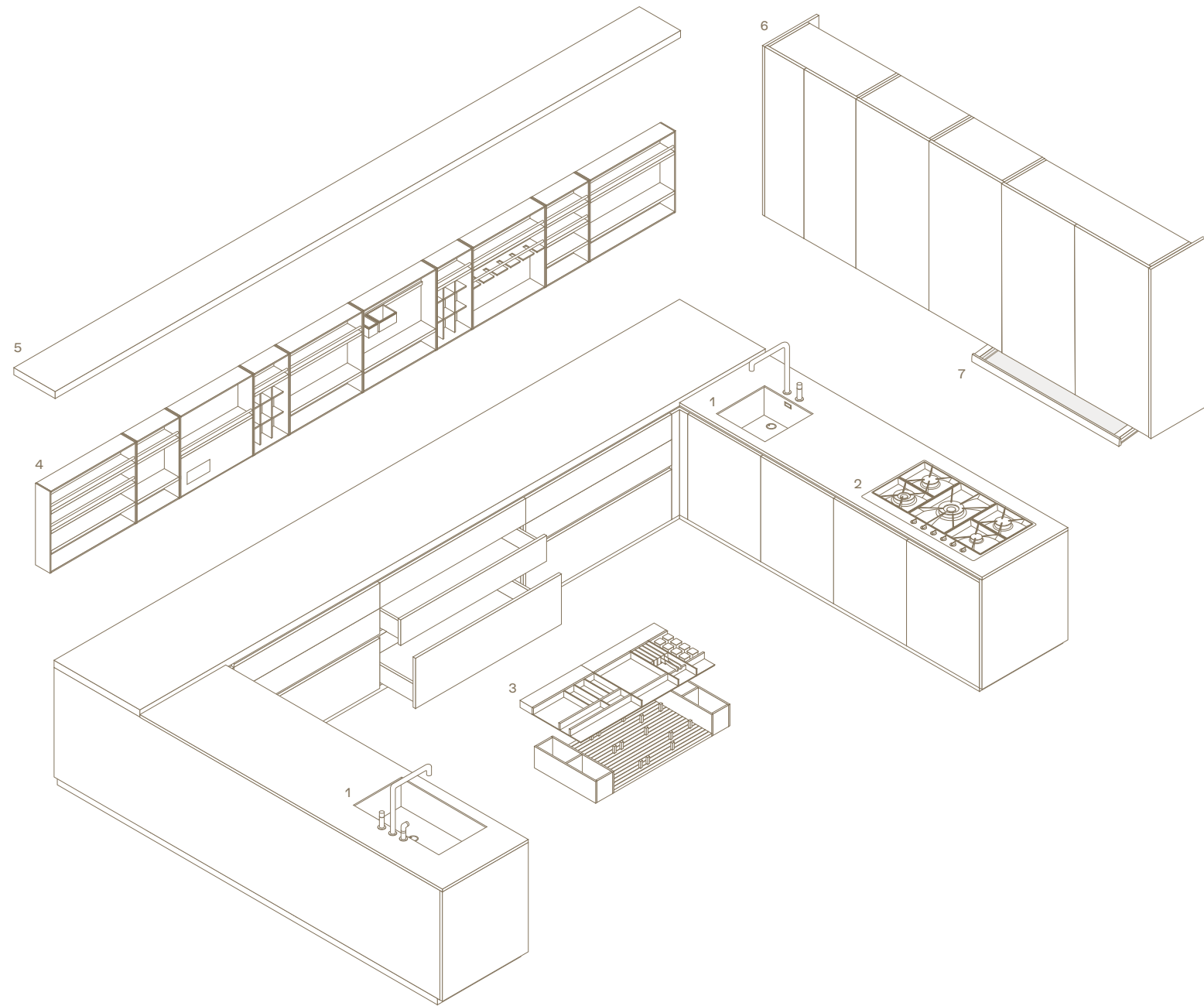

- 1 Integrated sink in laminate tuttocolore touch nero with bottom in scotch brite steel.
- 2 Personalized hob with 5 burners Poliform by Barazza, flush built-in.
- 3 Equipment in walnut canaletto and moka anodized aluminium for drawers and pull-out baskets.

- 4 Shaker with shelves, open units, glass holders and holders.
- 5 Shelf depth 16".
- 6 Wall units with leaf doors.
- 7 Personalized hidden hood Poliform in scotch brite steel.

- 8 Tall units with ovens, fridge and freezer with leaf doors and pull-out baskets.
- 9 Wall units with glass doors PR19 with tip-on opening and inner shelves.

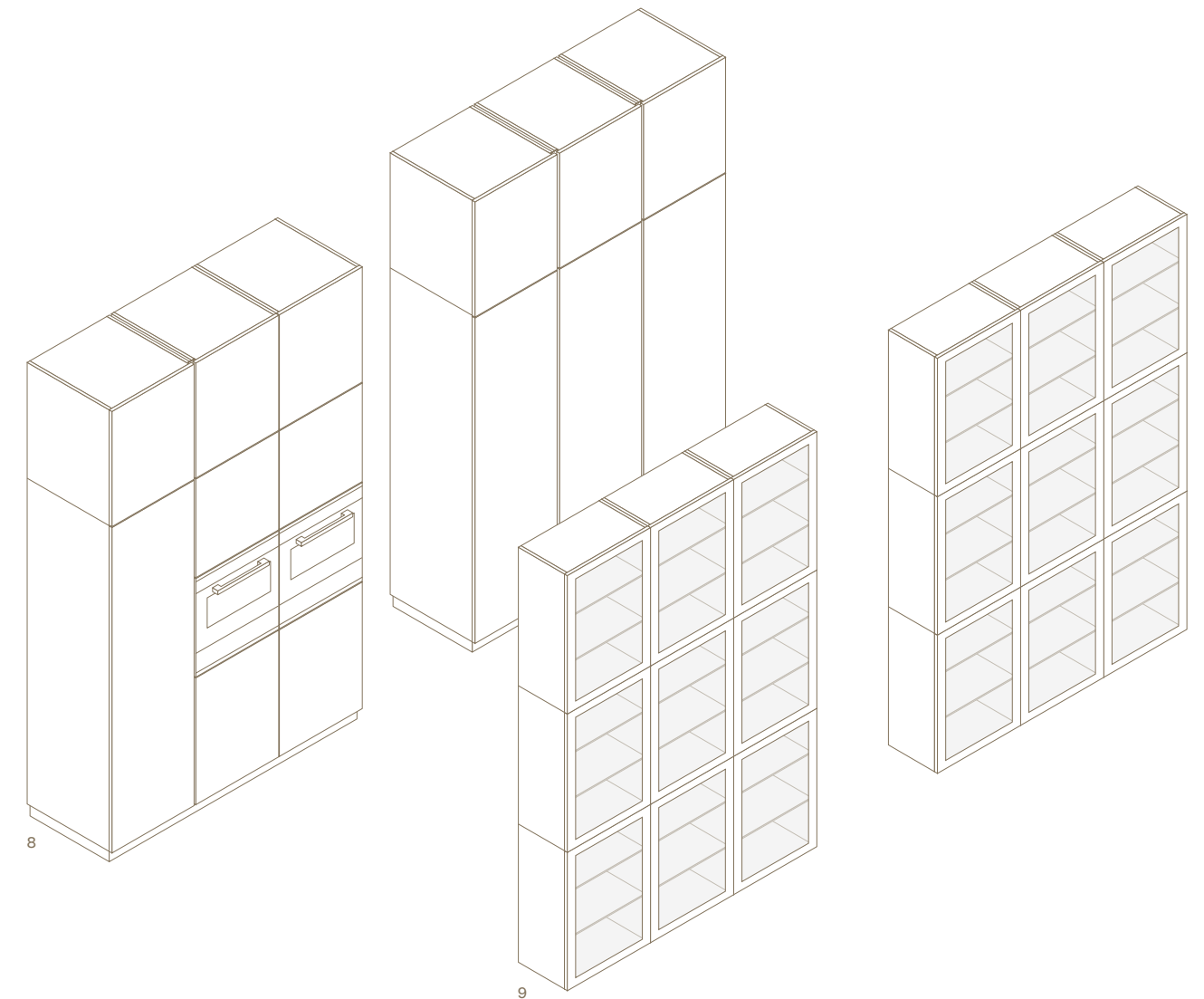

A destra: basi e isola con ante, cassetti ed estrattori in laminato touch bianco e top in laminato tuttocolore touch bianco con inserto colore nero. Cappa Flat a isola in acciaio scotch brite personalizzata Poliform. Mensola in laccato goffrato castoro con schienale in laminato tuttocolore touch castoro. Schienali in pietra fossena fiammata. Piano snack in rovere spessart. Sgabelli Ventura in olmo nero e pelle Soft 14 oliva.

To the right: base units and island with doors, drawers and pull-out storage baskets in laminate touch bianco and top in laminate tutto-colore touch bianco with insert in black colour. Poliform personalized island-hood Flat in scotch brite steel. Castoro embossed lacquered shelf with back in laminate tuttocolore touch castoro. Backs in fossena stone blaze. Snack top in spessart oak. Ventura stools in black elm and leather Soft 14 oliva.







Nelle pagine precedenti: basi e isola con ante, cassetti ed estrattori in laminato touch bianco e top in laminato tuttocolore touch bianco con inserto colore nero. Cappa Flat a isola in acciaio scotch brite personalizzata Poliform. Pensili e colonne con ante in laminato touch castoro. Mensola in laccato goffrato castoro con schienale in laminato tuttocolore touch castoro. Schienali in pietra fossena fiammata. Piano snack in rovere spessart. Sgabelli Ventura in olmo nero e pelle Soft 14 oliva. A sinistra: isola con ante ed estrattori laminato touch bianco. Top in laminato tuttocolore touch bianco con lavello integrato. Piani cottura Miele Smart Line a induzione con piastra Teppan Yaki in acciaio e vetroceramica. Cappa Flat a isola in acciaio scotch brite personalizzata Poliform.

Previous pages: base units and island with doors, drawers and pull-out storage baskets in laminate touch bianco and top in laminate tutto-colore touch bianco with insert in black colour. Poliform personalized island-hood Flat in scotch brite steel. Wall units and tall units with doors in laminate touch castoro. Castoro embossed lacquered shelf with back in laminate tuttocolore touch castoro. Backs in fossena stone blaze. Snack top in spessart oak. Ventura stools in black elm and leather Soft 14 oliva. To the left: island with doors and pull-out storage baskets laminate touch bianco. Worktop in laminate tutto-colore touch bianco with integrated sink. Induction hobs Miele Smart Line with Teppan Yaki griddle in steel and glass ceramics. Poliform personalized island-hood Flat in scotch brite steel.

A destra: basi e isola con ante, cassetti ed estrattori in laminato touch bianco. Top in laminato tuttocolore touch bianco con lavelli integrati. Piano cottura filotop a cinque fuochi personalizzato Poliform by Barazza e piani cottura Miele Smart Line a induzione con piastra Teppan Yaki in acciaio e vetroceramica. Cappa Flat a isola in acciaio scotch brite personalizzata Poliform.

To the right: base units and island with doors, drawers and pull-out storage baskets in laminate touch bianco. Worktop in laminate tutto-colore touch bianco with integrated sinks. Personalized built-in hob with five burners Poliform by Barazza and induction hobs Miele Smart Line with Teppan Yaki griddle in steel and glass ceramics. Poliform personalized island-hood Flat in scotch brite steel.







Nelle pagine precedenti: basi e isola con ante, cassetti ed estrattori in laminato touch bianco. Cappa Flat a isola in acciaio scotch brite personalizzata Poliform. Pensili e colonne con ante laminato touch castoro. Schienali in pietra fossena fiammata. Piano snack in rovere spessart. Sgabelli Ventura in olmo nero e rivestimento in pelle Soft 14 oliva. A sinistra: estrattore con sistema di illuminazione interna a led. Cassetto interno verniciato brown e attrezzatura in noce canaletto e alluminio anodizzato moka. Sotto: dettaglio dell'estrattore in laminato touch bianco, con piattiaia e attrezzatura interna in noce canaletto e alluminio anodizzato moka.

Previous pages: base units and island with doors, drawers and pull-out storage baskets in laminate touch bianco. Poliform personalized island-hood Flat in scotch brite steel. Wall units and tall units with doors in laminate touch castoro. Backs in fossena stone blaze. Snack top in spessart oak. Ventura stools in black elm and covering in leather Soft 14 oliva. To the left: pull-out storage basket with brown painted inner drawer with inner led lighting system. Inner equipment in walnut canaletto and moka anodized aluminium. Below: close-up of pull-out storage basket in laminate touch bianco, plate holder and inner equipment in walnut canaletto and moka anodized aluminium.

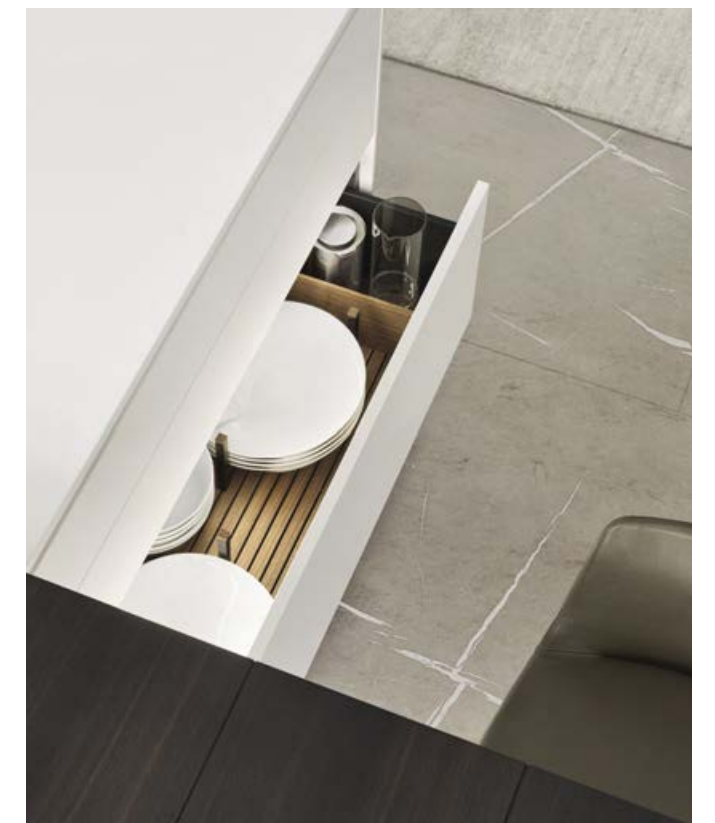



In questa pagina: basi e isola con ante, cassetti ed estrattori in laminato touch bianco e top in laminato tuttocolore touch bianco con inserto colore nero. Cappa Flat a isola in acciaio scotch brite personalizzata Poliform. Pensili e colonne con ante in laminato touch castoro. Mensola in laccato goffrato castoro con schienale in laminato tuttocolore touch castoro. Schienali in pietra fossena fiammata. Piano snack in rovere spessart. Sgabelli Ventura in olmo nero e pelle Soft 14 oliva. Sotto: dettaglio del top in laminato tuttocolore touch bianco con inserto colore nero.

This page: base units and island with doors, drawers and pull-out storage baskets in laminate touch bianco and top in laminate tuttocolore touch bianco with insert in black colour. Poliform personalized island-hood Flat in scotch brite steel. Wall units and tall units with doors in laminate touch castoro. Castoro embossed lacquered shelf with back in laminate tuttocolore touch castoro. Backs in fossena stone blaze. Snack top in spessart oak. Ventura stools in black elm and leather Soft 14 oliva. Below: close-up of the worktop in laminate tuttocolore touch bianco with insert in black colour.



ALEA

Design R&D Poliform

Basi e isola p 740 - 1270

Strutture: nobilitato grigio lavagna.
 Ante, cassetti ed estrattori: laminato touch bianco.
 Maniglie: sagoma laccato goffrato bianco.
 Top basi: laminato tuttocolore touch bianco, spessore 52 mm con inserto colore nero.
 Top isola: laminato tuttocolore touch bianco, spessore 20 mm.
 Schienali: pietra fossena fiammata, acciaio scotch brite e laminato tuttocolore touch castoro.
 Zoccoli: laccato goffrato carbone.

Mensole p 405

Top: laccato goffrato castoro, spessore 30 mm.
 Schienali: laminato tuttocolore touch castoro, spessore 20 mm.

Colonne p 640

Strutture: nobilitato grigio lavagna.
 Ante: laminato touch castoro.
 Maniglie: laccato goffrato castoro, incassate bordo anta.
 Zoccoli: laccato goffrato carbone.

Pensili p 410

Strutture: nobilitato grigio lavagna.
 Ante: laminato touch castoro.
 Aperture: a ribalta con profilo luminoso.

Snack

Rovere spessart.

Complementi

Sgabello Ventura: struttura in olmo nero e rivestimento in pelle Soft 14 oliva.

Base units and island d 29 1/4"- 50"

Structures: grey lavagna melamine.
 Doors, drawers and pull-out baskets: laminate touch bianco.
 Handles: bianco embossed lacquered profile.
 Base units top: laminate tuttocolore touch bianco, thickness 2" with insert in black.
 Island top: laminate tuttocolore touch bianco, thickness 3/4".
 Backs: fossena stone blaze, scotch brite steel and laminate tuttocolore touch castoro.
 Plinths: embossed lacquered carbone.

Shelves d 16"

Top: embossed lacquered castoro, thickness 1 1/4".
 Backs: laminate tuttocolore touch castoro, thickness 3/4".

Tall units d 25 1/4"

Structures: grey lavagna melamine.
 Doors: laminate touch castoro.
 Handles: embossed lacquered castoro, built-in in the door edge.
 Plinths: embossed lacquered carbone.

Wall units d 16 1/4"

Structures: grey lavagna melamine.
 Doors: laminate touch castoro.
 Openings: flap doors with lighted profile.

Snack top

Spessart oak.

Accessories

Ventura stool: structure in black elm and covering in leather Soft oliva 14.

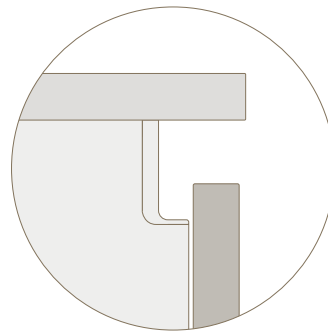

Isola Island

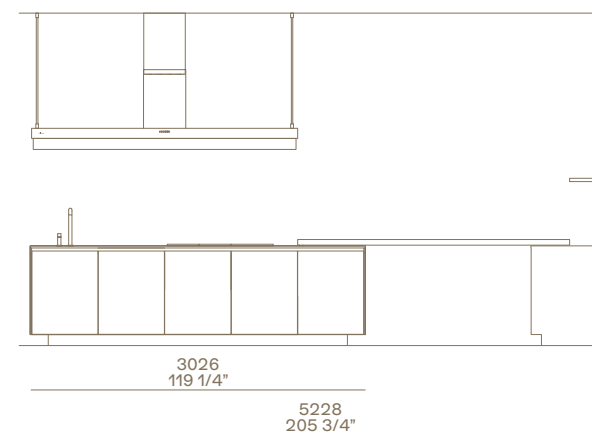

Colonne Tall units



Ventura

Design Jean-Marie Massaud

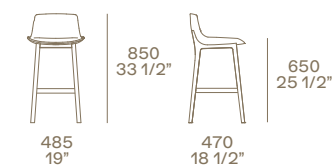

Basi e mensole Base units and shelves

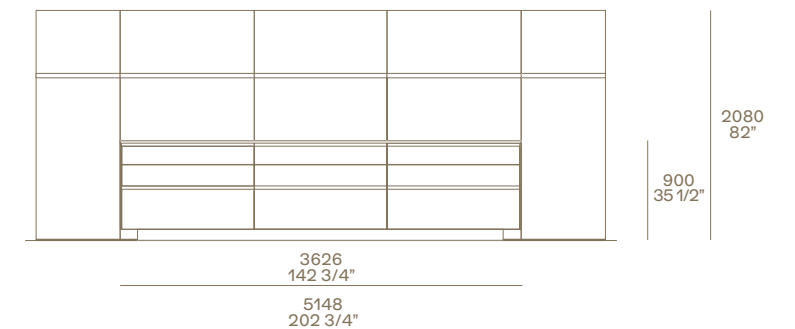

Basi e pensili Base units and wall units

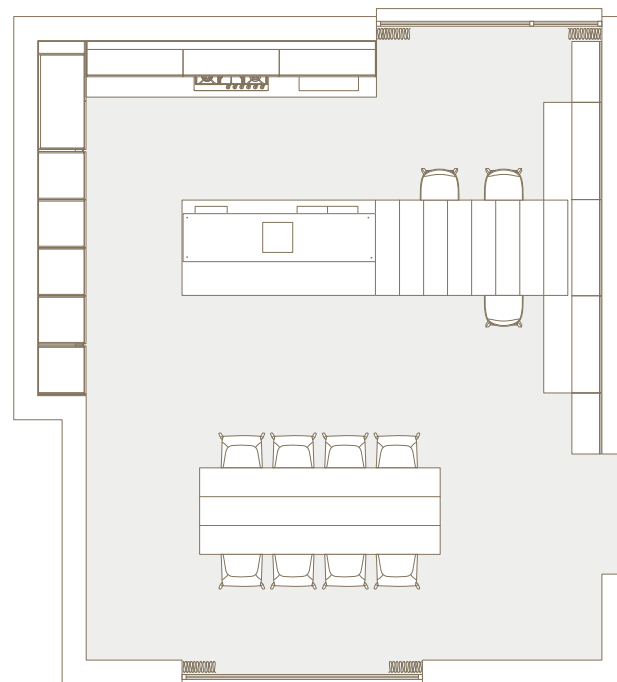
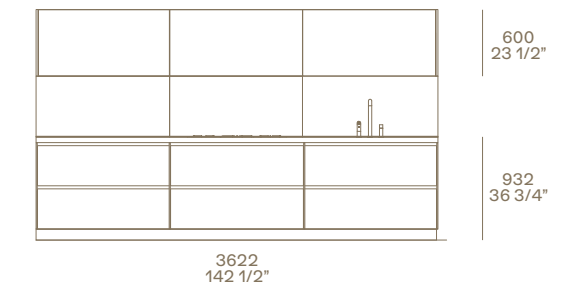

- 1 Colonne con forni, frigo/congelatore e macchina caffè da incasso standard con ante ad apertura battente ed estrattori.
- 2 Pensili con apertura a ribalta.
- 3 Cappa a scomparsa personalizzata Poliform.

- 4 Piano cottura acciaio scotch brite, 5 fuochi personalizzato Poliform by Barazza, incasso filotop.
- 5 Attrezzatura interna in noce canaletto e alluminio anodizzato moka.
- 6 Lavello integrato in laminato tuttocolore touch bianco con fondo acciaio scotch brite.

- 7 Piani cottura Miele Smart Line a induzione con piastra Teppan Yaki in acciaio e vetroceramica, incasso filotop.
- 8 Cappa Flat a isola in acciaio scotch brite personalizzata Poliform.
- 9 Piano snack 1270 x 2400.
- 10 Mensole profondità 405 mm.

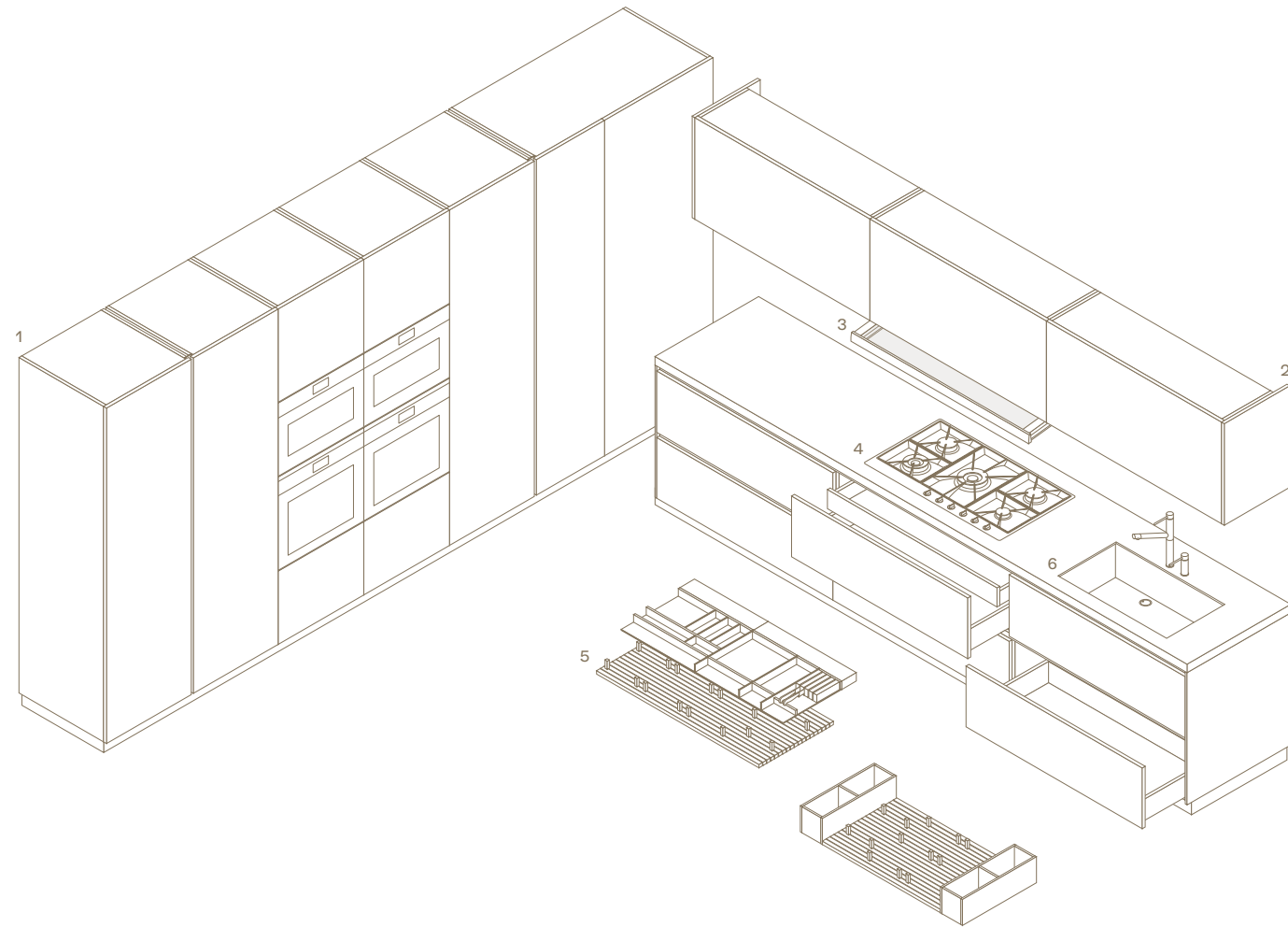

- 1 Tall units with ovens, fridge/freezer and standard built-in coffee machine with leaf doors and pull-out baskets.
- 2 Wall units with flap doors.
- 3 Poliform personalized hidden hood.

- 4 Hob in scotch brite steel with 5 burners personalized Poliform by Barazza, flush built-in.
- 5 Inner equipment in walnut canaletto and moka anodized aluminium.
- 6 Integrated sink in laminate tuttocolore touch bianco with bottom in scotch brite steel.

- 7 Induction hobs Miele Smart Line with Teppan Yaki griddle in steel and glass ceramics, flush built-in.
- 8 Poliform personalized island-hood Flat in scotch brite steel.
- 9 Snack top 50" x 94 1/2".
- 10 Shelves depth 16".

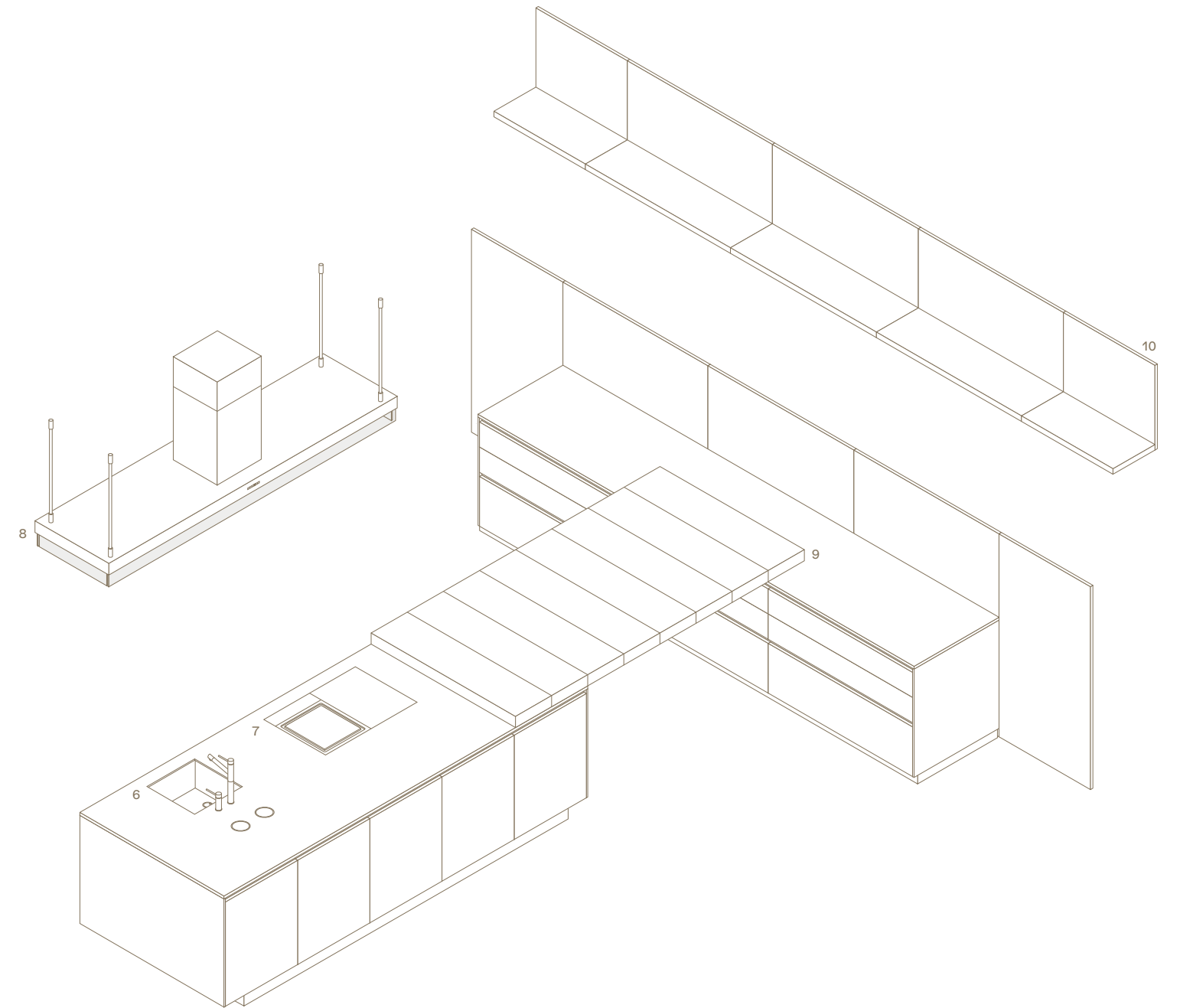

ALEA

Design R&D Poliform

Spessore anta

20 mm.

Finiture anta

Laminato opaco 6 colori.
Laminato opaco touch 6 colori.
Laccato lucido 18 colori.
Laccato goffrato 23 colori.
Laccato metallico 4 colori.
Nobilitato 7 finiture.
8 essenze.
Acciaio scotch brite.
Vetro satinato 6 colori.
Vetro lucido 6 colori.

Ante vetro con telaio di supporto
in alluminio anodizzato naturale
o anodizzato nero.

Door thickness

20 mm - 3/4".

Door finishings

Mat laminate 6 colours.
Mat laminate touch 6 colours.
Glossy lacquered 18 colours.
Embossed lacquered 23 colours.
Metallic lacquered 4 colours.
Melamine 7 finishings.
8 woods.
Steel scotch brite.
Etched glass 6 colours.
Glossy glass 6 colours.

Glass doors with supporting frame
in natural anodized or black anodized
aluminium.

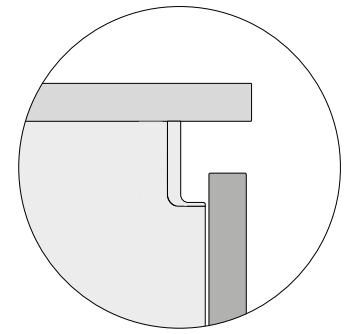

VETRINE SHOWCASES

PR19

Spessore 26 mm.
Anta in vetro riflettente 5051 bronzato
con telaio in alluminio verniciato bronzo.
Per pensili apertura con profilo inferiore
o apertura tip-on.
Thickness 26 mm - 1".
Door in bronzed reflecting glass 5051
with frame in bronzo painted aluminium.
For wall units with opening with lower
profile or tip-on opening.



PR22

Spessore 20 mm.
Anta in vetro riflettente 5059 fumé
con telaio alluminio anodizzato nero.
Per pensili apertura con profilo inferiore.
Per colonne apertura con distanziale
o con maniglia integrata verniciato nero.
Per elementi sopra colonna apertura
con distanziale o apertura tip-on.
Thickness 20 mm - 3/4".
Door in fumé reflecting glass 5059 with
black anodized aluminium frame.
For wall units with opening with lower profile.
For tall units with opening with spacer or
with black painted integrated handle.
For elements above tall unit with opening
with spacer or tip-on opening.



PR21

Spessore 26 mm.
Anta in vetro riflettente 5059 fumé
con telaio in alluminio anodizzato moka.
Per pensili apertura con profilo inferiore.
Per colonne apertura con maniglia
integrata verniciato moka.
Per elementi sopra colonna apertura tip-on.
Thickness 26 mm - 1".
Door in fumé reflecting glass 5059 with
moka anodized aluminium frame.
For wall units with opening with lower profile.
For tall units with opening moka painted
integrated handle.
For elements above tall unit with tip-on
opening.



ATTREZZATURA CASSETTI DRAWERS EQUIPMENTS

Tipologie

- 1 Cassetti.
- 2 Cassetti interni estraibile.
- 3 Cassetti interni anta.

Accessori

Portaposate, portacoltelli, bilancia elettronica, tagliere per pane, portaspezie in ceramica, vaschette in acciaio, set macinaspezie, portapelliole, portamattarello.

Types

- 1 Drawers.
- 2 Pull-out baskets.
- 3 Leaf door with inner drawers.

Accessories

Cutlery tray, knife-rack, electronic scale, chopping board for bread, ceramic spice-holder, steel basins, spice grinder set, protective-film rack, rolling pin-holder.

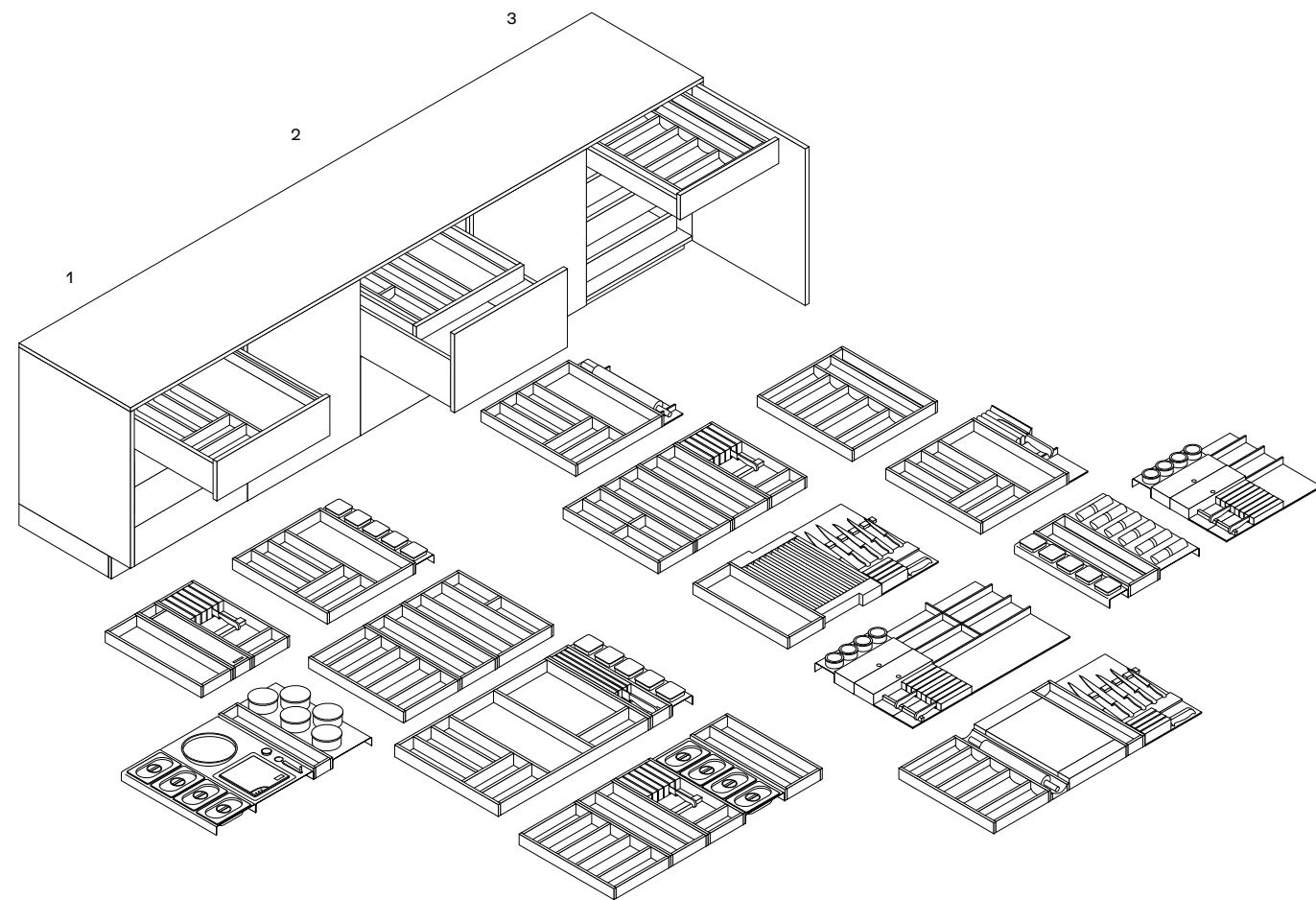

Attrezzature Equipments



Wengé
Wenge



Noce canaletto
Walnut canaletto



Laminato military touch
Laminate military touch



Alluminio
Aluminium



Materiale plastico
atossico antracite
Non-toxic plastic
colour antracite

ATTREZZATURA ESTRATTORI PULL-OUT BASKETS EQUIPMENTS

Tipologie

- 1 Base 1 estraibile e 2 cassetti.
- 2 Base 2 estraibili.
- 3 Base 1 estraibile unico e 1 estraibile interno.

Accessori

Piattaia, portapiatti regolabile, barattoli portapasta in acciaio, portapane in terracotta, portaspezie in ceramica, portarotolo, contenitori in ceramica, contenitori in acciaio.

Types

- 1 Base unit 1 pull-out basket and 2 drawers.
- 2 Base unit 2 pull-out baskets.
- 3 Base unit 1 pull-out basket and 1 inner pull-out basket.

Accessories

Plate-rack, adjustable plate-rack, kit pasta-holders in steel, clay bread container, ceramic spice-holder, rolling pin-holder, ceramic holders, steel holders.

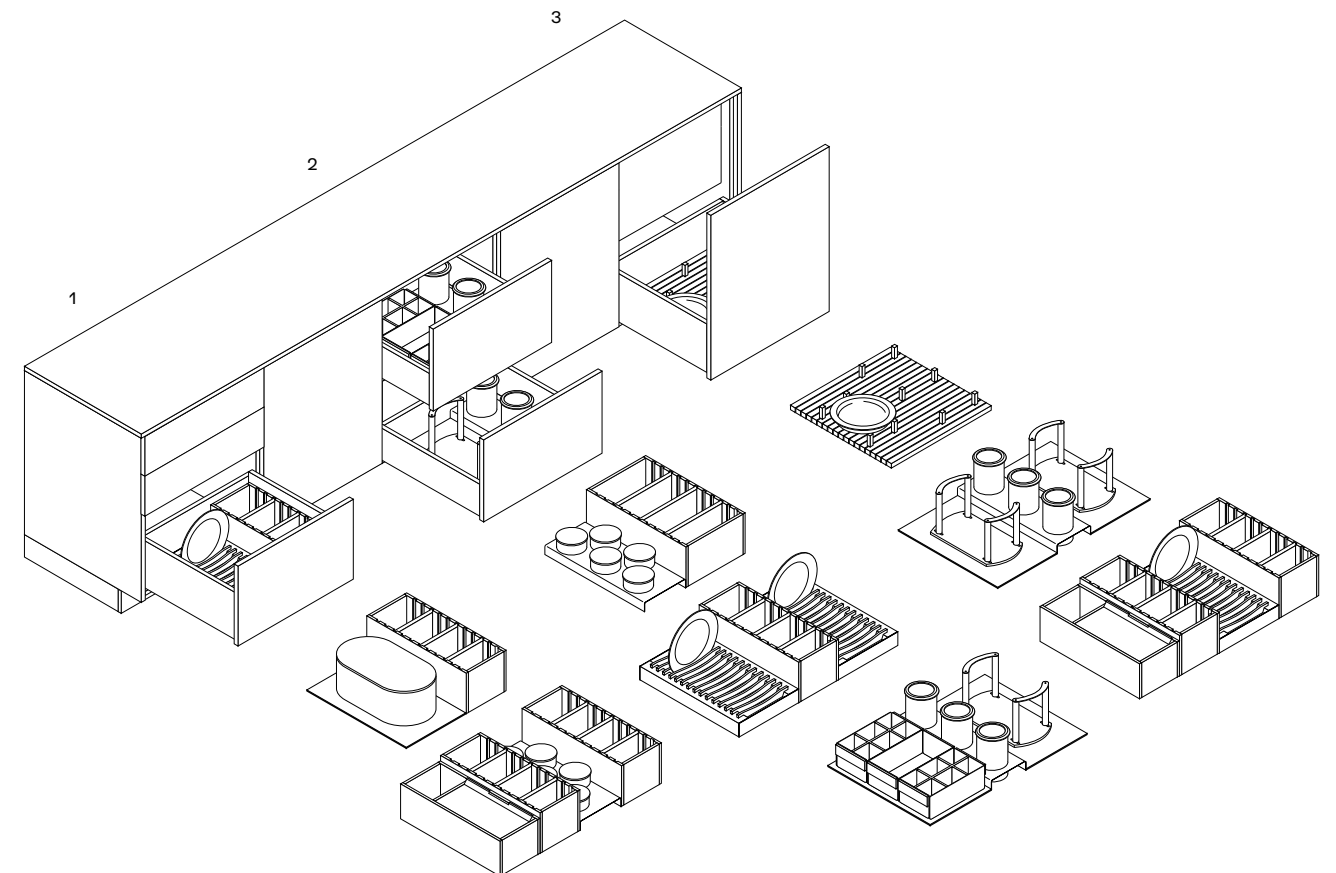

Attrezzature Equipments



Wengé
Wenge



Noce canaletto
Walnut canaletto



Laminato military touch
Laminate military touch



Alluminio
Aluminium

COLONNE ATTREZZATE EQUIPPED TALL UNITS

Tipologie

- 1 Colonna con struttura estraibile Tandem.
- 2 Colonna con struttura estraibile Convoy Lavido.
- 3 Colonna con struttura estraibile Convoy Centro.
- 4 Colonna attrezzata con ganci portascoppe e cestelli.

Types

- 1 Tall unit with Tandem extractable equipment.
- 2 Tall unit with Convoy Lavido extractable equipment.
- 3 Tall unit with Convoy Centro extractable equipment.
- 4 Tall unit with broom-holders and storage baskets.

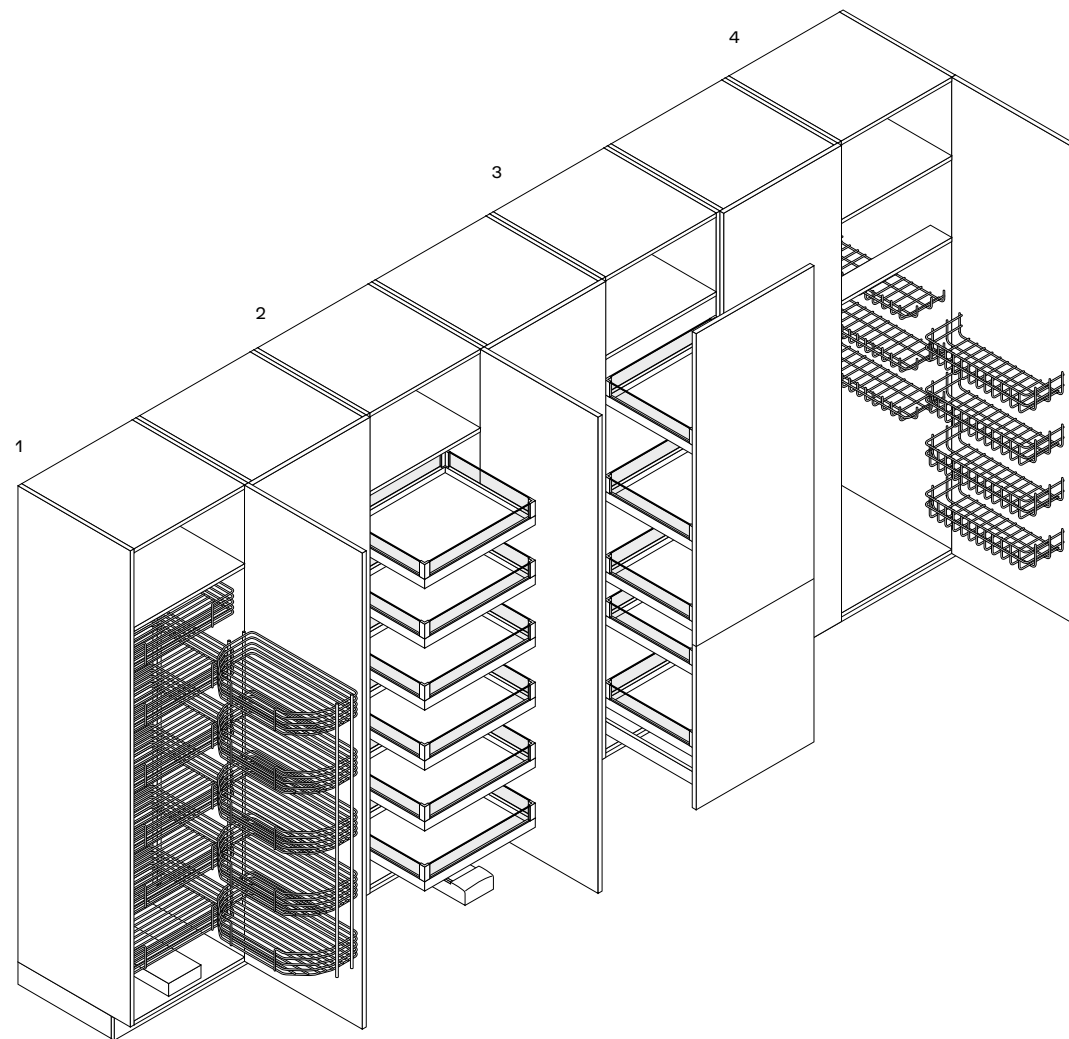

VANI ATTREZZATI EQUIPPED UNITS

Tipologie

- 1 Ante battenti apertura totale.
- 2 Ante a scomparsa.

Attrezzature

Piano di lavoro estraibile in acciaio o essenza, barra con lampade e presa elettrica, cassetti interni, ripiani, ripiani in vetro, Shaker e Deep Shaker, luce led.

Types

- 1 Total opening leaf door.
- 2 Pocket doors.

Equipments

Extractable worktop in steel or woods, light cover bar with lamp and socket, internal drawers, shelves, shelves in glass, Shaker and Deep Shaker, led lighting.

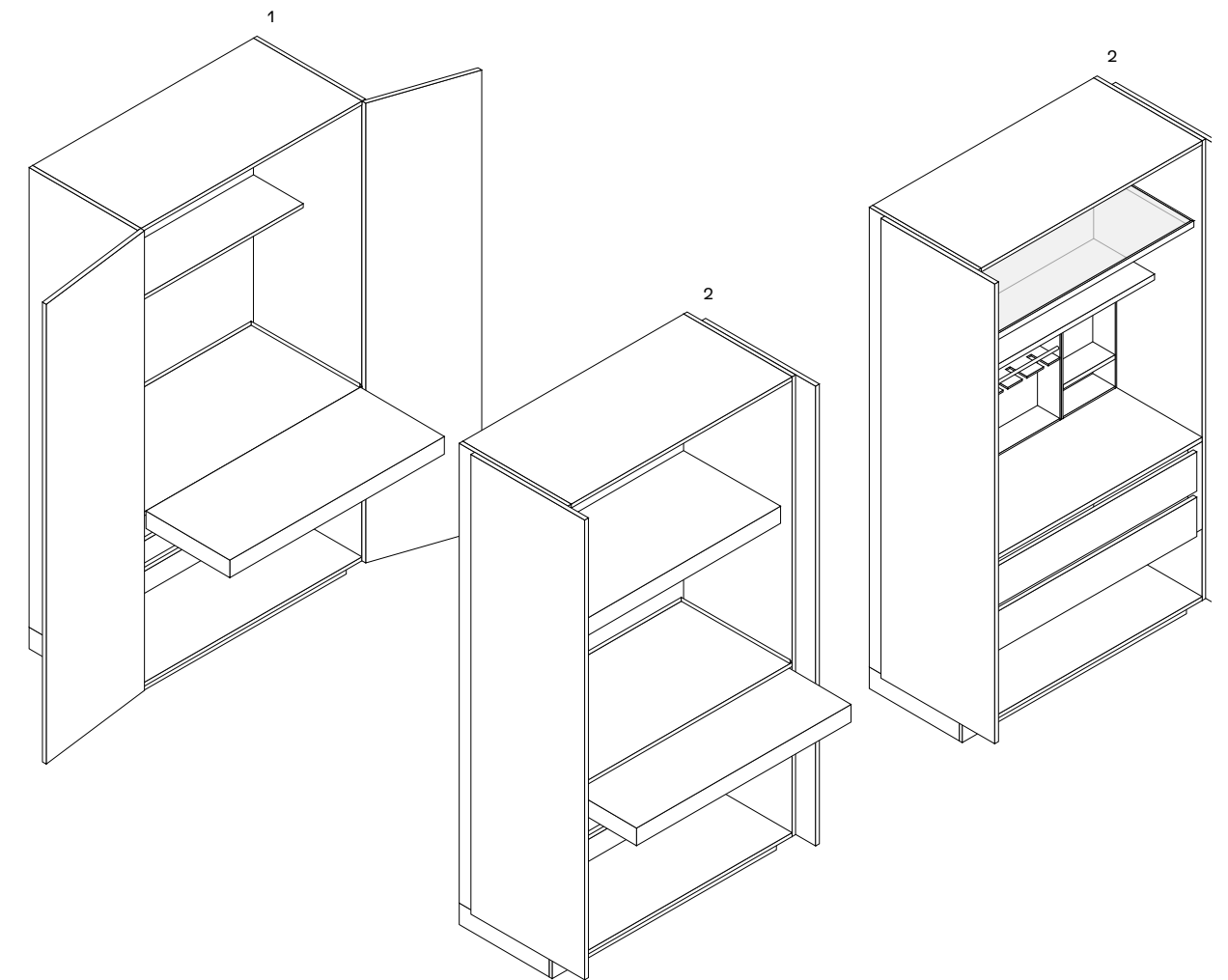

COLONNE CON VANI A GIORNO
OPEN TALL UNITS

Tipologie

- 1 Colonna a giorno con ripiani.
- 2 Colonna a giorno con cestelli in midollino.
- 3 Colonna a giorno Trail.

Types

- 1 Open tall unit with shelves.
- 2 Open tall unit with wicker baskets.
- 3 Trail open tall unit.

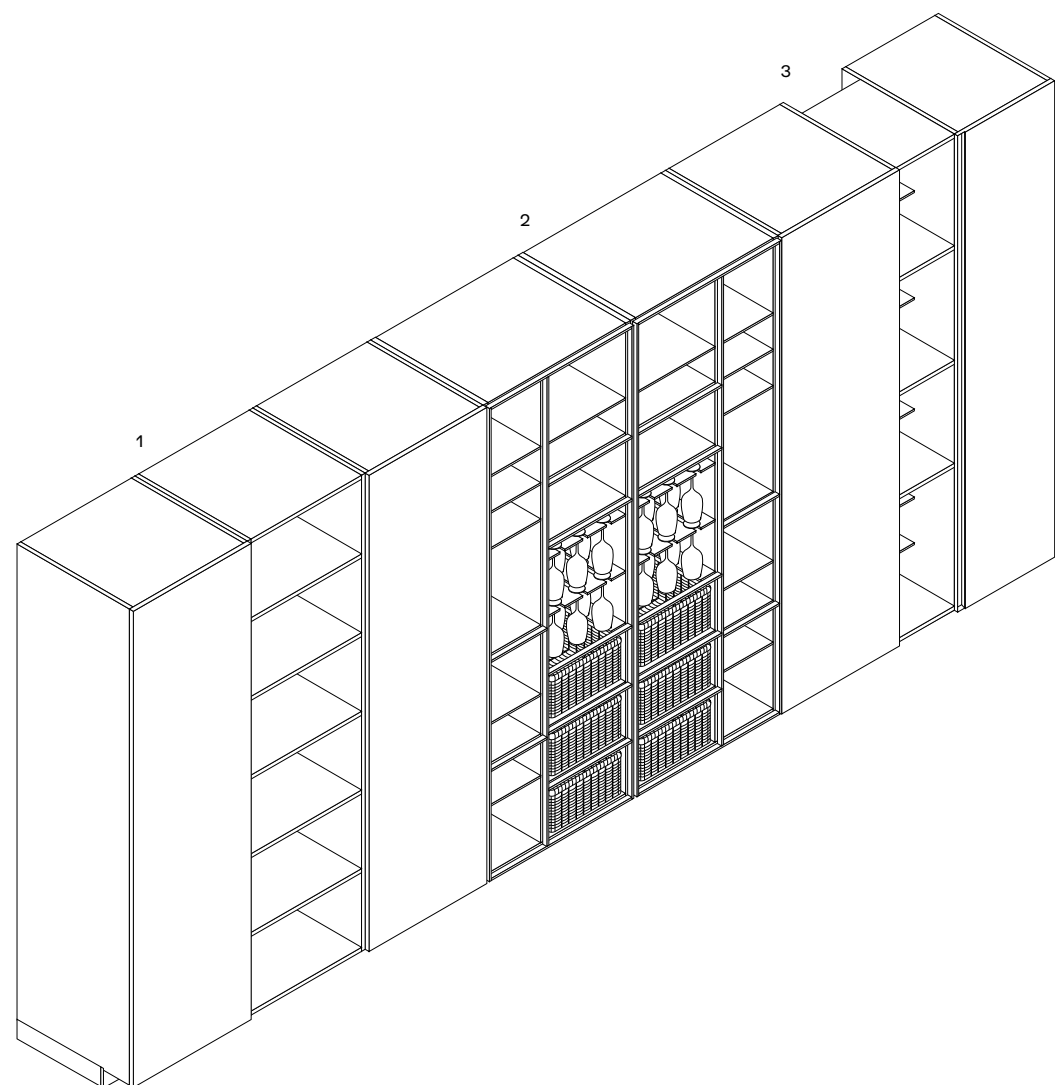

DEEP SHAKER E SHAKER SCHIENALI MODULARI
DEEP SHAKER AND SHAKER MODULAR BACKS

Deep Shaker - profondità 160
Shaker - profondità 120

Schienali modulari disponibili in diverse dimensioni e configurazioni.
Moduli larghezza da 300 a 1200.

- 1 Moduli sopratop, misure variabili in riferimento allo spessore del top.
Moduli Shaker h 600.
Moduli Deep Shaker h 600-720-840.
- 2 Moduli a terra, Shaker e Deep Shaker h 1380-1440.

Deep Shaker attrezzature

Ripiani, tubi, contenitori in DuPont Corian®, porta spezie, porta coltelli, porta tablet, griglia, porta bicchieri, cassettoni in noce canalotto, barattoli in ceramica o in vetro, canalina elettrificata. Anta a ribalta con porta spezie, barattoli in ceramica o attrezzatura elettrica.

Shaker attrezzature

Ripiani, tubi, contenitori in DuPont Corian®, griglia, porta bicchieri.

Deep Shaker - depth 6 1/4"
Shaker - depth 4 3/4"

Modular backs available in different sizes and configurations.
Modules width from 11 3/4" to 47 1/4".

- 1 Module above worktop, sizes according to the worktop thickness.
Shaker modules h 23 1/2".
Deep Shaker modules h 23 1/2"-28 1/4"-33".
- 2 Floorstanding modules, Shaker and Deep Shaker h 54 1/4"-56 3/4".

Deep Shaker accessories

Shelves, bars, containers in DuPont Corian®, spice holders, knife-rack, tablet holder, little drawers in walnut canaletto, ceramic or glass jars, powered conduit. Flap door with spices holder, ceramic jars or electric accessories.

Shaker accessories

Shelves, bars, containers in DuPont Corian®, grid, glass holders.

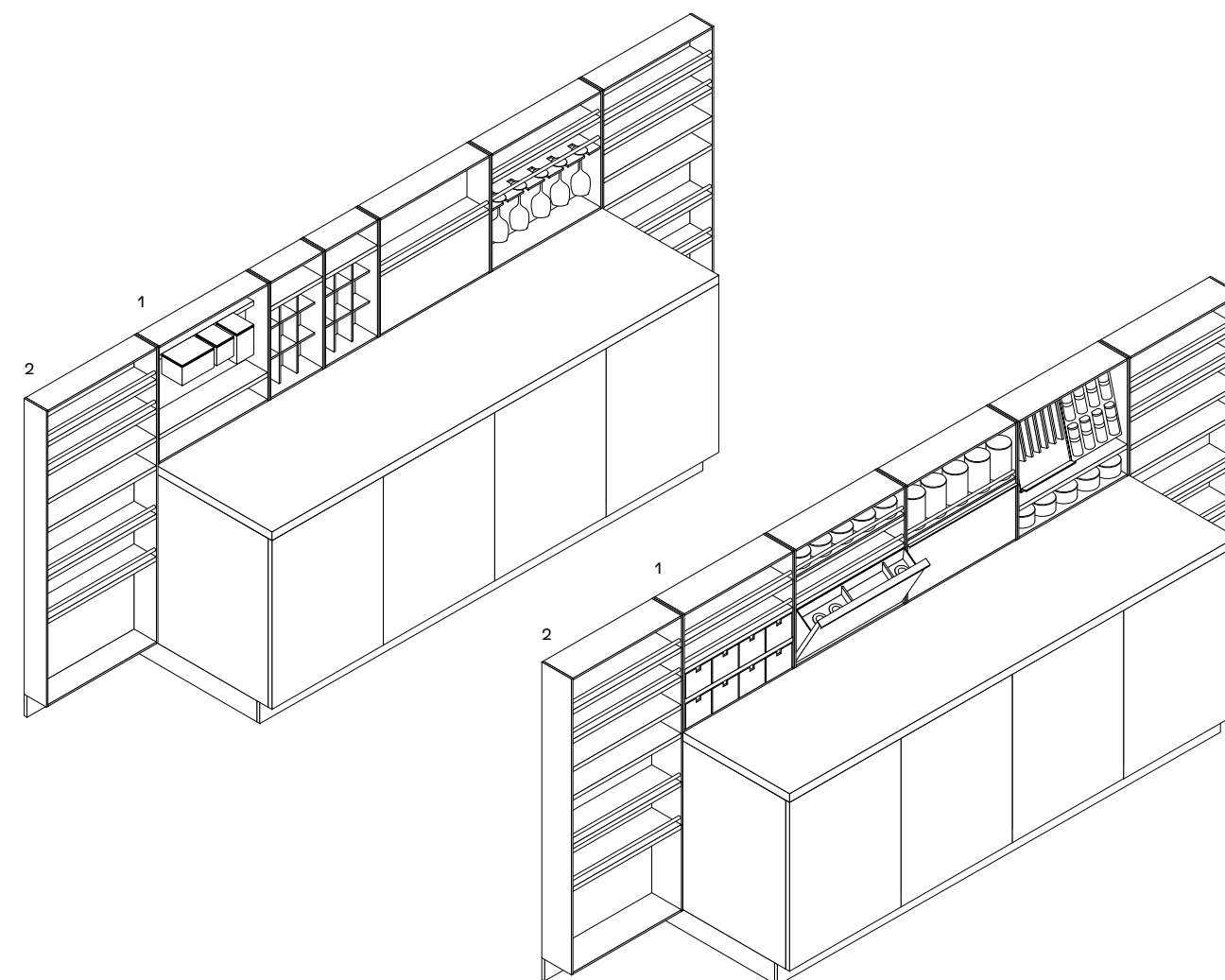

SOLUZIONI PER ANGOLI CORNER SOLUTIONS

Basi

- 1 Base doppio battente.
- 2 Base anta battente.

Pensili

- 3 Pensile anta battente.
- 4 Pensile anta pieghevole.
- 5 Pensile doppio battente.

Colonne

- 6 Colonna doppio battente.
- 7 Colonna anta battente.

Attrezzature

- 8 Cesti estraibili LeMans.
- 9 Cestelli in metallo cromato.

Base units

- 1 Base unit with two leaf doors.
- 2 Base unit with leaf door.

Wall units

- 3 Wall unit with leaf door.
- 4 Wall unit with folding door.
- 5 Wall unit with two leaf doors.

Tall units

- 6 Tall unit with two leaf doors.
- 7 Tall unit with leaf door and inner shelves.

Equipments

- 8 Pull-out storage baskets LeMans.
- 9 Baskets in chromed metal.

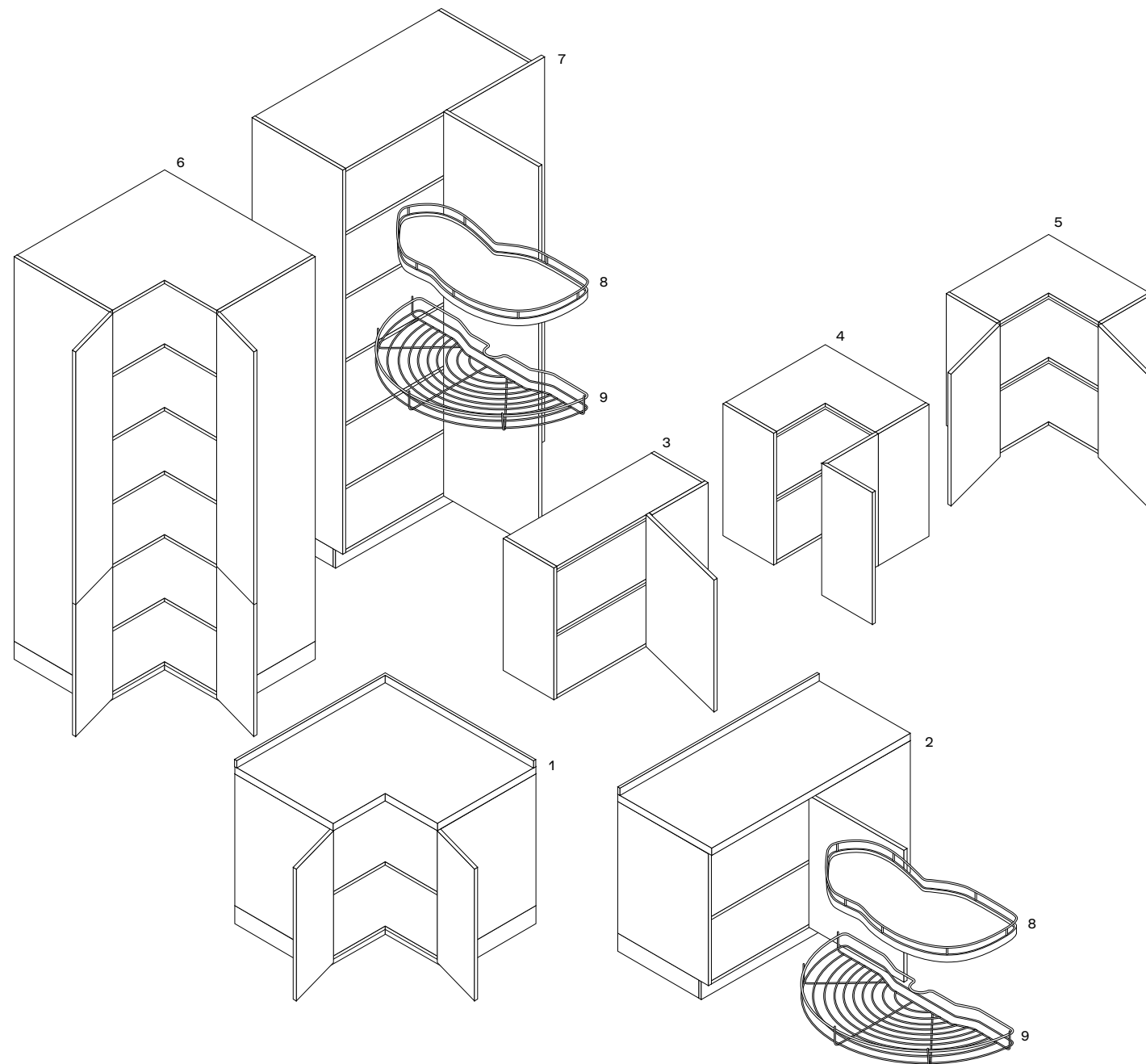

COLONNE HIGH HIGH TALL UNITS

Il sistema colonne High, disponibile per i modelli Shape, Artex, Phoenix e Trail, prevede la sovrapposizione di singoli fusti e il montaggio di un'anta intera o di due ante divise. Nel caso di ante divise, il taglio delle ante è situato sempre nella parte inferiore, a 840 mm dal filo inferiore della colonna. Lo zoccolo previsto è di 70 o 100 mm. Anta intera non disponibile nella versione in massello.

- 1 Colonna anta intera
h 2710-2740, anta h 2640
h 2830-2860, anta h 2760.
- 2 Colonna anta intera a scomparsa
h 2710-2740, anta h 2640.
- 3 Colonna con ante divise
h 2710-2740, ante h 840+1800
h 2830-2860, ante h 840+1920
h 2950-2980, ante h 840+2040.

The tall unit system High, available for the models Shape, Artex, Phoenix and trail, consists of two superimposed elements and a full height door or two separate doors. In case of separate doors, the separation of the doors is always in the lower part, 33" from the lower edge of the tall unit. The plinth is foreseen in h 3/4" or 4". The full height door is not available in solid wood finish.

- 1 Tall unit with full height door
h 106 3/4"-107 3/4", door h 104"
h 111 1/2"-112 1/2", door h 108 3/4".
- 2 Tall unit with full height pocket door
h 106 3/4"-107 3/4", door h 104".
- 3 Tall unit with separate doors
h 106 3/4"-107 3/4", doors h 33"+70 3/4"
h 111 1/2"-112 1/2", doors h 33"+75 1/2"
h 116 1/4"-117 1/4", doors h 33"+80 1/4".

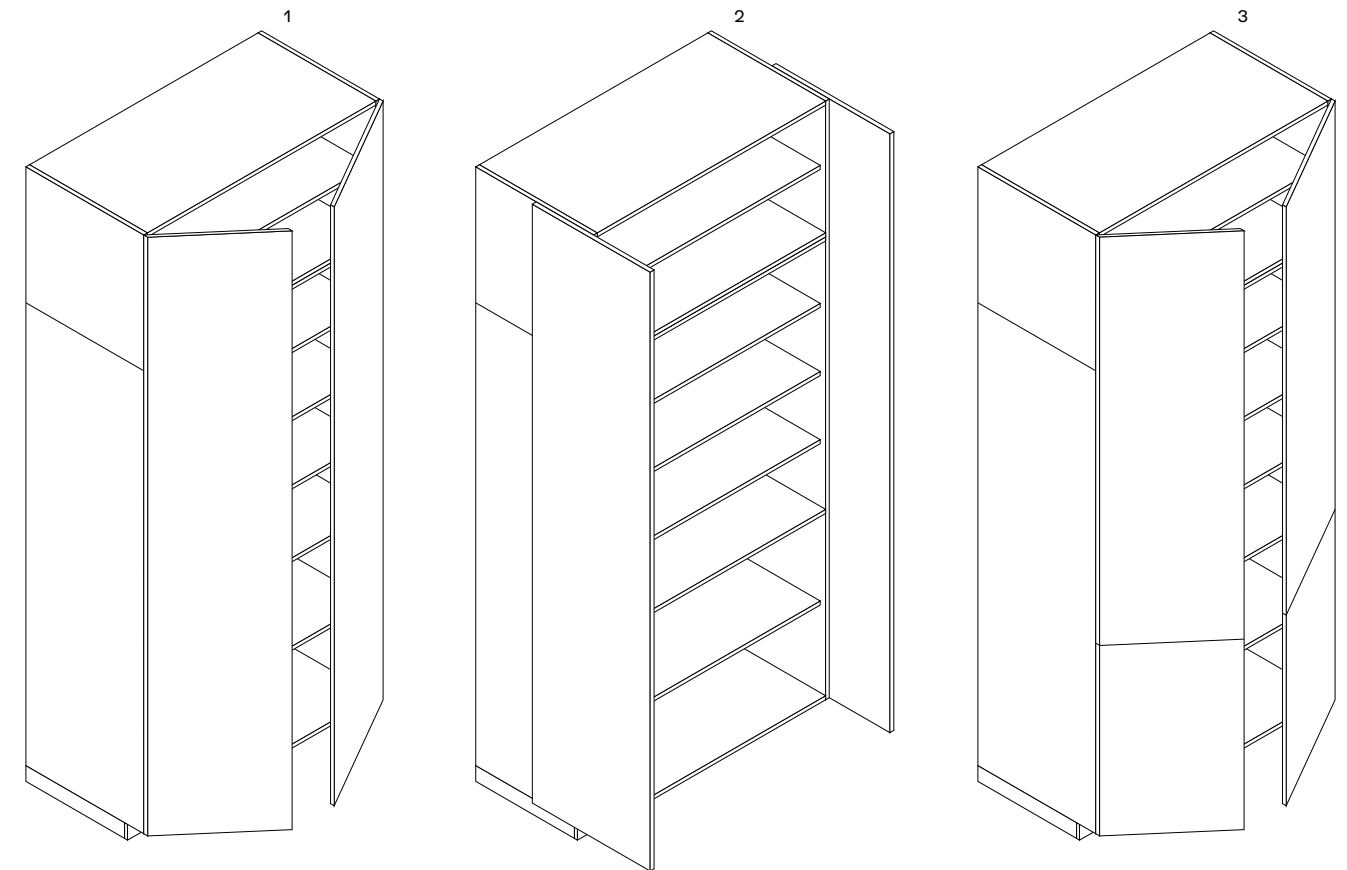

PIANI COTTURA HOBS

Tipologie

- 1 Piano a gas.
- 2 Piano a induzione.
- 3 Elementi modulari.

Tipologie di incasso

Incasso standard: il piano sporge da 4 a 15 mm; semifilotop: bordo inclinato di 3 mm; finotop: il piano sporge 1 mm; filotop. Nel caso di piani di lavoro in acciaio, i piani cottura possono essere saldati direttamente nella superficie del top.

Types

- 1 Gas hob.
- 2 Induction hob.
- 3 Modular elements.

Built-in types

Standard built-in with jutting hob of 1/4" a 1/2"; semi-flush built-in with inclined edge of 1/8"; flush built-in with jutting hob 5/128" and fully flush built-in. In case of steel worktops, the hobs can be soldered directly in the worktop.

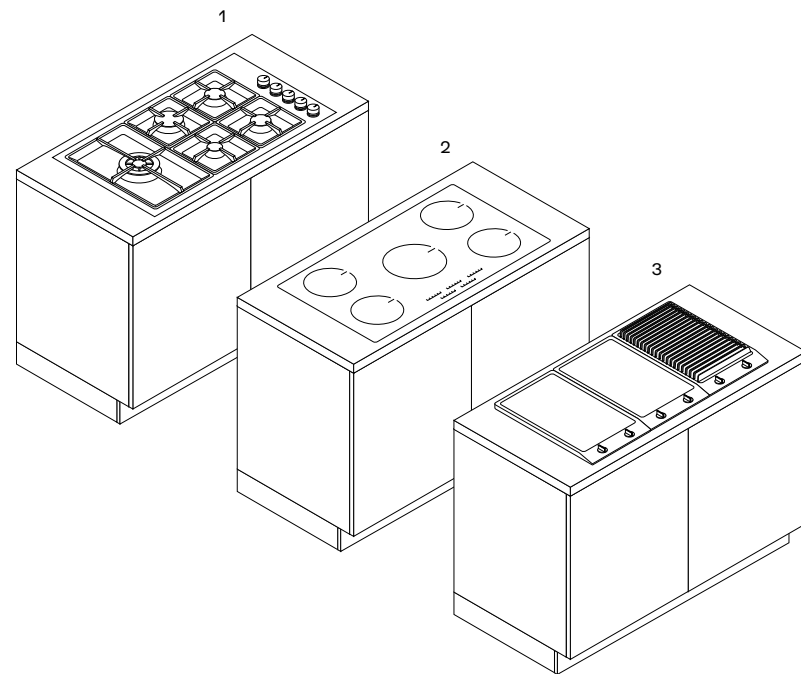

Tipologie di incasso Built-in types

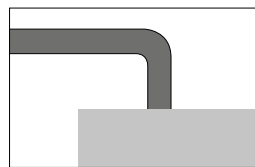

Standard
Standard built-in

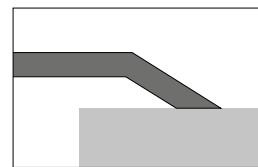

Semifilotop
Semi-flush built-in

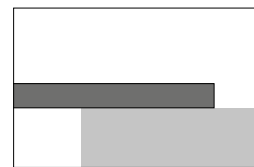

Finotop
Flush built-in

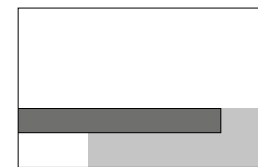

Filotop
Fully flush built-in

LAVELLI SINKS

Tipologie

- 1 Vasca singola.
- 2 Vasca e gocciolatoio.
- 3 Vasca grande e piccola.
- 4 Vasca grande, piccola e gocciolatoio.
- 5 Due vasche.
- 6 Due vasche e gocciolatoio.

Types

- 1 Single basin.
- 2 Basin with drip.
- 3 Big and small basins.
- 4 Big and small basins with drip.
- 5 Two basins.
- 6 Two basins with drip.

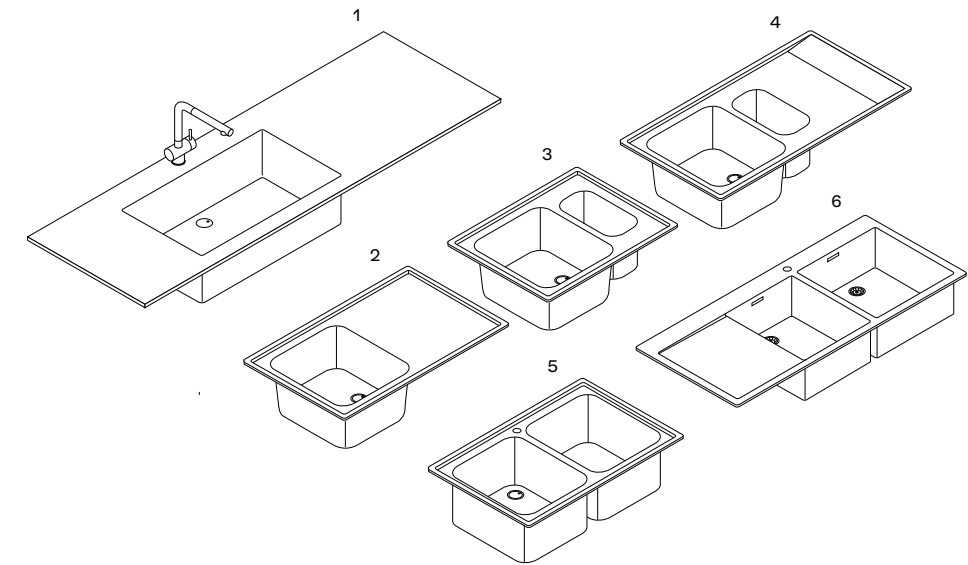

Tipologie di incasso Built-in types

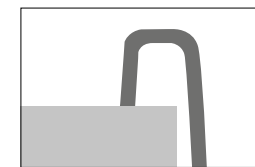

Appoggio h 40 mm
Surface-mounted h 1 1/2"

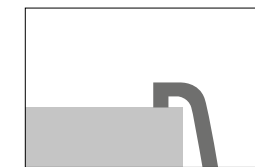

Incasso
Standard built-in

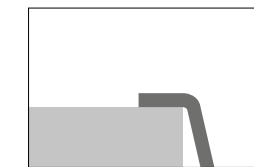

Finotop
Flush built-in



Filotop
Fully flush built-in

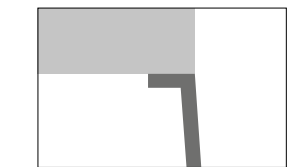

Sottotop
Under-top mounted

CAPPE HOODS

Infinity, sistema modulare

Moduli personalizzati Poliform da assemblare per configurazioni a isola con illuminazione led integrata.

- 1 Modulo aspirante luminoso
| 1050-1200-1500 con carter da 450
| 1800-2400 con carter da 600.
- 2 Modulo fitostimolante luminoso
con teca in vetro bassa o alta
| 600-750-900.
- 3 Modulo luminoso con teca in
vetro bassa o alta
| 600-750-900.
- 4 Modulo luminoso
| 600-750-900-1050-1200.

Infinity, modular system

Poliform personalized modules to be assembled for island configurations with integrated led light.

- 1 Lighted suction module
| 41 1/4"-47 1/4"-59" with carter of 17 3/4"
| 70 3/4"-92 1/2" with carter of 23 1/2".
- 2 Phytostimulant lighted module
with low or high glass case
| 23 1/2"-29 1/2"-35 1/2".
- 3 Lighted module with low or
high glass case
| 23 1/2"-29 1/2"-35 1/2".
- 4 Lighted module
| 23 1/2"-29 1/2"-35 1/2"-41 1/4"-47 1/4".

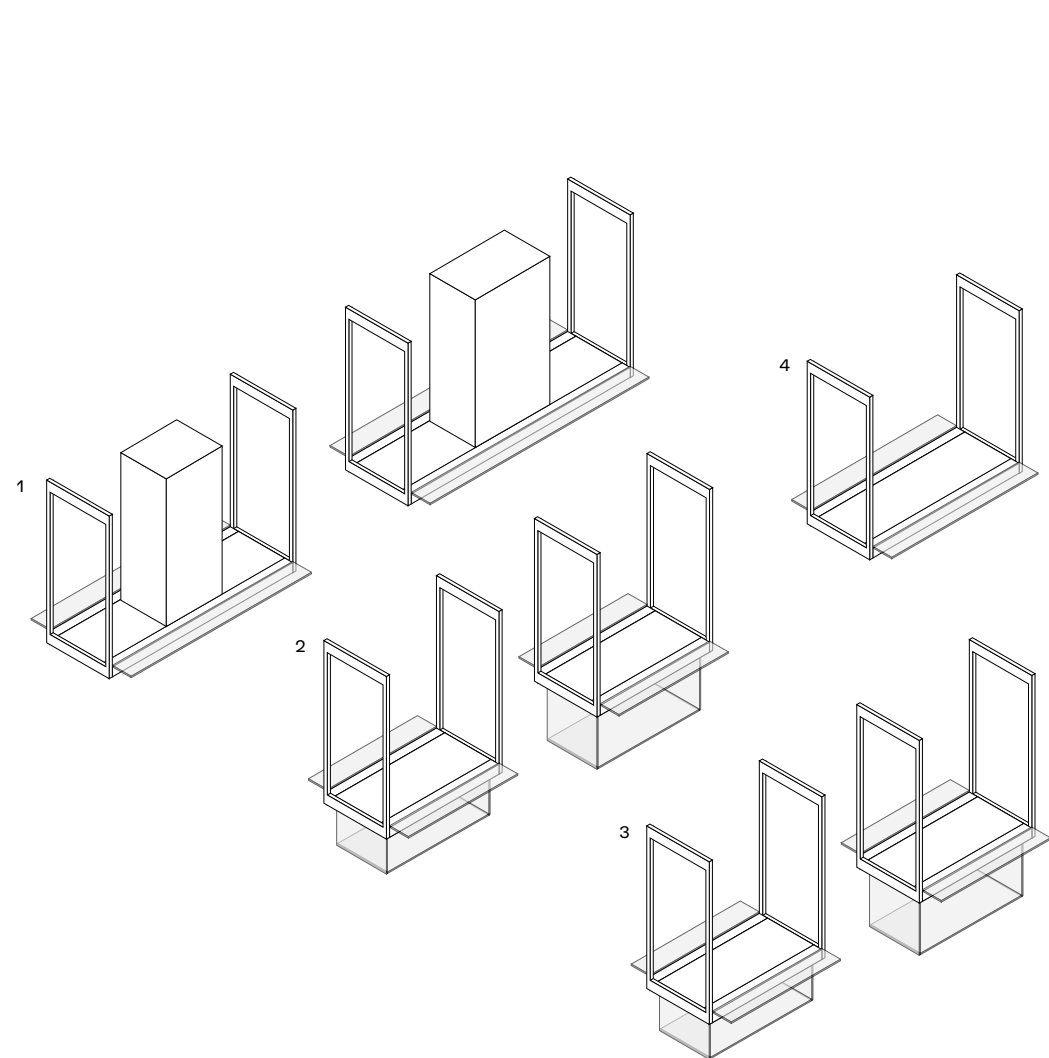

Cappe personalizzate Poliform

- 1 Cappa Piatta a parete e a isola.
- 2 Cappa Factory a isola.
- 3 Cappa Flat a parete e a isola.
- 4 Cappa Box a parete e a isola.
- 5 Cappa Glass a isola.
- 6 Cappa Work a parete e a isola.

Poliform personalised hoods

- 1 Piatta wall mounted, island-hood.
- 2 Factory island-hood.
- 3 Flat wall mounted, island-hood.
- 4 Box wall mounted, island-hood.
- 5 Glass island-hood.
- 6 Work wall mounted, island-hood.

Cappe integrate

- 7 Cappa a scomparsa.
- 8 Cappa Easy integrata nel pensile,
per piani cottura a gas o induzione.
- 9 Cappa Downdraft a scomparsa
nel top.

Integrated hoods

- 7 Retractable hood.
- 8 Easy built-in hood in the wall unit,
for gas or induction hobs.
- 9 Downdraft retractable hood
in the top.

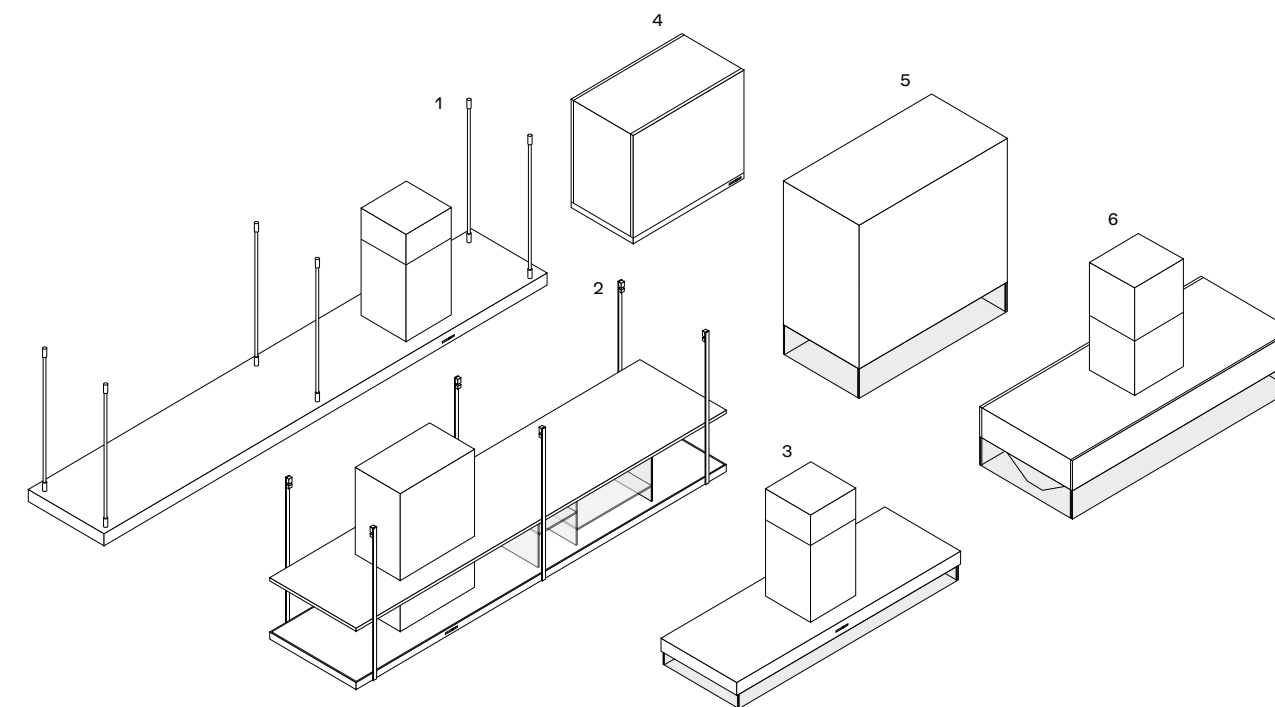

Cappe integrate Integrated hoods

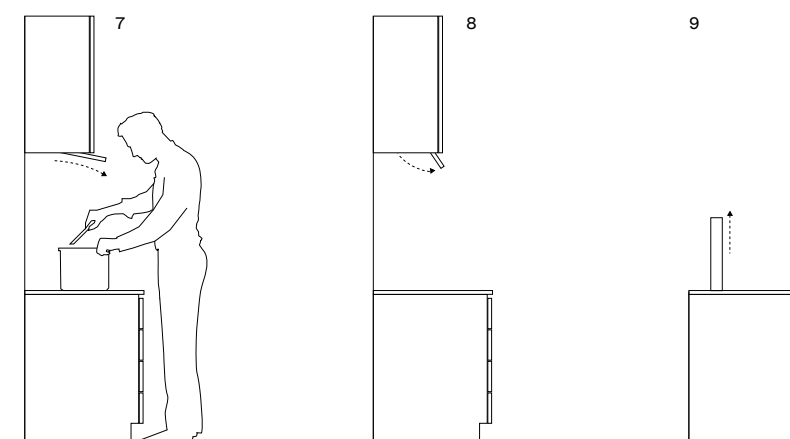

PORTARIFIUTI WASTEBINS

Basi con portarifiuti

- 1 Base livello con due estrattori o estrattore unico
1A - pattumiera raccolta differenziata T2 | 600-750-900-1050-1200 h 260.
1B - Kit sottovasca.
- 2 Base con estrattore unico
2A - pattumiera P-One | 450-600 h 550.
- 3 Base livello con estrattore unico
3A - pattumiera P-One | 600 h 360.
- 4 Base livello con anta battente
4A - pattumiera estraibile | 260 h 350.
4B - pattumiere ad estrazione totale | 275-390 h 380.
4C - pattumiera raccolta differenziata | 600-900-1200 h 360.

Base units with waste bins

- 1 Base unit with two pull-out baskets or single basket.
1A - waste bin for separate waste collection T2 - w 23 1/2"-29 1/2"- 35 1/2"- 41 1/4"- 47 1/4" h 10 1/4"
1B - Sink base kit.
- 2 Base unit with single pull-out basket.
2A -waste bin P-One w 17 3/4"-23 1/2" h 21 3/4".
- 3 Sink base unit with single pull-out basket
3A - waste bin P-One w 23 1/2" h 14 1/4".
- 4 Sink base unit with leaf door.
4A - pull-out waste bin w 10 1/4" h 13 3/4".
4B - waste bin with full extension glides w 10 3/4"-15 1/4" h 15".
4C - waste bin for separate waste collection w 23 1/2"-35 1/2"-47 1/4" h 14 1/4".

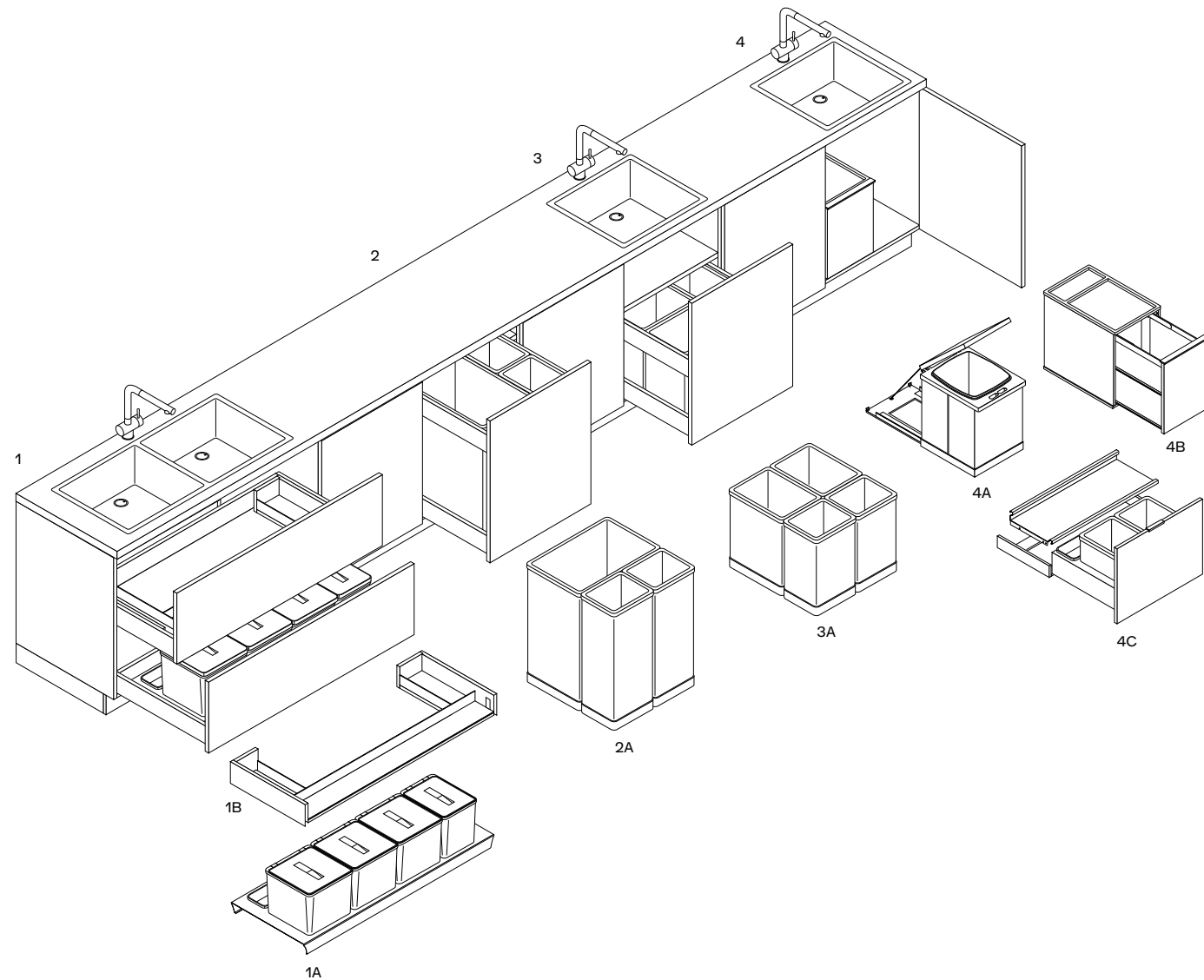

SOLUZIONI DI ILLUMINAZIONE LIGHTING SOLUTIONS

Illuminazione sul piano di lavoro

- 1 Sagoma con illuminazione multiled.
- 2 Faretto integrati sottopensile multiled.
- 3 Barra retrospensile multiled.
- 4 Barra sottopensile luminosa multiled.

Lighting on worktop

- 1 Profile with multiled lighting.
- 2 Built-in multiled spotlights.
- 3 Multiled bar to the back of the wall unit.
- 4 Multiled lighted bar under wall unit.

Multiled interno contenitori

- 5 Cassetti.
- 6 Estrattori.
- 7 Ante battenti.
- 8 Pensili.
- 9 Colonne.

Units internal multiled

- 5 Drawers.
- 6 Pull-out baskets.
- 7 Leaf doors.
- 8 Wall units.
- 9 Tall units.

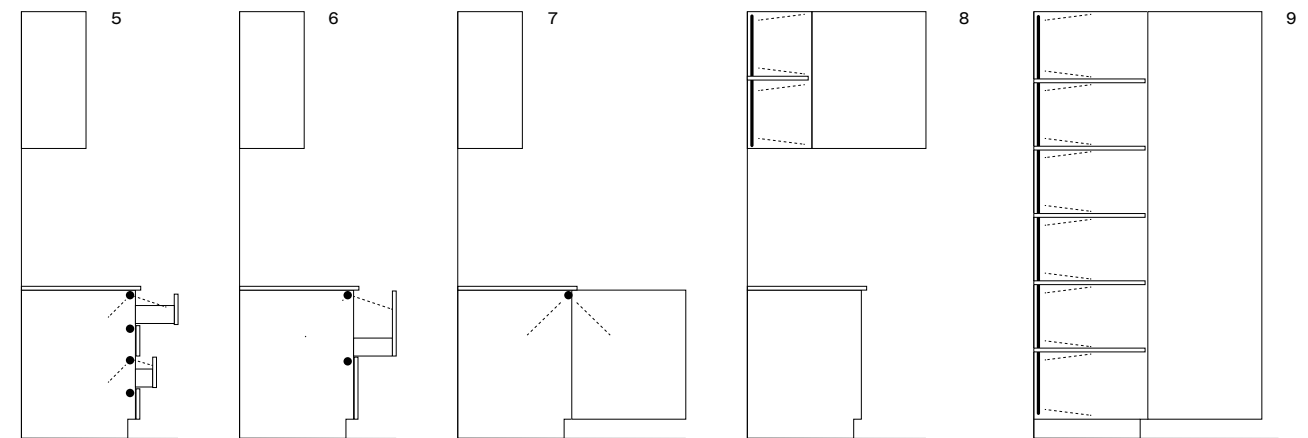
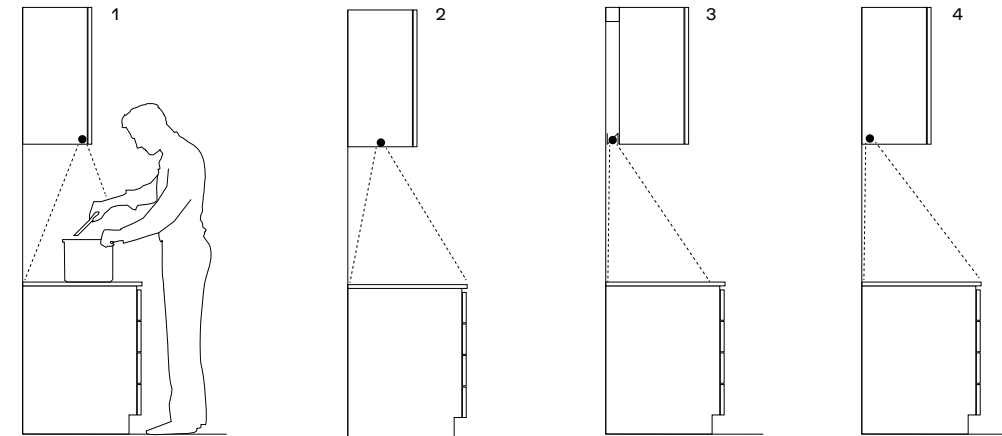

PIANI SNACK SNACK TABLES

Modelli e caratteristiche

- 1 Snack sp. 80 due lati folding con telaio. Da utilizzare sospeso o con gambe. Piano dogato in rovere, rovere spessart, rovere tinto grigio, rovere cenere, olmo nero, noce nazionale o massello di noce canaletto. Gambe e traversi alluminio finitura acciaio o laccato goffrato colori. l da 1800 a 2700 - passo 300 p 900-950-1050-1150-1200-1280.
- 2 Snack sp. 80 quattro lati folding. Da utilizzare sospeso o con gambe. Piano dogato in rovere, rovere spessart, rovere tinto grigio, rovere cenere, olmo nero, noce nazionale o massello di noce canaletto. Gambe cilindriche acciaio. l da 1800 a 2700 - passo 300 p 900-950-1050-1150-1200-1280.
- 3 Snack sp. 52. Da utilizzare su top sp. 6-12-20 con telaio di supporto alluminio previsto per modelli Artex, Twelve, Phoenix e Trail. Piano in rovere, rovere spessart, rovere tinto grigio, rovere cenere, olmo, olmo nero o noce c.; massello di noce nazionale, black ash o tinto olmo nero; laminato tuttocolore, laminato tuttocolore touch, laccato goffrato colori o in DuPont Corian®. Sui piani in laminato è previsto sul bordo un inserto in tinta o a contrasto nei colori dei laminati. l fino a 3000 snack laccati o legno l fino a 3600 snack in DuPont Corian® l fino a 4100 snack in laminato Sporgenza minima dalle basi 350 mm.
- 4 Snack sp. 80 a penisola quadrato. Da utilizzare su top sp. 6-12 con telaio di supporto alluminio previsto per modelli Twelve, Phoenix e Trail e sui top sp. 20. Piano dogato e gamba di sostegno in rovere, rovere spessart, rovere tinto grigio, rovere cenere, olmo nero o massello di noce canaletto. l 1500 x 1500 - 1800 x 1800.
- 5 Snack Moon sp. 40. Ø 1500 con due gambe. Ø 1800 con tre gambe e piano centrale girevole integrato. Piano in rovere fossile, black ash o olmo nero, gambe e inserto finta gamba in massello di rovere fossile, black ash o tinto olmo nero. Piano centrale girevole in tutti i marmi e pietre previste in collezione.

- 6 Snack Sydney sp. 40. Da utilizzare sospeso o con gamba. Piano e gamba in massello di noce, black ash o tinto olmo nero. Sydney l 1550-1700-1850-2150 x 788 l 2450 x 895. Sydney con gamba l 1850 x 900 - 2150 x 1000.
- 7 Snack Blade sp. 40. Da utilizzare sospeso o con gambe. Piano e gambe in massello di noce canaletto, black ash o tinto olmo nero. La lunghezza dello snack rettangolare si può personalizzare al centimetro. Rettangolare da l 1400 a l 2700, p 900-950-1050-1150-1200-1280. Quadrato 1500 x 1500.

Models and features

- 1 Snack th. 3 1/4" with two sides "folding" and frame. For suspended use or with legs. Slatted top in oak, spessart oak, dyed grey oak, cenere oak, black elm, Italian walnut or solid walnut canaletto. Legs and aluminium crossbars finish steel or embossed lacquer colours. w from 70 3/4" to 106 1/4" - pitch 11 3/4" d 35 1/2"-37 1/2"-41 1/4"-45 1/4"-47 1/4"-50 1/2".
- 2 Snack th. 3 1/4" four sides "folding". For suspended use or with legs. Slatted top in oak, spessart oak, dyed grey oak, cenere oak, black elm, Italian walnut or solid walnut canaletto. Cylindrical legs in steel. w from 70 3/4" to 106 1/4" - pitch 11 3/4" d 35 1/2"-37 1/2"-41 1/4"-45 1/4"-47 1/4"-50 1/2".
- 3 Snack th. 2". To be used on worktop th. 1/4"-1/2"-3/4" with aluminium supporting frame for the models Artex, Twelve, Phoenix and Trail. Top in oak, spessart oak, grey stained oak, cenere oak, elm, black elm or walnut c.; solid Italian walnut, black ash or stained black elm; laminate tuttocolore, laminate tuttocolore touch, embossed lacquer colours or in DuPont Corian®. On the edge of the laminate worktops, an inlay in contrast or matching colour is available. w up to 118" snack in lacquer or wood w up to 141 3/4" snack in DuPont Corian® w up to 161 1/2" snack in laminate Minimum overhang of the base units 13 3/4".
- 4 Square peninsula snack th. 3 1/4". To be used on worktop th. 1/4"-1/2" with supporting aluminium frame for the models Twelve, Phoenix and Trail and on worktops th. 3/4". Slatted top and supporting leg in oak, spessart oak, grey stained oak, cenere oak, black elm or solid walnut canaletto. w 59" x 59" - 70 3/4" x 70 3/4".
- 5 Snack Moon th. 1 1/2". Ø 59" with two legs. Ø 70 3/4" with three legs and swivel integrated central top. Top in fossil oak, black ash or black elm, legs and inlay as a leg in solid fossil oak, black ash or stained black elm. Swivel central top in all the marbles and stones in the collection.
- 6 Snack Sydney th. 1 1/2". For suspended use or with leg. Top and leg in solid walnut, black ash or stained black elm. Sydney w 61"-67"-72 3/4"-84 3/4" x 31" w 96 1/2" x 35 1/4". Sydney with leg w 72 3/4" x 35 1/2" - 84 3/4" x 39 1/4".
- 7 Snack Blade th. 1 1/2". For suspended use or with legs. Top and legs in solid walnut canaletto, black ash or stained black elm. The length of the rectangular snack can be customized to the centimeter. Rectangular from w 55" to 106 1/4", d 35 1/2"-37 1/2"-41 1/4"-45 1/4"-47 1/4"-50 1/2". Square 59" x 59".

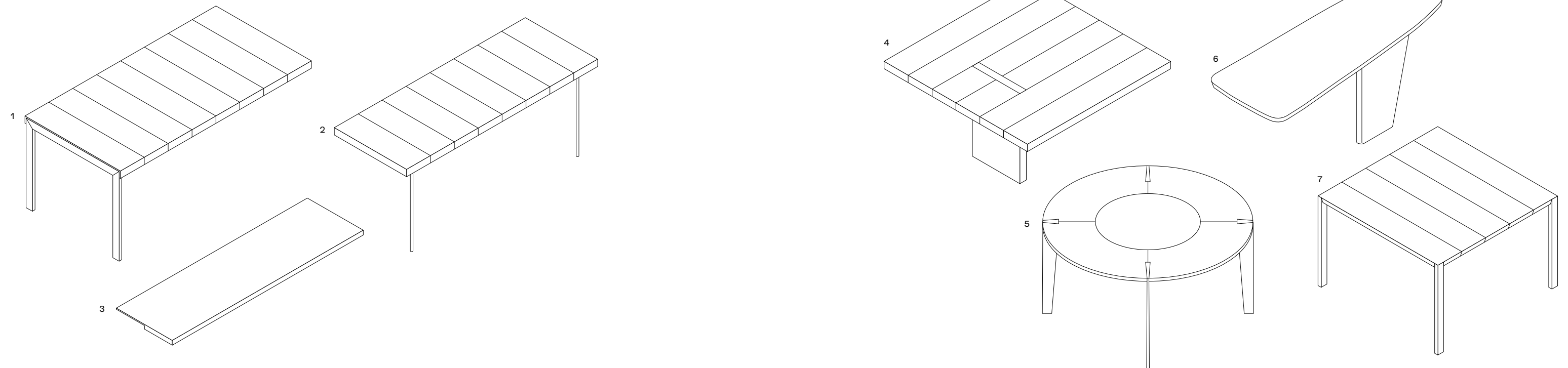

TAVOLI TABLES



Kensington
Design Jean-Marie Massaud, 2018

Struttura in alluminio spatolato ferro e bronzo o laccato opaco champagne. Piano in olmo nero, vetro fumé, marmo lucido noir saint laurent, marmo levigato e lucido bianco carrara, grigio stardust, calacatta oro o sahara noir finitura poliestere.

Il piano è caratterizzato dall'accostamento di moduli di forme e misure diverse.

Structure in aluminium with spatula finish ferro and bronzo or champagne mat lacquered. Top in black elm, fumé glass, glossy marble noir saint laurent, mat and glossy marble bianco carrara, grigio stardust,



calacatta oro or sahara noir with polyester finish. The top is distinguished by the combination of modules with different shape and size.

Dimensioni mm: rettangolare 2600 × 1200 3000 × 1200 h 740

rotondo Ø 1600 - Ø 2000 h 740

Dimensions in: rectangular 102 1/4" x 47 1/4"

118" x 47 1/4" h 29 1/4"

round Ø 63" - Ø 78 3/4" h 29 1/4"



Henry
Design Emmanuel Gallina, 2019

Tavolo fisso o allungabile. Struttura in olmo nero o noce gold. Piano in olmo nero, noce gold, cinque marmi levigati e sei lucidi, vetro lucido nei colori ghiaccio, arena, grafite, bordeaux. Allungabile solo in essenza. Fixed or extendable table. Structure in black elm or walnut gold finish. Top in black elm, walnut gold, five mat marbles and six glossy marbles, glossy glass in the colours ghiaccio, arena, grafite, bordeaux. Extendable table only version in wood.

Dimensioni mm: rettangolare 2400 × 1080 - 2850 × 1080 h 740, quadrato 1700 × 1700 h 740 allungabile 1800/2400 × 1000 h 740

Dimensions in: rectangular 94 1/2" x 42 1/2" - 112 1/4" x 42 1/2" h 29 1/4", square 67" x 67" h 29 1/4" extendable 70 3/4"/94 1/2" x 39 1/4" h 29 1/4"



Concorde
Design Emmanuel Gallina, 2009

Struttura in massello, finitura in noce gold, noce c., rovere spessart, rovere cenere o olmo nero. Piano in noce gold, noce c., rovere spessart, rovere cenere, olmo nero, cinque marmi levigati e sei lucidi. Per le versioni rettangolari è disponibile anche il piano in vetro lucido colori o in vetro riflettente blu con cornice in essenza. Per i tavoli Ø 1800 e 2000 mm è previsto un piano girevole opzionale in appoggio in laccato opaco colori, laccato lucido colori, noce gold, noce c., rovere spessart, rovere cenere, olmo nero, cinque marmi levigati e sei lucidi.



Structure in solid wood finish in walnut gold, walnut c., spessart oak, cenere oak or black elm. Top in walnut gold, walnut c., spessart oak, cenere oak, black elm, five mat and six glossy marble finishes. For the rectangular versions, the tabletop is available also in glossy glass or in blue reflecting glass with wooden frame. For the tables Ø 70 3/4" and 78 3/4" mm an optional swivel tray lean on the tabletop in the following finishes is available: mat lacquered colours, glossy lacquered colours, walnut gold, walnut c., spessart oak, cenere oak, black elm, five mat and six glossy marble finishes.



Dimensioni mm: rettangolare 2185 × 1080 - 2400 × 1080 - 2800 × 1080 h 740 rotondo Ø 1370 - Ø 1800 - Ø 2000 h 740 Ø 1800 piano girevole opzionale Ø 900 Ø 2000 piano girevole opzionale Ø 1050 Dimensions in: rectangular 86" x 42 1/2" - 94 1/2" x 42 1/2" - 110 1/4" x 42 1/2" h 29 1/4" round Ø 54" - Ø 70 3/4" - Ø 78 3/4" h 740 Ø 70 3/4" optional spinning tray Ø 35 1/2" Ø 78 3/4" optional spinning tray Ø 41 1/4"



Mondrian
Design Jean-Marie Massaud, 2019

Struttura in fusione di alluminio, finitura brown nickel opaco o champagne opaco.

Piano in olmo nero, noce gold, vetro fumé, cinque marmi levigati e sei lucidi.

Structure in aluminium casting, finish mat brown nickel or mat champagne.

Top in black elm, walnut gold, fumé glass, five mat marbles and six glossy marbles.



Dimensioni mm: ellittico 2400 × 1220 - 2800 × 1300 h 740

rotondo Ø 1400 - Ø 1600 h 740

Dimensions in: ellittico 94 1/2" x 48" -

110 1/4" x 51 1/4" h 29 1/4"

round Ø 55" - Ø 63" h 29 1/4"



Blade
Design R&D Poliform, 2014

Struttura e piano in massello di noce canaletto, massello black ash o massello tinto olmo nero. Nella versione rettangolare la lunghezza del tavolo si può personalizzare al centimetro.

Structure and top in solid canaletto walnut, solid black ash or solid wood stained black elm. The length of the rectangular table can be customized. Dimensioni mm: quadrato 1100 × 1100 - 1400 × 1400 rettangolare da 1400 a 3000 × 1100 h 740

Dimensions in: square 43 1/4" x 43 1/4" - 55" x 55" rectangular from 55" to 118" x 43 1/4" h 29 1/4"



Home Hotel
Design Jean-Marie Massaud, 2016

Struttura in massello finitura olmo nero o massello noce gold. Piano in olmo nero, cinque marmi levigati e sei lucidi. Versione in noce gold disponibile solo con piano in marmo.

I tavoli Ø 1800 e 2000 mm hanno un piano girevole integrato in olmo nero, noce gold, cinque marmi levigati e sei lucidi. Per i tavoli Ø 1800 e 2000 con piani in marmo, il piano girevole è disponibile solo in olmo nero o noce gold.

Structure in solid wood finish black elm or solid walnut gold. Top in black elm, five mat marbles and six glossy



marbles. Version in walnut gold available only with top in marble. The tables Ø 70 3/4" and 78 3/4" have an integrated swivel top in black elm, walnut gold, five mat and six glossy marble finishes. For tables Ø 70 3/4" and 78 3/4" with marble top the swivel top is available only in black elm or walnut gold.

Dimensioni mm: rettangolare 2400 × 1100 3000 × 1100 h 740

rotondo Ø 1600 - Ø 1800 - Ø 2000 h 740

Ø 1800 piano girevole integrato Ø 900

Ø 2000 piano girevole integrato Ø 1100



Dimensioni in: rettangolare 94 1/2" x 43 1/4" - 118" x 43 1/4" h 29 1/4" round Ø 63" - Ø 70 3/4" - Ø 78 3/4" h 29 1/4" Ø 70 3/4" integrated spinning tray Ø 35 1/2" Ø 78 3/4" integrated spinning tray Ø 43 1/4"



Opéra
Design Emmanuel Gallina, 2014

Tavolo fisso o allungabile. Struttura in noce c. o rovere spessart. Piano in noce c., rovere spessart, cinque marmi levigati e sei lucidi. Nel tavolo allungabile con piano in marmo finitura prolunghe come la struttura. Fixed or extendable table. Structure in walnut c. or spessart oak. Top in walnut c., spessart oak, five mat and six glossy marble finishes. The extensions of the extendable table with marble top are in the same finish of the structure.

Dimensioni mm: fisso 2880 × 1100 h 740 allungabile 2080/2980 × 969 h 740

Dimensions in: fixed 113 1/2" x 43 1/4" h 29 1/4" extensible 82"/117 1/4" x 38 1/4" h 29 1/4"



Flute
Design Roberto Barbieri, 2008

Struttura laccato opaco colori, laccato lucido colori, laccato antigraffio o verniciato brown nickel opaco e lucido. Piano laccato opaco colori, laccato lucido colori, laccato antigraffio nei colori bianco 01, carbone 91, grafite 04, canapa 35, cinque marmi levigati e sei lucidi. Structure in mat lacquered colours, glossy lacquered colours, anti-scratch lacquered colours or brown nickel mat and glossy finishes. Top in mat lacquered colours, glossy lacquered colours, anti-scratch lacquer in the colours bianco 01, carbone 91, grafite 04, canapa 35, five mat and six glossy marble finishes.

Dimensioni mm: piano laccato Ø 900 - Ø 1250 - Ø 1400 - piano marmo Ø 900 - Ø 1230 - Ø 1370 h 740

Dimensions in: lacquered top Ø 35 1/2" - Ø 49 1/4" - Ø 55" - marble top Ø 35 1/2" - Ø 48 1/2" - Ø 54" h 29 1/4"



Howard
Design Jean-Marie Massaud, 2011

Struttura in massello, finitura in rovere spessart o olmo nero. Telaio in metallo tagliato a laser e piegato, verniciato brown nickel opaco. Piano in rovere spessart, cinque marmi levigati e sei lucidi.

Structure in solid wood, finishes spessart oak or black elm. Frame in laser cut and folded metal painted mat brown nickel. Top in spessart oak, five mat and six glossy marble finishes.

Dimensioni mm: 2200 × 1000 - 2800 × 1100 h 740

Dimensions in: 86 1/2" x 39 1/4" - 110 1/4" x 43 1/4" h 29 1/4"



Mad Dining Table
Design Marcel Wanders, 2015

Struttura in massello, finitura in rovere spessart o olmo nero. Piano in rovere spessart, olmo nero, cinque marmi levigati e sei lucidi.

Structure in solid wood, spessart oak or black elm finish. Top in spessart oak, black elm, five mat and six glossy marble finishes.

Dimensioni mm: 2200 × 1100 - 2790 × 1100 h 740

Dimensions in: 86 1/2" x 43 1/4" - 109 3/4" x 43 1/4" h 29 1/4"



Gill
Design Roberto Barbieri, 2010

Tavolo allungabile. Struttura in massello, finitura in rovere spessart. Piano in rovere spessart. Extendable table. Structure in solid wood spessart oak finish. Top in spessart oak.

Dimensioni mm: 1550/2100 × 900 h 740

1800/2350 × 900 h 740

2000/2620 × 1000 h 740

Dimensions in: 61"/82 3/4" x 35 1/2" h 29 1/4"

70 3/4"/92 1/2" x 35 1/2" h 29 1/4"

78 3/4"/103 1/4" x 39 1/4" h 29 1/4"



Trevi
Design Roberto Barbieri, 2005

Struttura in trafilato alluminio laccato opaco colori, laccato antigraffio o verniciato brown nickel opaco e lucido. Piano laccato opaco colori o laccato antigraffio nei colori bianco 01, carbone 91, grafite 04 e canapa 35. Structure in extruded aluminium in the finishes mat lacquered colours, anti-scratch lacquer or brown nickel mat and glossy. Top in mat lacquered colours, or anti-scratch lacquer in the colours bianco 01, carbone 91, grafite 04, canapa 35.

Dimensioni mm: quadrato 900 × 900 - 1250 × 1250 rettangolare 1400 × 800 - 1800 × 900 h 740

Dimensions in: square 35 1/2" x 35 1/2" - 49 1/4" x 49 1/4" rectangular 55" x 31 1/2" - 70 3/4" x 35 1/2" h 29 1/4"

SEDIE CHAIRS



Stanford Bridge
Design Jean-Marie Massaud, 2018

Scocca imbottita e rivestimento non sfoderabile in tessuto o pelle. Basamento girevole con ritorno, in brown nickel opaco e lucido o champagne opaco. Body upholstered and covered in non-removable fabric or leather. Base with automatic returning mechanism, in mat and glossy brown nickel or mat champagne. Dimensioni mm: sedia | 570 p 560 h 800 sedia con braccioli | 620 p 560 h 800 Dimensions in: chair w 22 1/2" d 22" h 31 1/2" chair with arms w 24 1/2" d 22" h 31 1/2"



Sophie
Design Emmanuel Gallina, 2017

Seduta imbottita e rivestimento non sfoderabile in tessuto o pelle. Struttura in noce gold, rovere spessart o olmo nero. Seat upholstered and covered in non-removable fabric or leather. Structure in walnut gold, spessart oak or black elm. Dimensioni mm: sedia | 570 p 600 h 780 sedia con braccioli | 630 p 600 h 780 dimensions in: chair w 22 1/2" d 23 1/2" h 30 3/4" chair with arms w 24 3/4" d 23 1/2" h 30 3/4"



Grace
Design Emmanuel Gallina, 2009

Seduta imbottita e rivestimento non sfoderabile in tessuto, pelle o pelle Nabuk intrecciata (solo per retro schienale). Struttura in noce gold, noce c., rovere cenere, rovere spessart o olmo nero. Seat upholstered and covered in non-removable fabric, leather or woven leather Nabuk (available only for the rear of the backrest). Structure in walnut gold, walnut c., cenere oak, spessart oak or black elm. Dimensioni mm: con/senza braccioli | 535 p 540 h 815 Dimensions in: with/without arms w 21" d 21 1/4" h 32"



Seattle
Design Jean-Marie Massaud, 2015

Seduta e schienale completamente rivestiti in cuoio non sfoderabile nei colori 19 caffè, 02 nero, 26 invecchiato o 29 tortora con punzonatura estetica (brogueing) perimetrale. Gambe in rovere spessart, rovere naturale e olmo nero o completamente rivestite in cuoio nei colori 19 caffè, 02 nero, 26 invecchiato o 29 tortora. Seat and backrest fully covered in non-removable hide in the colours 19 caffè, 02 nero, 26 invecchiato or 29 tortora with perimeter decorative punching

(brogueing). Legs in spessart oak, natural oak and black elm or fully covered in hide in the colours 19 caffè, 02 nero, 26 invecchiato or 29 tortora. Dimensioni mm: sedia | 530 p 550 h 790 sedia con braccioli | 560 p 550 h 790 Dimensions in: chair w 20 3/4" d 21 3/4" h 31" chair with arms w 22" d 21 3/4" h 31"



Ipanema
Design Jean-Marie Massaud, 2015

Seduta imbottita e rivestimento non sfoderabile in tessuto o pelle. Struttura in rovere spessart o olmo nero. Seat upholstered and covered in non-removable fabric or leather. Structure in spessart oak or black elm. Dimensioni mm: sedia | 540 p 545 h 815 sedia con braccioli | 575 p 545 h 815 Dimensions in: chair w 21 1/4" d 21 1/2" h 32" chair with arms w 22 3/4" d 21 1/2" h 32"



Ventura
Design Jean-Marie Massaud, 2011

Scocca imbottita e rivestimento non sfoderabile in tessuto o pelle. Cucitura normale doppia o solo per la versione in tessuto (escluso velluto) cucitura a cordoncino in tinta. Struttura in rovere cenere, rovere spessart o olmo nero. Body upholstered and covered in non-removable fabric or leather. Double normal stitching or drawstring stitching in matching colour, only for the version in fabric (except velvet). Structure in cenere oak, spessart oak or black elm.



Dimensioni mm: sedia | 505 p 540 h 815 sedia con braccioli | 555 p 540 h 815 Dimensions in: chair w 20" d 21 1/4" h 32" chair with arms w 21 3/4" d 21 1/4" h 32"



Ventura
Design Jean-Marie Massaud, 2011

Scocca imbottita e rivestimento non sfoderabile in tessuto o pelle. Struttura in metallo verniciato brown nickel opaco o laccato opaco colori. Body upholstered and covered in non-removable fabric or leather. Structure in mat or glossy brown nickel painted metal. Dimensioni mm: sedia | 505 p 540 h 815 sedia con braccioli | 555 p 540 h 815 Dimensions in: chair w 20" d 21 1/4" h 32" chair with arms w 21 3/4" d 21 1/4" h 32"



Mad Dining Chair
Design Marcel Wanders, 2015

Scocca imbottita e rivestimento non sfoderabile in tessuto o pelle. Possibilità di rivestimento diverso tra interno ed esterno della scocca. Il rivestimento Gibson matelassé è disponibile solo per la scocca interna. Gambe in rovere spessart o olmo nero. Body upholstered and covered in non-removable fabric or leather. The inner and outer cover can be in two different materials. Fabric Gibson matelassé is available only for the inner cover. Legs in solid wood in the finishes spessart oak or black elm.

Dimensioni mm: sedia | 480 p 575 h 790 sedia con braccioli | 630 p 575 h 790 dimensions in: chair w 19" d 22 3/4" h 31" chair with arms w 24 3/4" d 22 3/4" h 31"



Harmony
Design Rodrigo Torres, 2012

Scocca in legno curvato con tecnica 3d finitura rovere spessart. Struttura in massello, finitura rovere spessart o in tondino di metallo finitura in cromo nero. Body in curved wood with 3D technology, finish spessart oak. Structure in solid wood spessart oak finish or in metal rod in black chrome finish. Dimensioni mm: | 460 p 480 h 795 Dimensions in: w 18" d 19" h 31 1/4"



Guest
Design Rodolfo Dordoni, 2014

Scocca imbottita e rivestimento non sfoderabile in tessuto o pelle. Cuscino seduta con rivestimento sfoderabile in tessuto o pelle. Ruote a scomparsa. Body upholstered and covered in non-removable fabric or leather. Seat cushion with removable cover in fabric or leather. Invisible wheels. Dimensioni mm: | 575 p 610 h 835 Dimensions in: w 22 3/4" d 24" h 32 3/4"



Velvet
Design R&D Poliform, 2007

Seduta imbottita e rivestimento sfoderabile in tessuto o pelle. Gambe in laccato opaco colori, noce c. o rovere spessart. Seat upholstered and covered in removable fabric or leather. Legs in mat lacquered colour, walnut c. or spessart oak. Dimensioni mm: sedia | 525 p 560 h 770 sedia con braccioli | 580 p 590 h 770 Dimensions in: chair w 20 3/4" d 22" h 30 1/4" chair with arms w 22 3/4" d 23 1/4" h 30 1/4"



Velvet Due
Design R&D Poliform, 2007

Seduta imbottita e rivestimento sfoderabile in tessuto. Gambe in laccato opaco colori, noce c. o rovere spessart. Seat upholstered and covered in removable fabric. Legs in mat lacquered colour, walnut c. or spessart oak. Dimensioni mm: sedia | 575 p 590 h 770 sedia con braccioli | 580 p 590 h 770 Dimensions in: chair w 22 3/4" d 23 1/4" h 30 1/4" chair with arms w 22 3/4" d 23 1/4" h 30 1/4"



Manta
Design Rodrigo Torres, 2007

Seduta e gambe completamente rivestite in pelle non sfoderabile. Seat and legs fully covered in non-removable leather. Dimensioni mm: sedia | 520 p 530 h 770 sedia con braccioli | 570 p 550 h 770 Dimensions in: chair w 20 1/2" d 20 3/4" h 30 1/4" chair with arms w 22 1/2" d 21 3/4" h 30 1/4"



BB
Design Blumer e Borghi, 2008

Struttura completamente rivestita e non sfoderabile in cuoio co-stampato nei colori 02 nero, 03 grigio scuro, 19 caffè o 26 invecchiato. Structure fully covered in non-removable hide in the colours 02 nero, 03 grigio scuro, 19 caffè or 26 invecchiato. Dimensioni mm: | 465 p 535 h 780 Dimensions in: w 18 1/4" d 21" h 31 1/4"

SGABELLI STOOLS



Sophie
Design Emmanuel Gallina, 2018

Seduta e schienale con parti in poliuretano flessibile a quote differenziate e parti in poliuretano flessibile stampato, prerivestimento in fibra di poliestere. Rivestimento non sfoderabile in tessuto o pelle. Struttura in massello, finitura noce gold, rovere spessart o olmo nero. Poggiapiedi in metallo verniciato brown nickel opaco con inserto inox satinato. Seat and back with parts in flexible polyurethane in different densities and parts in moulded flexible

polyurethane, pre-cover in polyester fibre. Non-removable cover in fabric or leather. Structure in solid wood, finish walnut gold, spessart oak or black elm. Footrest in mat brown nickel painted metal with inlay in brushed stainless steel. Dimensioni mm: l 550 p 550 h 660/870 alto l 550 p 550 h 760/970 Dimensions in: w 21 3/4" d 21 3/4" h 26" 34 1/4" high w 21 3/4" d 21 3/4" h 30" 38 1/4"



Ventura
Design Jean-Marie Massaud, 2016

Scocca in poliuretano flessibile stampato, prerivestimento in fibra di poliestere. Rivestimento non sfoderabile in tessuto o pelle. Cucitura normale doppia o solo per la versione in tessuto (escluso velluto) cucitura a cordoncino in tinta. Struttura in massello, finitura rovere spessart o olmo nero. Poggiapiedi in acciaio inox. Body in moulded flexible polyurethane, pre-cover in polyester fibre. Non-removable cover in fabric or leather. Normal double stitching or drawstring

stitching in matching colour only for the fabric version (except velvet). Structure in solid wood, spessart oak or black elm finish. Footrest in stainless steel. Dimensioni mm: l 485 p 470 h 650/850 alto l 485 p 500 h 750/950 Dimensions in: w 19" d 18 1/2" h 25 1/2"/33 1/2" high w 19" d 19 3/4" h 29 1/2"/37 1/2"



Harmony
Design Rodrigo Torres, 2012

Scocca in legno curvato con tecnica 3D, finitura rovere spessart. Struttura in tondino di metallo finitura cromo nero. Body in curved wood with 3D technology, spessart oak finish. Structure in metal rod black chrome finish. Dimensioni mm: l 445 p 450 h 660/815 Dimensions in: w 17 1/2" d 17 3/4" h 26" 32"



Ics
Design Rodrigo Torres, 2010

Seduta in rovere spessart. Struttura in massello, finitura rovere spessart con poggiapiedi in acciaio inox. Seat in spessart oak. Structure in solid wood, spessart oak finish with footrest in stainless steel. Dimensioni mm: l 440 p 340 h 660 Dimensions in: w 17 1/2" d 13 1/2" h 26"

PANCHE BENCHES

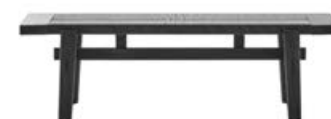

Home Hotel
Design Jean-Marie Massaud, 2016

Seduta in olmo nero rivestita in cordatura di pelle testa di moro. Struttura in massello, finitura olmo nero. Cuscino opzionale con rivestimento sfoderabile in tessuto o pelle; nella versione pelle Nabuk possibilità pelle Nabuk intrecciata nella parte superiore. Seat in black elm, covered with dark brown stringed leather. Structure in solid wood, black elm finish. Optional cushion with removable cover in fabric or leather; in the version in leather Nabuk, the upper part can be in woven leather. Dimensioni mm: l 1000 p 490 h 440 l 1440 p 490 h 440 Dimensions in: w 20" d 21 1/4" h 32" w 21 3/4" d 21 1/4" h 32"



Jane
Design Emmanuel Gallina, 2017

Seduta in poliuretano flessibile a quote differenziate, prerivestimento in fibra di poliestere. Rivestimento in tessuto sfoderabile o in pelle non sfoderabile. Struttura in massello, finitura noce gold, rovere spessart o olmo nero. Struttura in metallo verniciato brown nickel opaco o lucido. Seat in flexible polyurethane in different densities, pre-cover in polyester fibre. Cover in removable fabric or in non-removable leather. Structure in solid wood, walnut gold, spessart oak or black elm finish. Structure in mat or glossy brown nickel painted metal. Dimensioni mm: l 1300 p 500 h 480 Dimensions in: w 51 1/4" d 19 3/4" h 19"

FINITURE
FINISHINGS

Laccato goffrato e lucido
Embossed and glossy lacquered

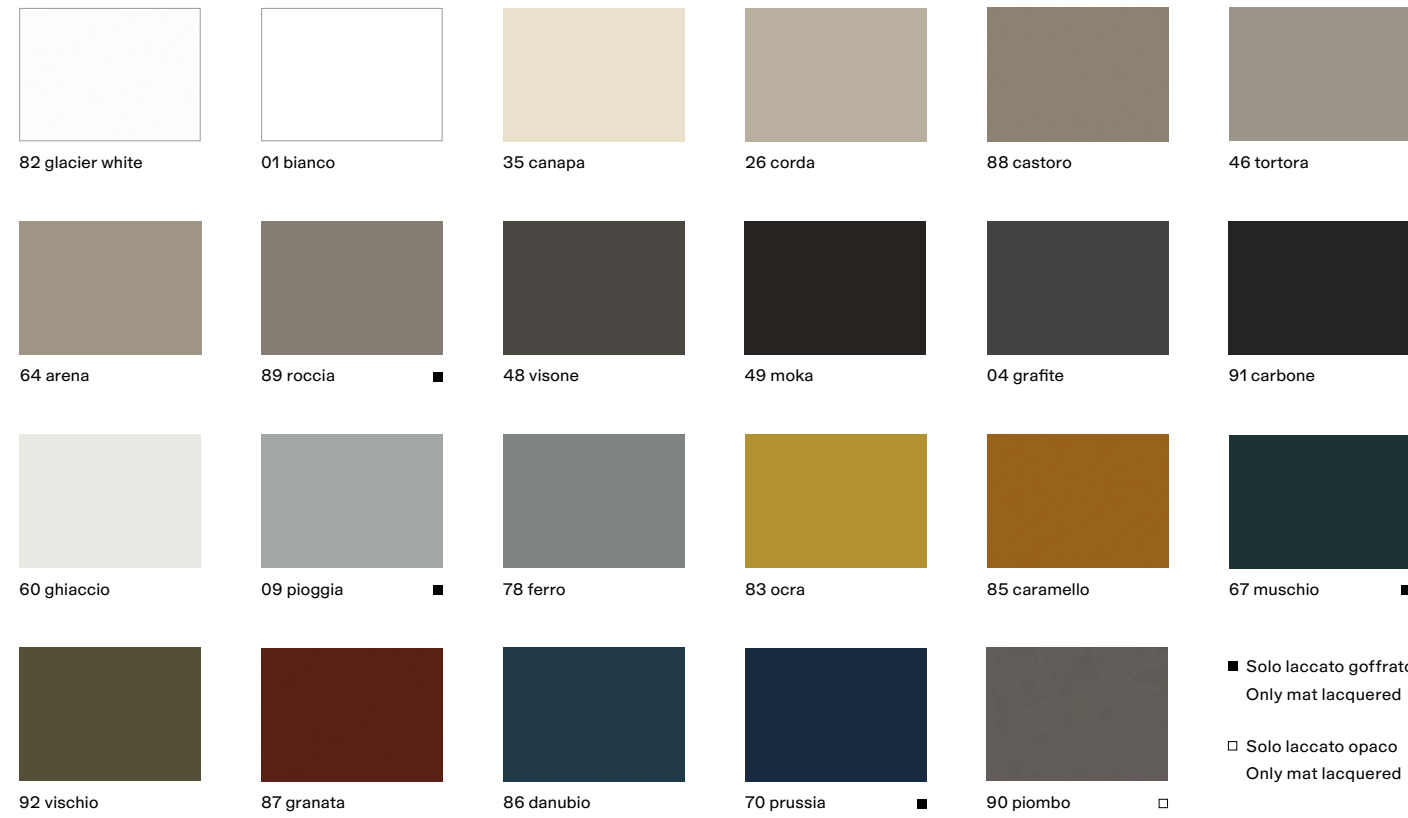

■ Solo laccato goffrato
Only mat lacquered

□ Solo laccato opaco
Only mat lacquered

Laccato metallico
Metallic lacquered



Vetro riflettente
Reflecting glass

Vetro satinato
Frosted glass

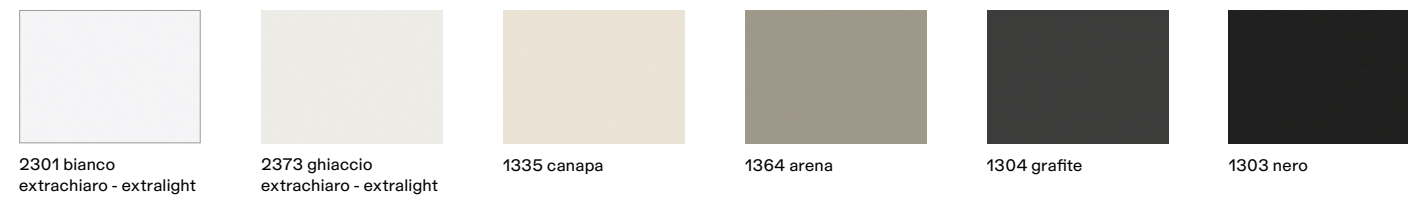

Vetro lucido
Glossy glass



Essenze
Woods

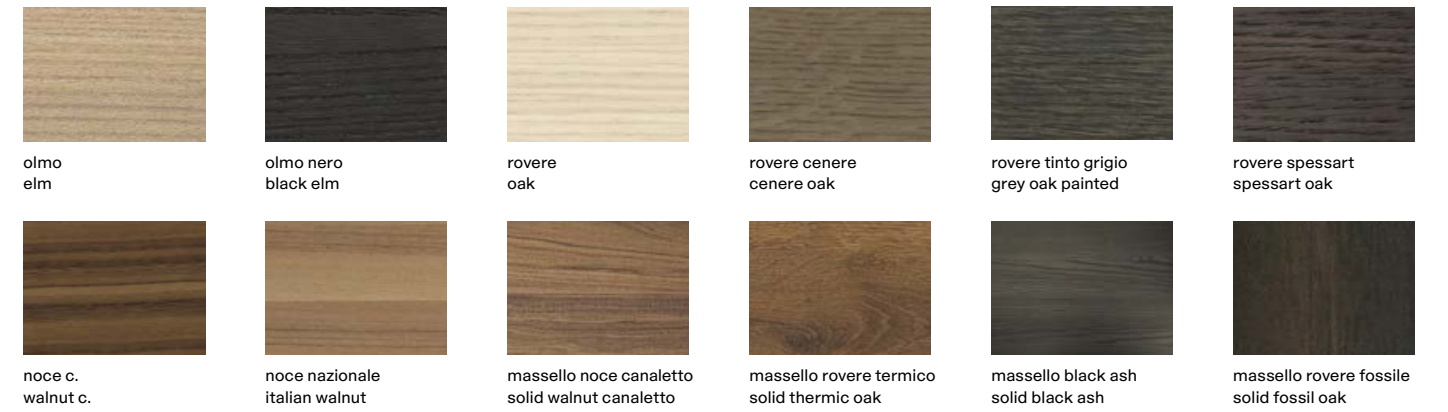

Nobilitato
Melamine



Nobilitato silk
Silk melamine



Laminato opaco
Mat laminate

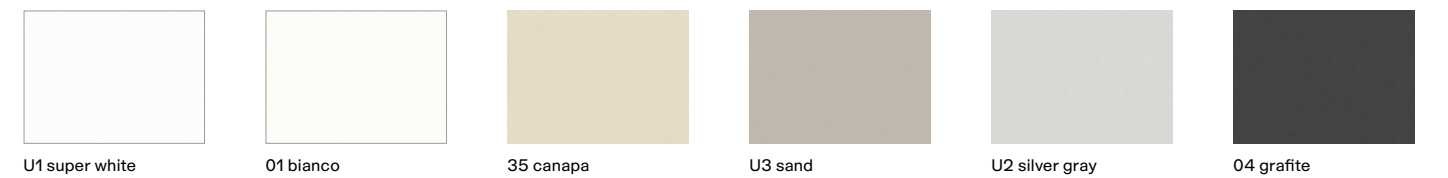

Laminato opaco touch
Mat laminate touch

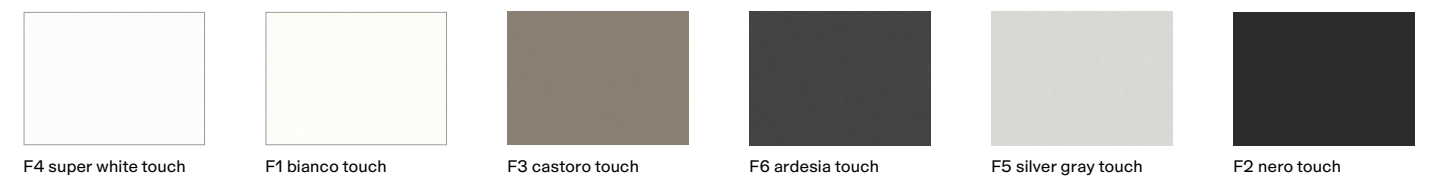

FINITURE
FINISHINGS

Quarzite lucida
Glossy composite stone

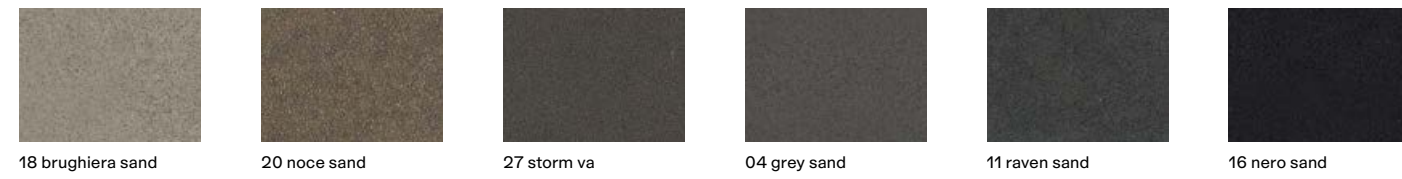

Quarzite micropallinata
Micro-blasted composite stone

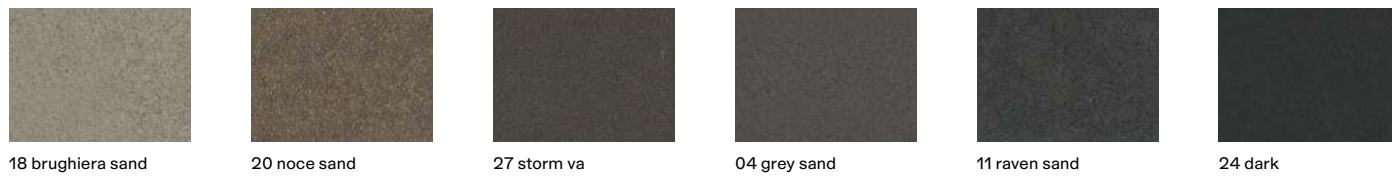

Marmo levigato
Mat marble

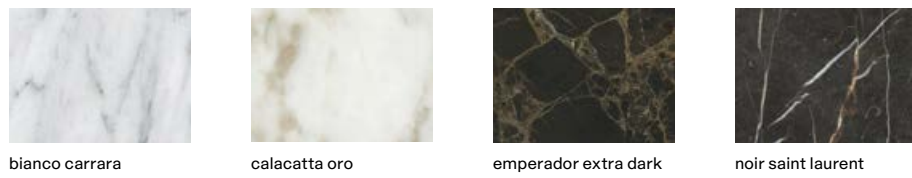

Marmo lucido
Glossy marble

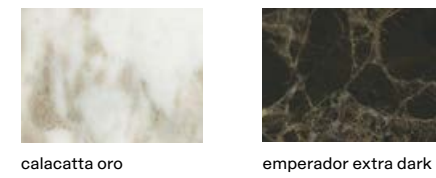

Pietra
Stone



Inalco MDi®
Inalco MDi®



Dekton
Dekton



DuPont Corian®
DuPont Corian®

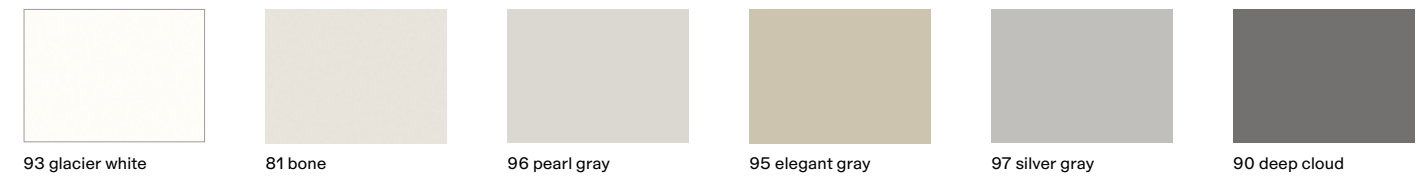

Laminato tuttocolore
Tuttocolore laminato

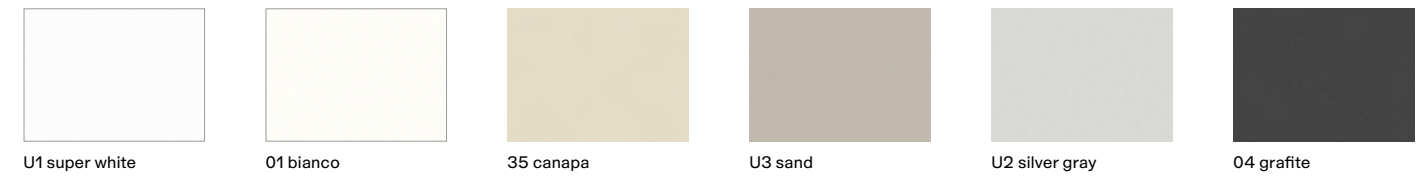

Laminato tuttocolore touch
Tuttocolore laminate touch



Acciaio
Steel

Poliform Spa

via Montesanto 28
Casella postale n. 1
22044 Inverigo (CO) Italy
t +39 031 6951
f +39 031 699444
info@poliform.it
poliform.it

Poliform realizza tutte le sue collezioni in Italia usando componenti e materie prime selezionate.

All the Poliform collections are manufactured 100% in Italy using top-class components and materials.

Poliform si riserva il diritto di apportare, senza preavviso, ogni modifica mirata al miglioramento funzionale e qualitativo dei propri prodotti. Testi e disegni presenti in questo stampato hanno scopo divulgativo; per ogni aspetto tecnico e dimensionale fare riferimento ai listini aziendali e relativi aggiornamenti. I campioni di colori e materiali hanno valore indicativo.

Poliform reserves the rights at all time to apply modifications for the functional or qualitative improvement of its products. Texts and drawings present in this brochure have a divulgative purpose; for every technical and dimensional aspect please refer to the company's price lists and their relative updatings. The colour and material samples have an indicative value.



2018 Adi Compasso D'oro
Career Award