



Tipology

Boiserie system

STRUCTURE

Components

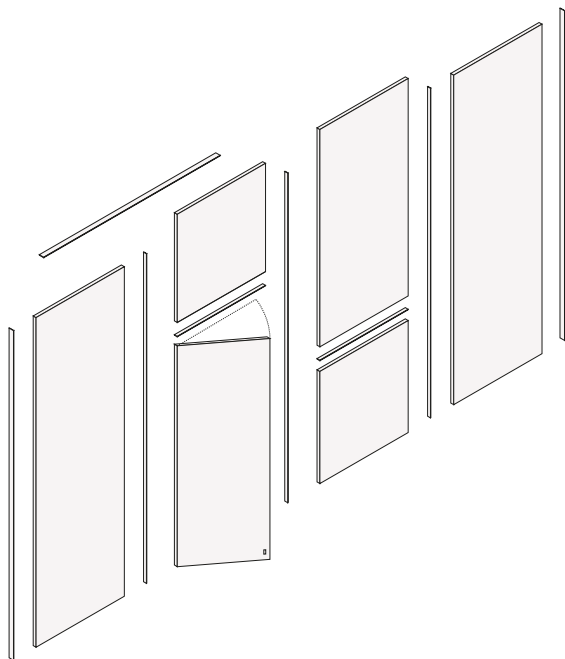

Surface is a wall panelling system to cover the walls and the backs of the wardrobes in a continuous way. The wall panelling (except mirror) can be accessorized with the components of the Code day and night system and can be integrated with the Senzafine wardrobes and the Pivot doors. The system works with wall fixing brackets (thickness 1/2") to hang the panels with painted aluminium profiles between each panel. Panels are supplied with adjustment feet to the floor and with vertical and horizontal closing profiles. It is possible to superimpose the panels, also in customized size and solutions for corners and open corners are available, too. Surface wall panelling is available in several materials and finishes, the profiles are painted in mat ardesia or champagne.

Compositional solutions

Wall panelling next to the wardrobe

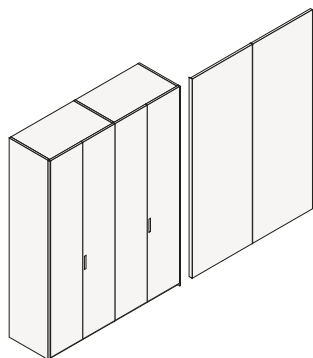

Wall panelling can be installed flush with the doors of a Senzafine wardrobe, in this case the wardrobe side must have the profile and the wall panel must have the 1/8" profile.

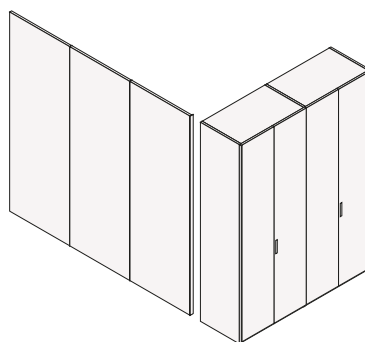

Wall panelling can be installed next to the side of a Senzafine wardrobe, in this case the wall panel must have the 1/8" profile.

Wall panelling to the back of the wardrobe

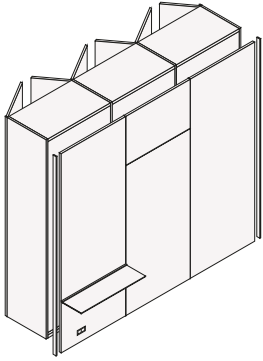

The wall panels must be closed at the sides with finishing profiles for wall panelling to the back of the wardrobe width 1/2". The wall panelling in one piece or superimposed can be accessorized (except mirror) with one Code shelf for panel, with or without led light (d 11"-11 3/4", thickness 1/4"), with the wiring module for one electric socket or for two usb sockets or with Drop, Circle and Audrey mirrors.

Wall panelling between two wardrobes

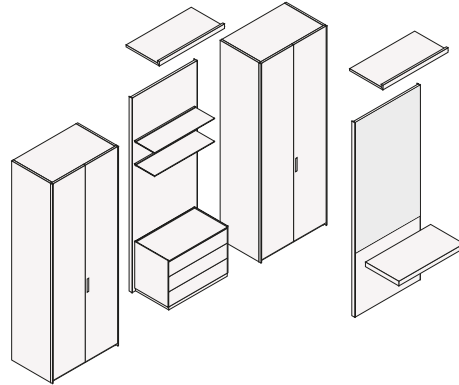

The wall panels must be closed at the sides with 1/8" profiles and on top with a shelf with and without led light. Wall panelling (except mirror) can be accessorized with shelves, storage units, wiring module for one electric socket or for two usb sockets and Code hanging thick shelves, with and without led light.

MODULARITY

Dimensions

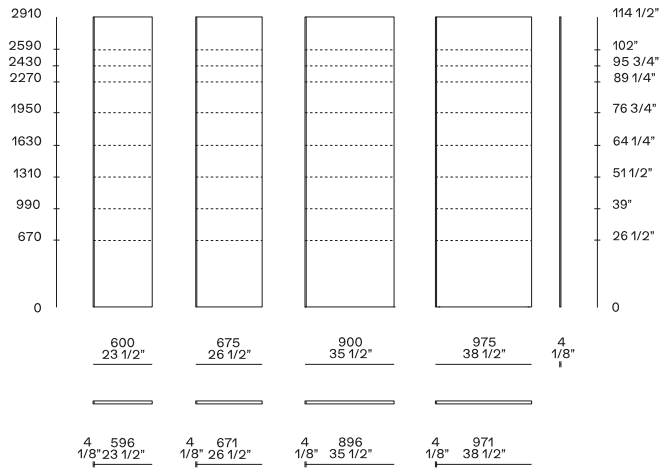

Boiserie in Inalco MDi® h max 1950
Panel width with a profile 4 mm on the left

Corner solutions

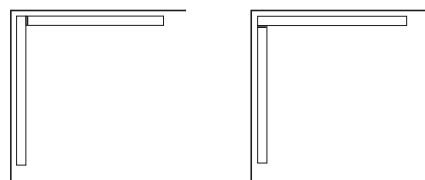

Inner corner, standard profile on the panel
with visible edge.

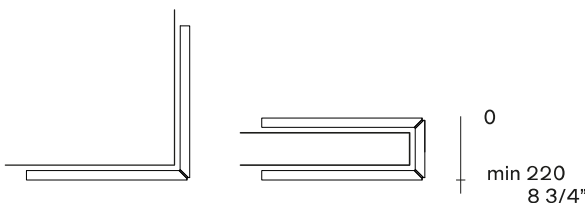

Outer corner, shaped panels with profile for corner. Shaped panels can not be accessorized.

Wall panelling in one piece

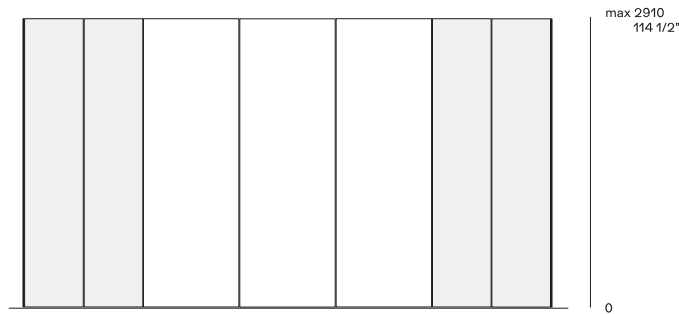

Compositions with wall panelling up to a maximum height of 114 1/2" are feasible. It is possible to combine wall panels in different finishes. The wall panelling (except mirror) can be accessorized with the components of the Code day and night system.

Superimposed wall panelling

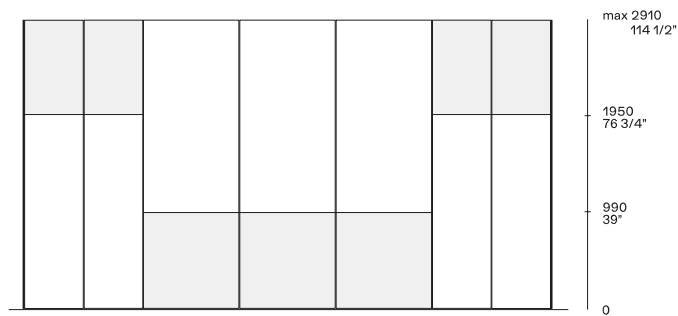

Compositions with superimposed wall panelling are feasible. Wall panels in different finishes can be put near each other and can be superimposed. The lower panel must have a standard height; the upper panel has a height by difference with the total one. Any cuts to size must be applied to the upper panel respecting the minimum height of 23 1/2\"/>