

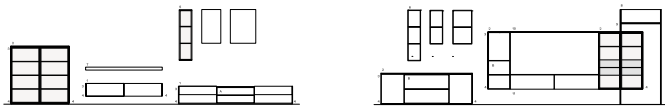

DESCRIPTION

Typology	Modular system
Structure	Panel of wooden particles melamine, veneered or lacquer
Backs	Panel of wooden particles veneered, lacquer or covered in fabric
Hanging thick shelf	Panel of wooden particles and medium density veneered - lacquer
Wall panelling	Panel of wooden particles veneered - lacquer - covered in fabric
Doors	Panel of wooden particles veneered - lacquer, aluminium painted profile and glass

COMPONENTS



- | | |
|---|--|
| 1
Storage units (recessed finishing top)
A open storage units | 2
Storage units Living (visible finishing top)
B open storage units Living |
| 2 Storage units Living (visible finishing top) | 3 Finishing top |
| B open storage units Living | 4 Lateral sides |
| 3 Finishing top | 6 Bookcases |
| 4 Lateral sides | 8 Wall panelling |
| 5 Hanging storage units | 9 Shelves |
| 7 Suspended thick shelves | 10 TV-portals |
| | 11 Storage units for TV-portal |

DIMENSIONS AND FINISHINGS

Storage units

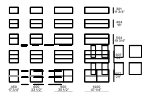

With drawers, flap door or leaf door.
With leaf door, inner movable shelf
thickness 3/4", in melamine ardesia.



With coplanar door, only suspended.
Inner
fixed shelf with two vertical sides,
thickness 1/2", in melamine ardesia.

Poliform_day_systems_CODE_COMPONENTI_01_1300px_Contenitori_con_vani_a_giorno_p_501

				301 11 3/4"
				404 16"
				504 19 3/4"
				607 24"
450 17 3/4"	600 23 1/2"	900 35 1/2"	1200 47 1/4"	
				203 8"
450 17 3/4"	600 23 1/2"	900 35 1/2"	1200 47 1/4"	

To be mounted on storage units h 11
3/4"-16" only.

Storage units Living

				607 24"
				607 24"
				607 24"
				1189 46 3/4"
				1189 46 3/4"
450 17 3/4"	600 23 1/2"	900 35 1/2"	1200 47 1/4"	

Storage units h 46 3/4" w 47 1/4" only
floorstanding.

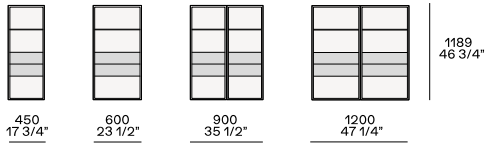

Storage units h 46 3/4" accessorized with chest of drawers.

Poliform_day_systems_CODE_03_1300px_Contentitori_Living_con_vani_a_giorno_p_501

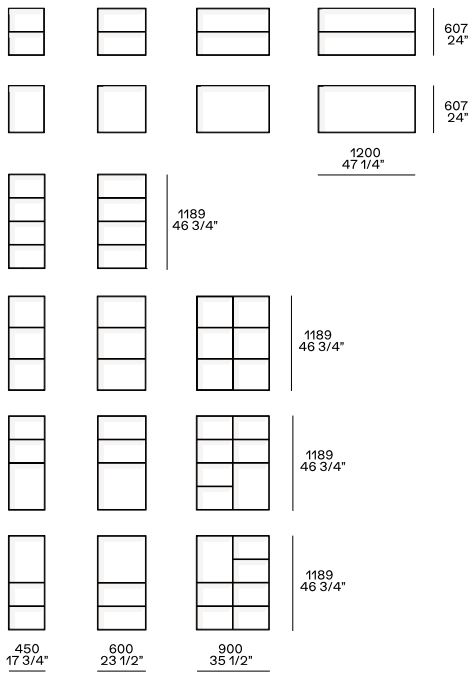

Finishing top

Thickness 1/2", in lacquer or wood.

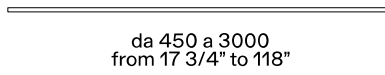

Thickness 3/4", in marble.

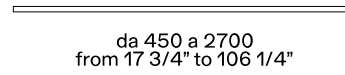

Lateral sides



Sides for storage units to add at the start and at the end of the composition.

Hanging storage units

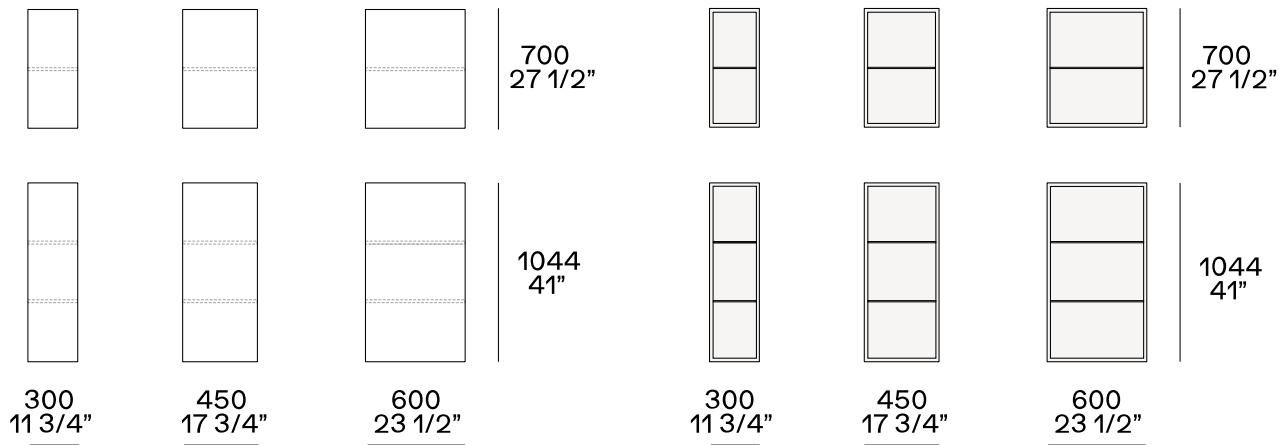

Inner movable shelves, thickness 3/4", in the same finish of the inner structure or thickness 1/4" in transparent glass.

Bookcases

Poliform_day_systems_CODE_04_635px_Libreria_sp_8_p_320

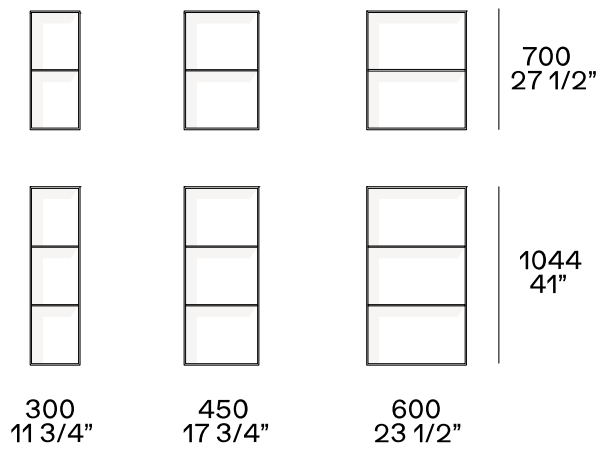

Hanging thick shelf

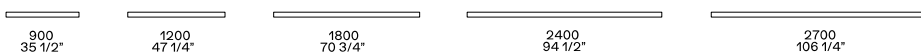

For wall fixing or for wall panelling.
Available also with accessorized channel, in the same length of the thick shelf, th 3/4" d 4 3/4" with light and dimmable led.

Wall paneling

Poliform_day_systems_CODE_boiserie_01_1300px_Boiserie

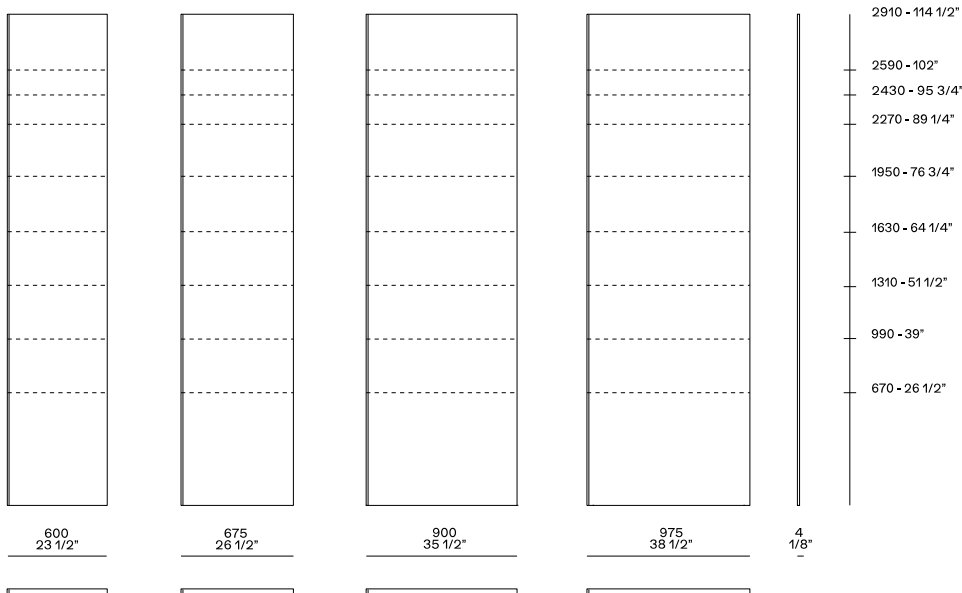
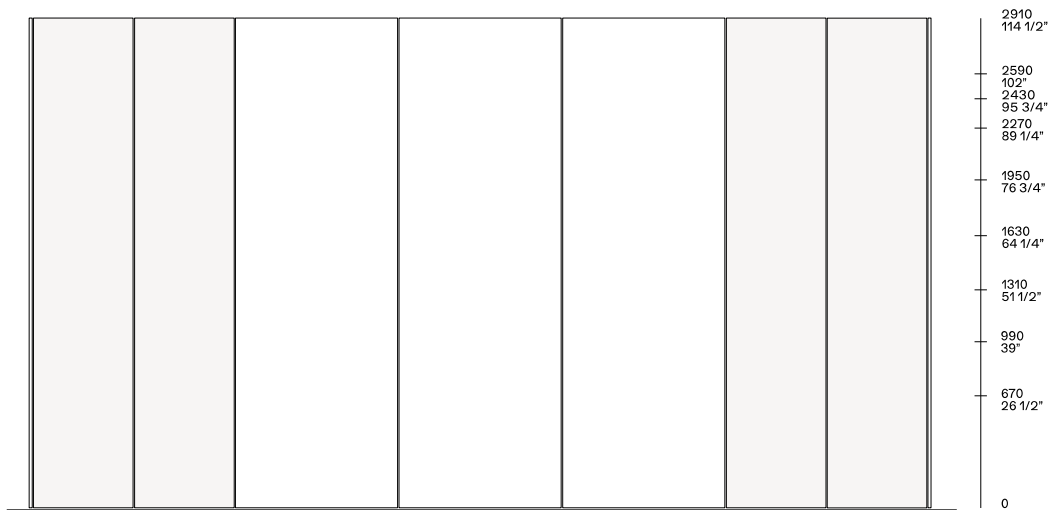

All the visible sides of the wall panelling must be provided with vertical closing profile. For wall panelling with height less than or equal to 76 3/4" the horizontal closing profile is obligatory. Storage units and shelves can be positioned both at the heights in the scheme and at requested heights.

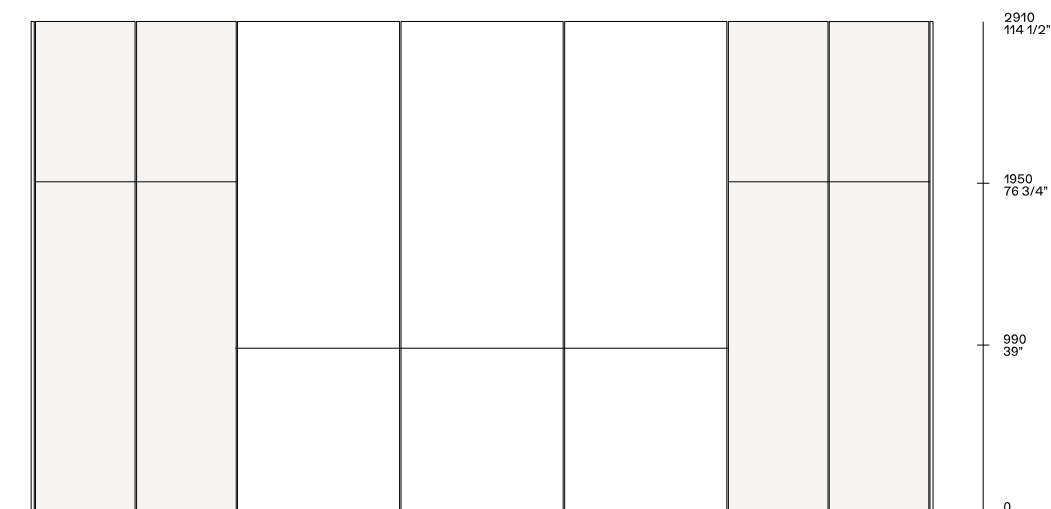

Compositions with superimposed wall panelling are feasible. Wall panels in different finishes can be put near each other but cannot be superimposed. The floorstanding panel must be in the dimension indicated in the scheme, the superimposed panel will have the dimension by the difference with the total height. Storage units and shelves cannot be positioned at the joint of two panels.

Shelfs



For wall fixing or for wall panelling (rear profile h 3 1/4"). Available also with dimmerable led light.

TV-portal

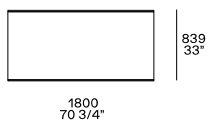

To be put next to Living storage units h 16 3/4".

Poliform_day_systems_CODE_03_1300px_Portale_TV_espempi

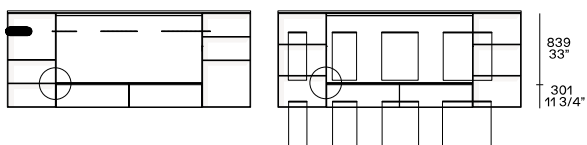

Esempi di composizioni sospese con portale TV. I ripiani dei contenitori Living con vana a giorno si allineano ai contenitori del portale TV a seconda della versione scelta.

Storage units for TV-portal

Poliform_day_systems_CODE_01_635px_Portale_TV_contenitore

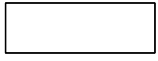

301
11 3/4"

900
35 1/2"
