

CLASS

MATTEO NUNZIATI (2009)



DESCRIPTION

Class, design by Matteo Nunziati, is a sideboard characterized by modern aesthetics interpreted with harmony and elegance. An example of perfect balance between modernity and naturalness.

Poliform

CLASS

MATTEO NUNZIATI (2009)



TECHNICAL DESCRIPTION

TPOLOGY

high or low sideboard

STRUCTURE

panel of wooden particles in veneer

BACK PANEL

panel of wooden particles lacquer matt colours

DRAWER STRUCTURE

panel of wooden particles in melamine

DRAWER FRONT

panel of wooden particles in veneer

DOOR

panel of wooden particles in veneer

EDGE

veneer for the visible sides and melamine for the other sides

OPTIONAL ELEMENTS

cutlery holder covered in hide and shelves

FEATURES

available in suspended version; with metal feet, or with baseboard for direct rest on floor

Poliform

CLASS

MATTEO NUNZIATI (2009)

MCS1

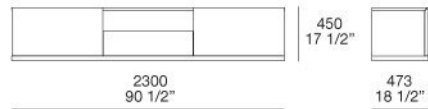

MCS2

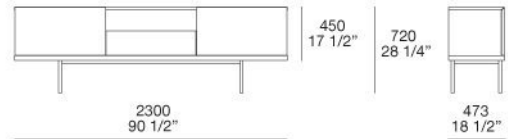

MCS3

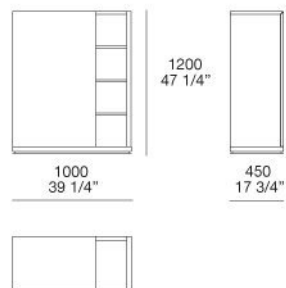

CLASS

FINISHINGS\SIDEBOARD\WOODS (1)

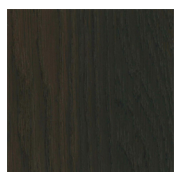

SPESSART
OAK

CLASS

FINISHINGS\SIDEBOARD\MAT LACQUERED COLOURS (26)



35 CANAPA

26 CORDA

88 CASTORO

64 ARENA

46 TORTORA

48 VISONE

49 MOKA

78 FERRO



04 GRAFITE

60 GHIACCIO

09 PIOGGIA

89 ROCCIA

90 PIOMBO

83 OCRA

85
CARMELLO

87 GRANATA



92 VISCHIO

67 MUSCHIO

86 DANUBIO

70 PRUSSIA

82 GLACIER-
WHITE

01 BIANCO

91 CARBONE

23 BRONZO



24 OTTONE

02 ARDESIA